

INSPECTION

1. INSPECT COLUMN UPPER BRACKET

Check that the steering lock mechanism operates properly.

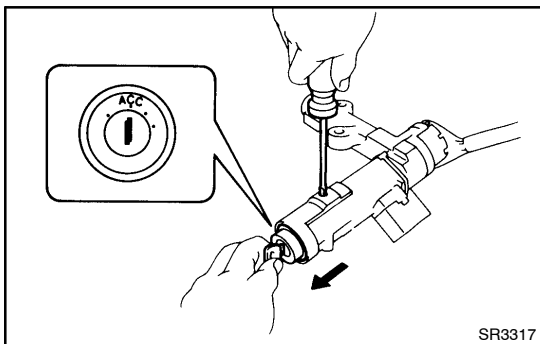

2. IF NECESSARY, REPLACE KEY CYLINDER

- (a) Place the ignition key at the ACC position.
- (b) Push down the stop pin with a screwdriver, and pull out the key cylinder.
- (c) Install a new key cylinder.

HINT:

Make sure the ignition key is at the ACC position.

3. INSPECT IGNITION SWITCH

(See page BE-22)

4. INSPECT KEY UNLOCK WARNING SWITCH

(See page BE-22)

5. A/T:

INSPECT KEY INTERLOCK SOLENOID

(See AT section)

6. M/T:

IF NECESSARY, REPLACE IGNITION SWITCH WITH
KEY UNLOCK WARNING SWITCH

- (a) Remove the 3 screws.
- (b) Install new switches with 3 screws.

7. A/T:

IF NECESSARY, REPLACE IGNITION SWITCH WITH
KEY UNLOCK WARNING SWITCH AND KEY INTER-
LOCK SOLENOID

- (a) Remove the 5 screws.
- (b) Install new switches and solenoid with 5 screws.

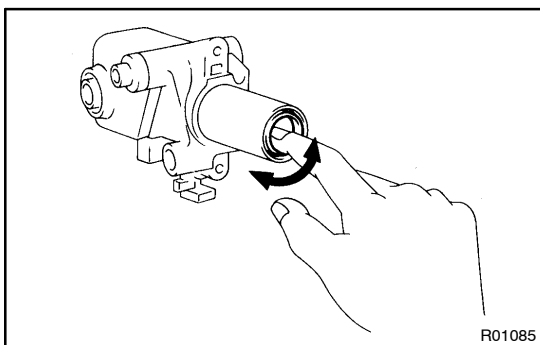

8. INSPECT BEARING

Check the bearing rotation condition and check for abnormal noise.

If the bearing is worn or damaged, replace the column upper tube.