

REMOVAL

1. REMOVE STEERING WHEEL PAD

NOTICE:

- If the airbag connector is disconnected with the ignition switch at ON or ACC, DTCs will be recorded.
- Never use airbag parts from another vehicle. When replacing parts, replace with new parts.

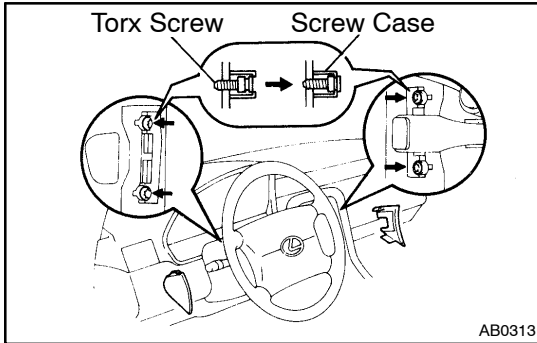

- Place the front wheels facing straight ahead.
- Remove the No.2 and No.3 covers.
- Using a torx wrench, loosen the 4 torx screws.

HINT:

Loosen the 4 screws until the groove along the screw circumference catches on the screw case.

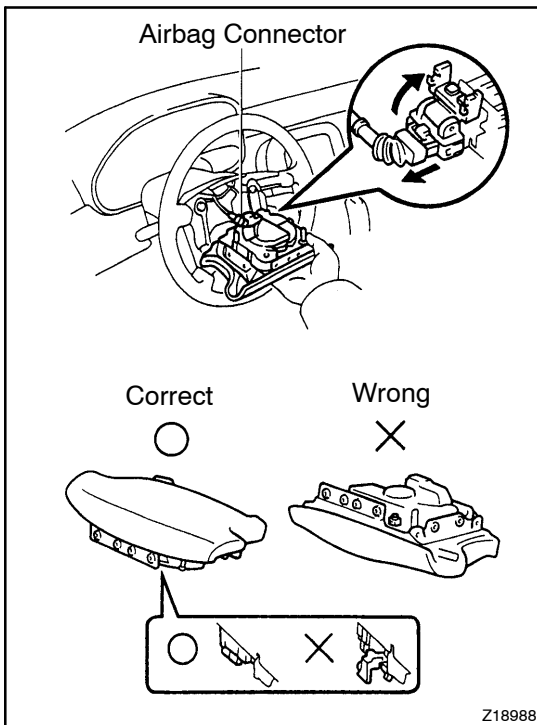

- Pull the wheel pad out from the steering wheel and disconnect the airbag connector.

CAUTION:

- When storing the wheel pad, keep the upper surface of the pad facing upward.
- Never disassemble the wheel pad.

NOTICE:

When removing the wheel pad, take care not to pull the airbag wire harness.

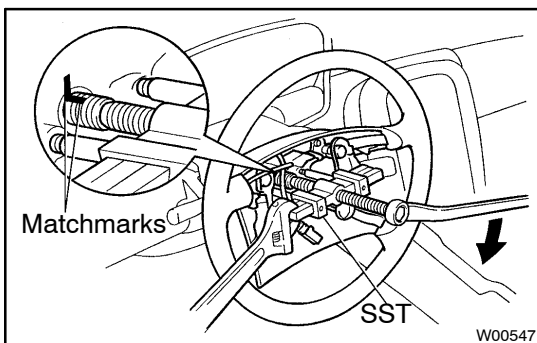

2. REMOVE STEERING WHEEL

- Disconnect the connector.
- Remove the steering wheel set nut.
- Place matchmarks on the steering wheel and main shaft.
- Using SST, remove the wheel.

SST 09950-50010 (09951-05010, 09952-05010, 09953-05020, 09954-05020)

3. REMOVE UPPER AND LOWER COLUMN COVERS

Remove the 3 screws.

4. REMOVE THESE PARTS:(See page [BO-92](#))

- End pad
- No.1 Lower finish panel
- Lower finish panel LH
- No.1 under cover
- No.2 heater to register duct

5. REMOVE COMBINATION SWITCH

- (a) Disconnect the connectors.
- (b) Disconnect the airbag connector.
- (c) Remove the 4 screws.

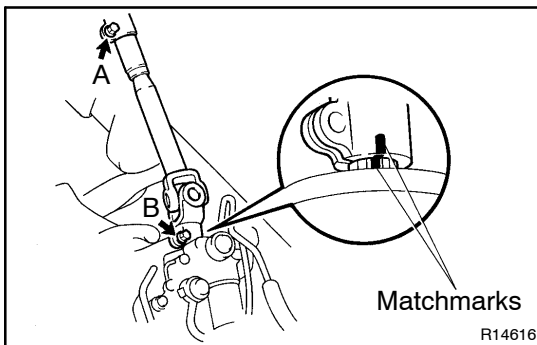
6. REMOVE SPIRAL CABLE(See page [BE-26](#))**NOTICE:****Do not disassemble the cable or apply oil to it.****7. DISCONNECT INTERMEDIATE SHAFT**

- (a) Place matchmarks on the intermediate shaft and control value shaft.
- (b) Loosen bolt A and remove bolt B.

8. REMOVE INTERMEDIATE SHAFT

Remove the bolt A.

9. REMOVE STEERING COLUMN ASSEMBLY

- (a) Disconnect the connectors.
- (b) Remove the 4 column assembly set nuts.