

Last Modified: 7-13-2007		1.6 K
Service Category: Engine/Hybrid System	Section: Engine Mechanical	
Model Year: 2008	Model: ES350	Doc ID: RM000000T4V01CX
Title: 2GR-FE ENGINE MECHANICAL: ENGINE UNIT: COMPONENTS (2008 ES350)		

[COMPONENTS](#)

[ILLUSTRATION](#)

RH SIDE:

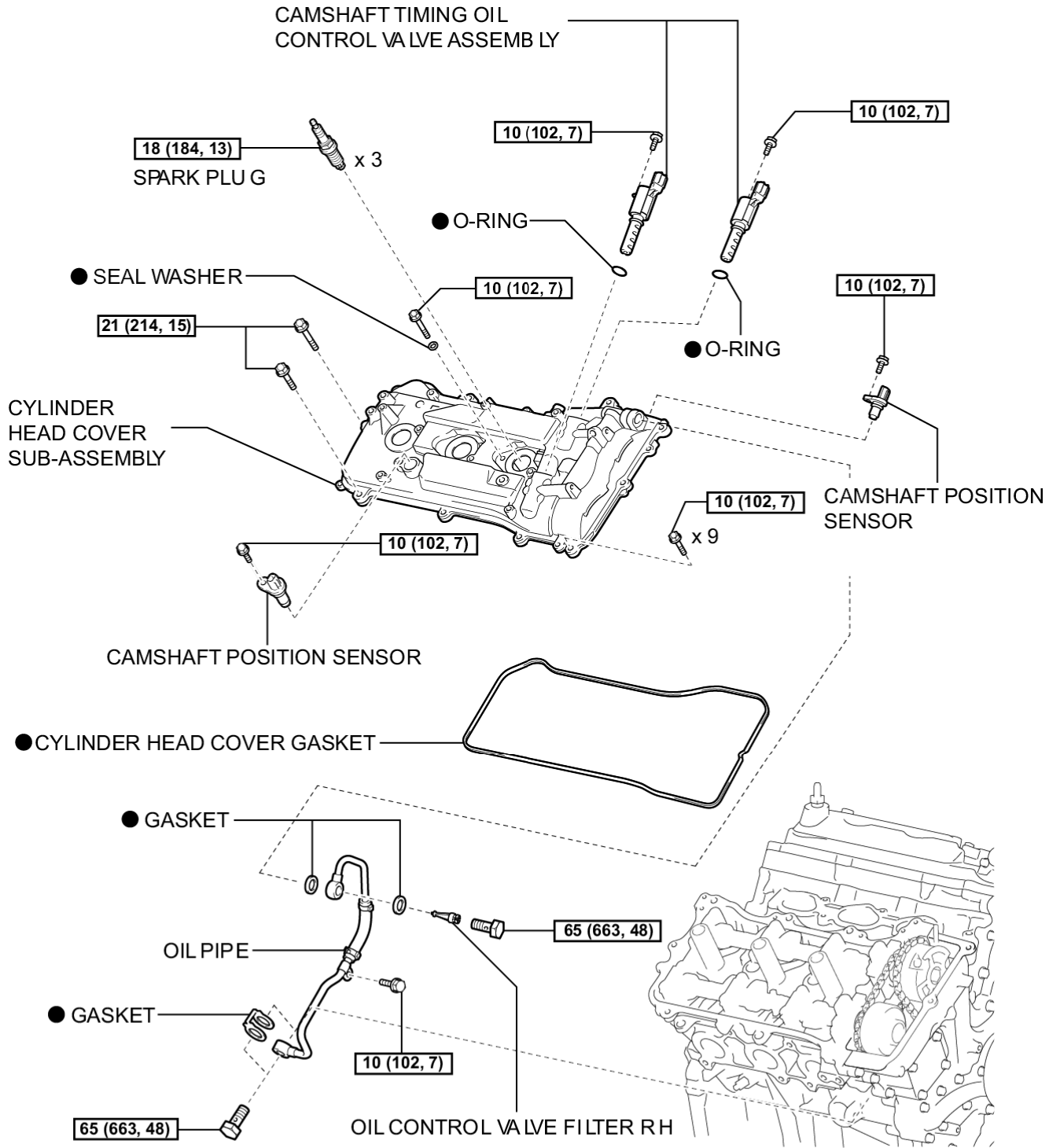

N*m (kgf*cm, ft.*lbf) : Specified torque ● Non-reusable part

P

ILLUSTRATION

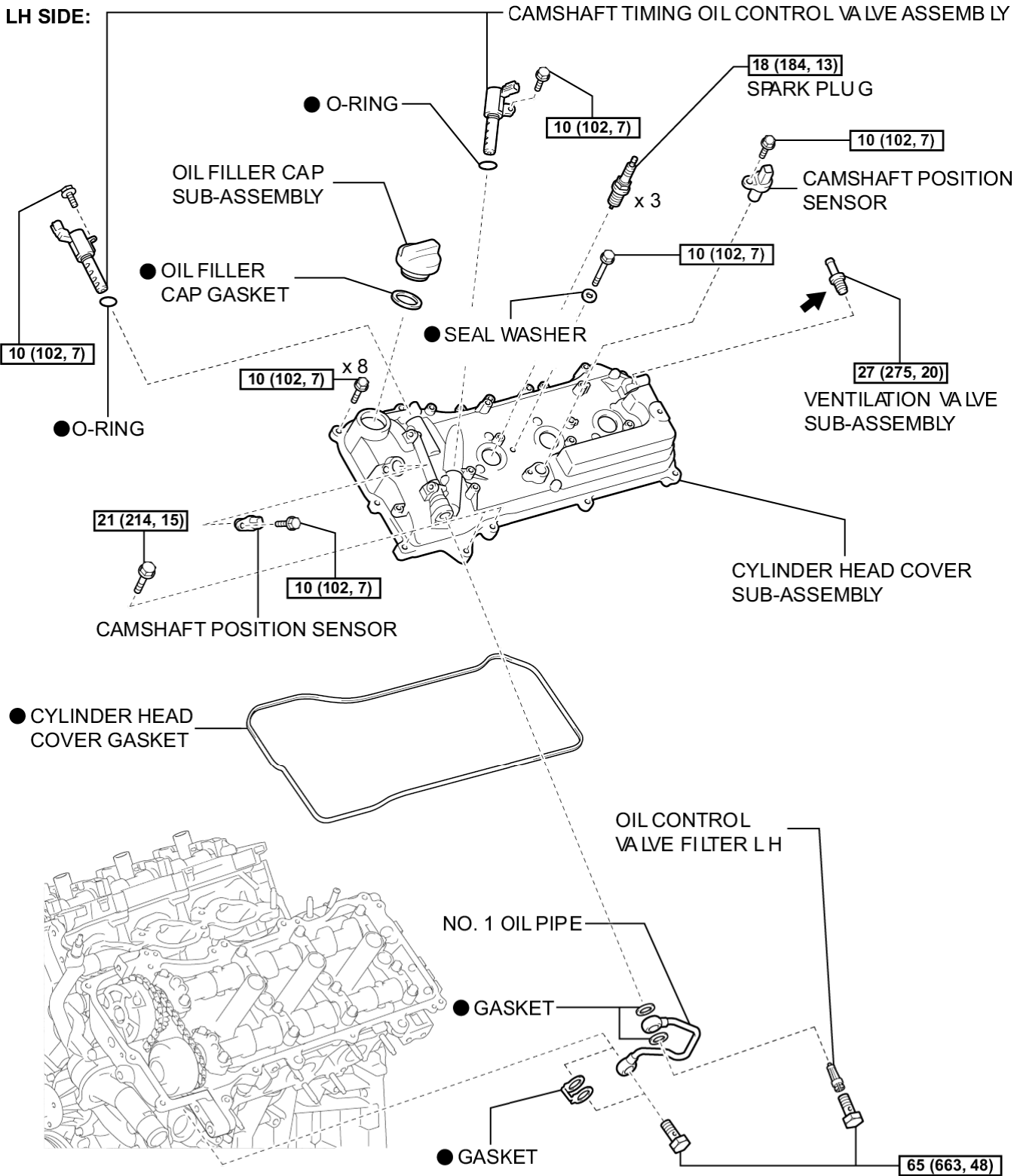

[N*m (kgf*cm, ft.*lbf)]: Specified torque

● Non-reusable part

← Precoated part

P

ILLUSTRATION

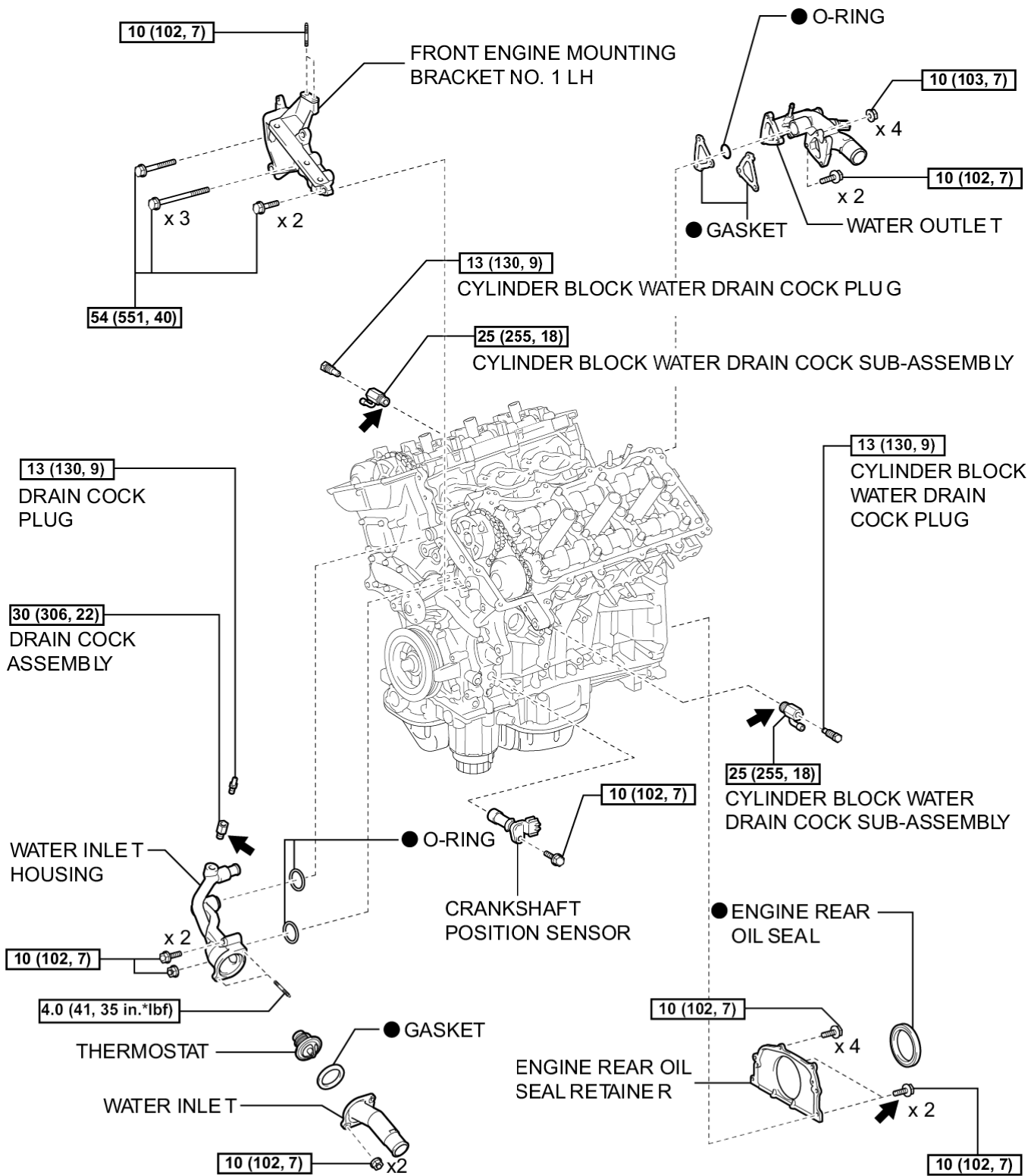

N*m (kgf*cm, ft.*lbf) : Specified torque ● Non-reusable part ← Precoated part

P

ILLUSTRATION

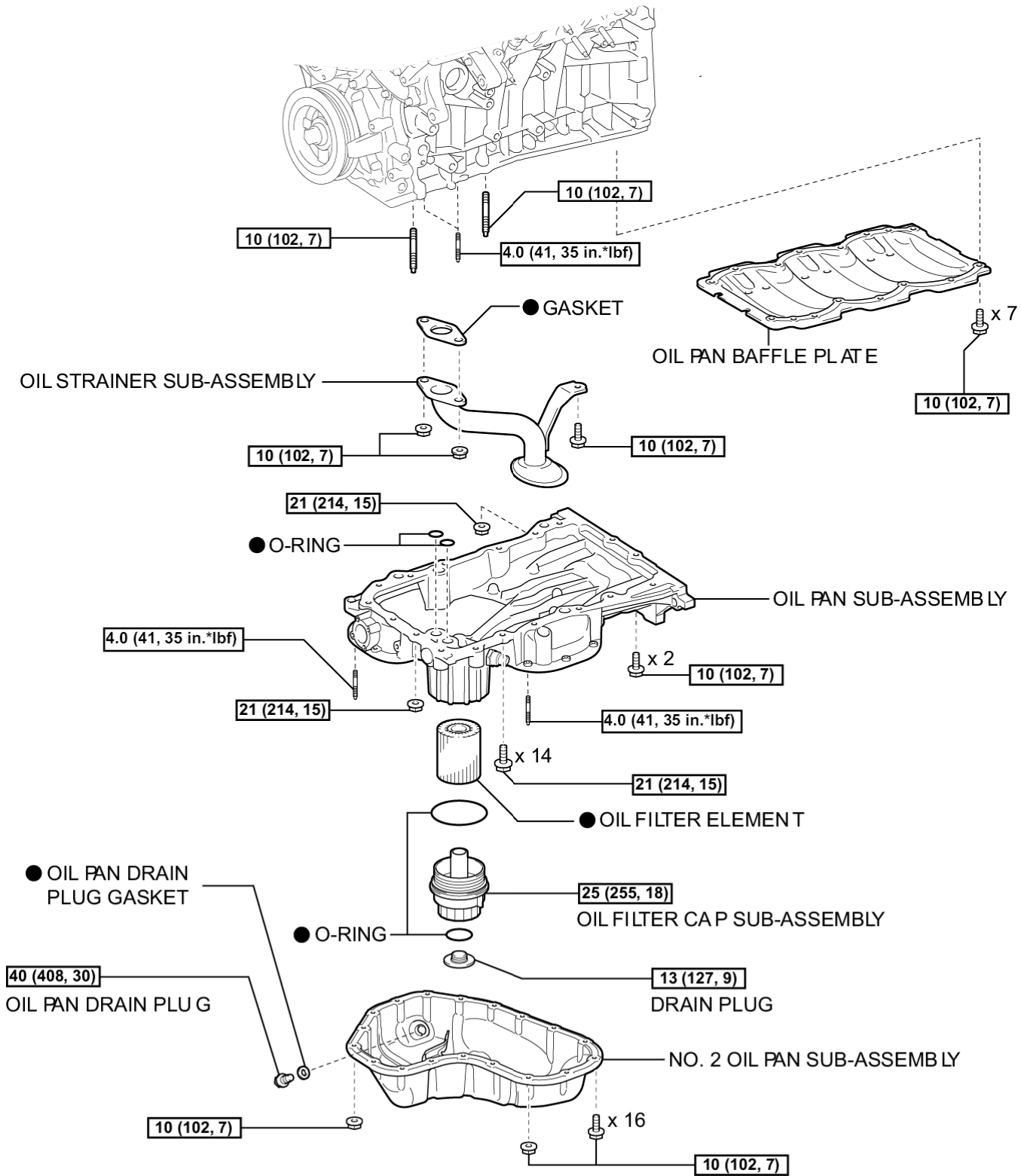

[N*m (kgf*cm, ft.*lbf)]: Specified torque ● Non-reusable part

P

ILLUSTRATION

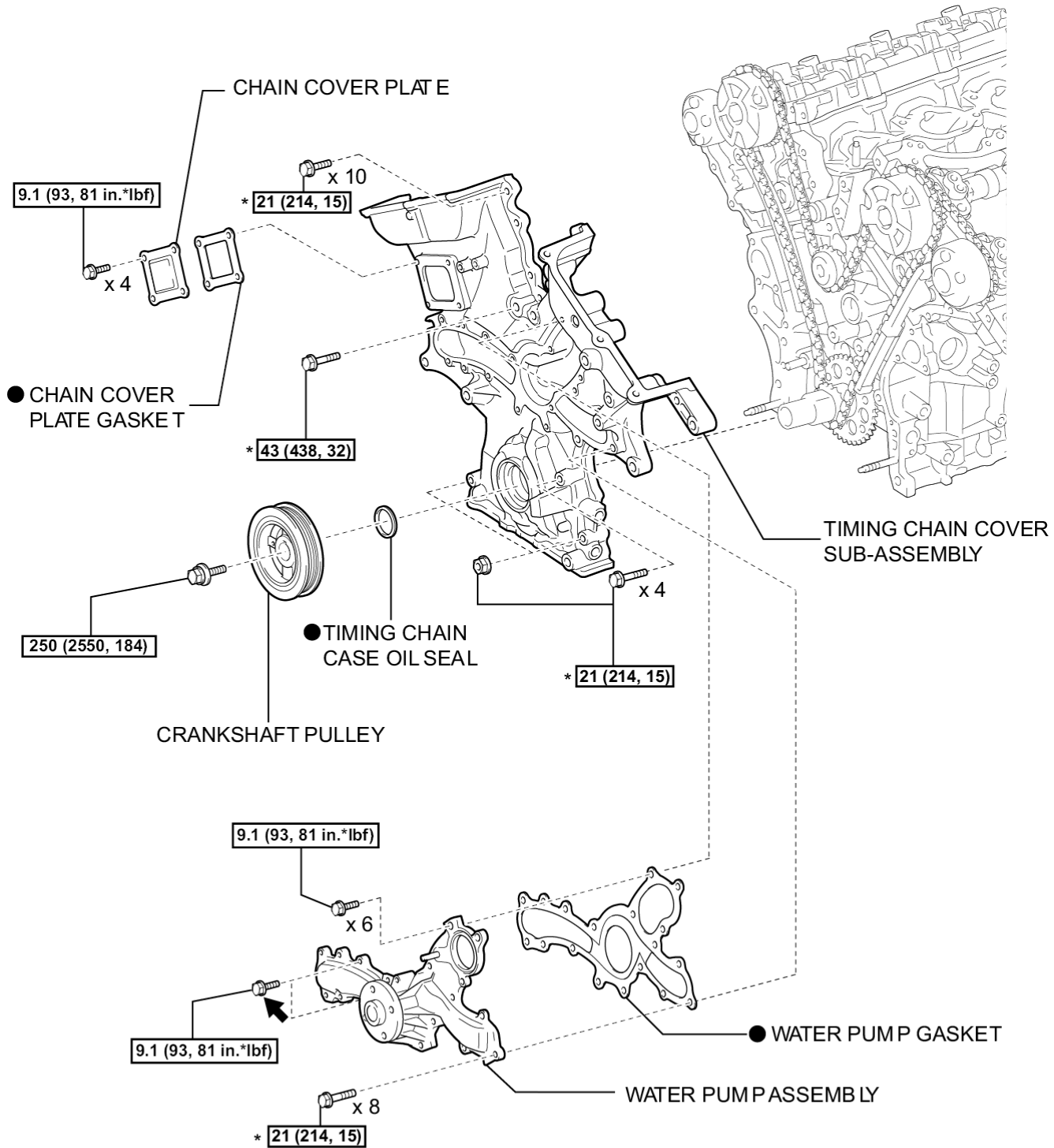

N*m (kgf*cm, ft.*lbf): Specified torque ● Non-reusable part

← Precoated part *DO NOT apply oil

P

ILLUSTRATION

NO. 1 CHAIN TENSIONER ASSEMBLY

10 (102, 7)

CHAIN TENSIONER SLIPPER

NO. 2 CHAIN VIBRATION DAMPER

60 (612, 44)

NO. 2 IDLE GEAR SHAFT

NO. 1 IDLE GEAR SHAFT

IDLE SPROCKET ASSEMBLY

● GASKET

CRANKSHAFT TIMING SPROCKET

KEY

CHAIN SUB-ASSEMBLY

NO. 1 CHAIN VIBRATION DAMPER

23 (230, 17)

N*m (kgf*cm, ft.*lbf) : Specified torque ● Non-reusable part

P

ILLUSTRATION

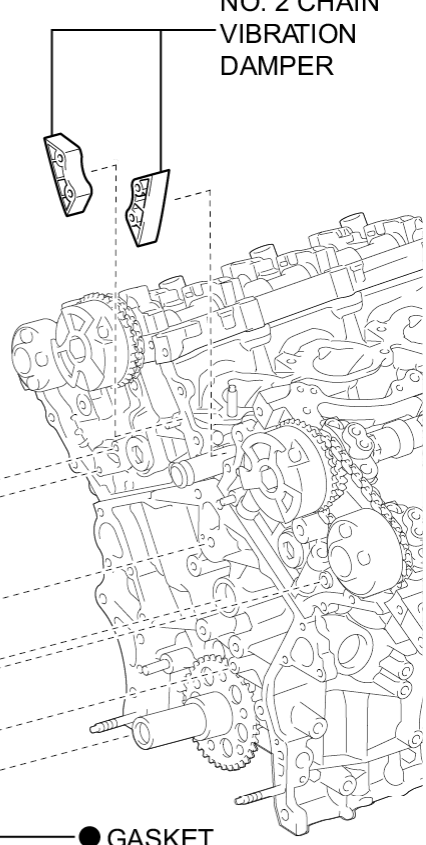

RH SIDE:

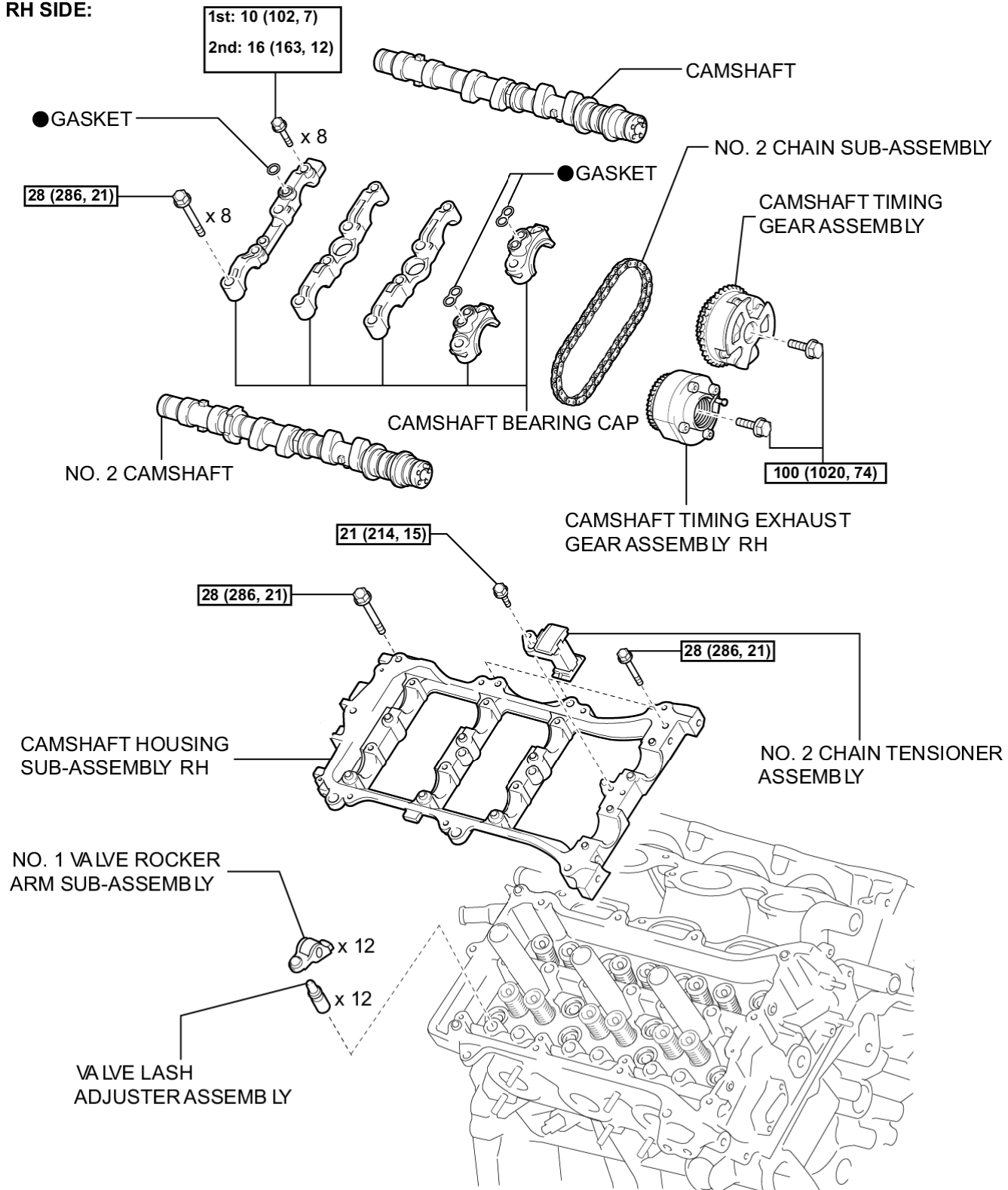

N*m (kgf*cm, ft.*lbf) : Specified torque

● Non-reusable part

P

ILLUSTRATION

LH SIDE:

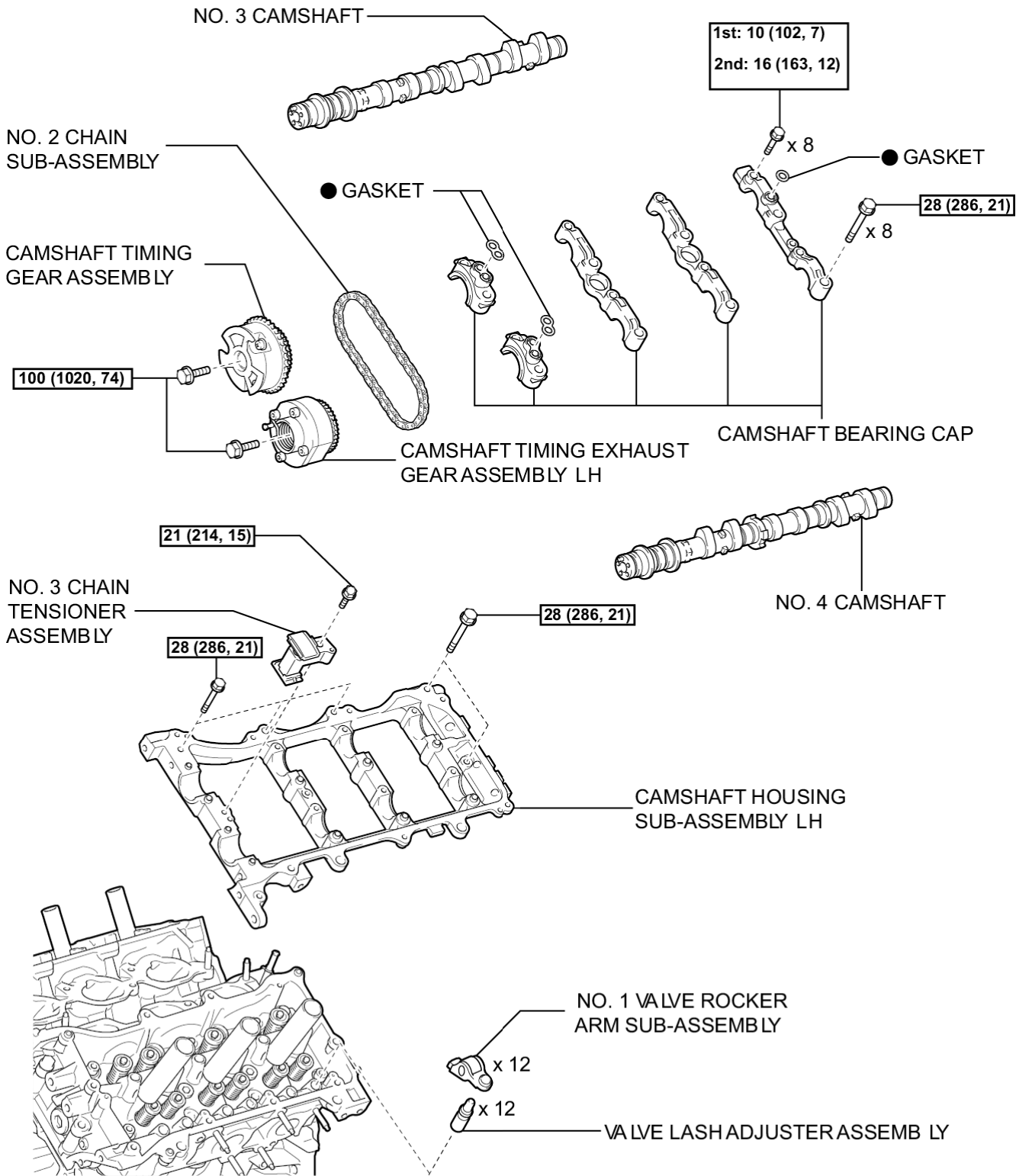

N*m (kgf*cm, ft.*lbf) : Specified torque ● Non-reusable part

P

ILLUSTRATION

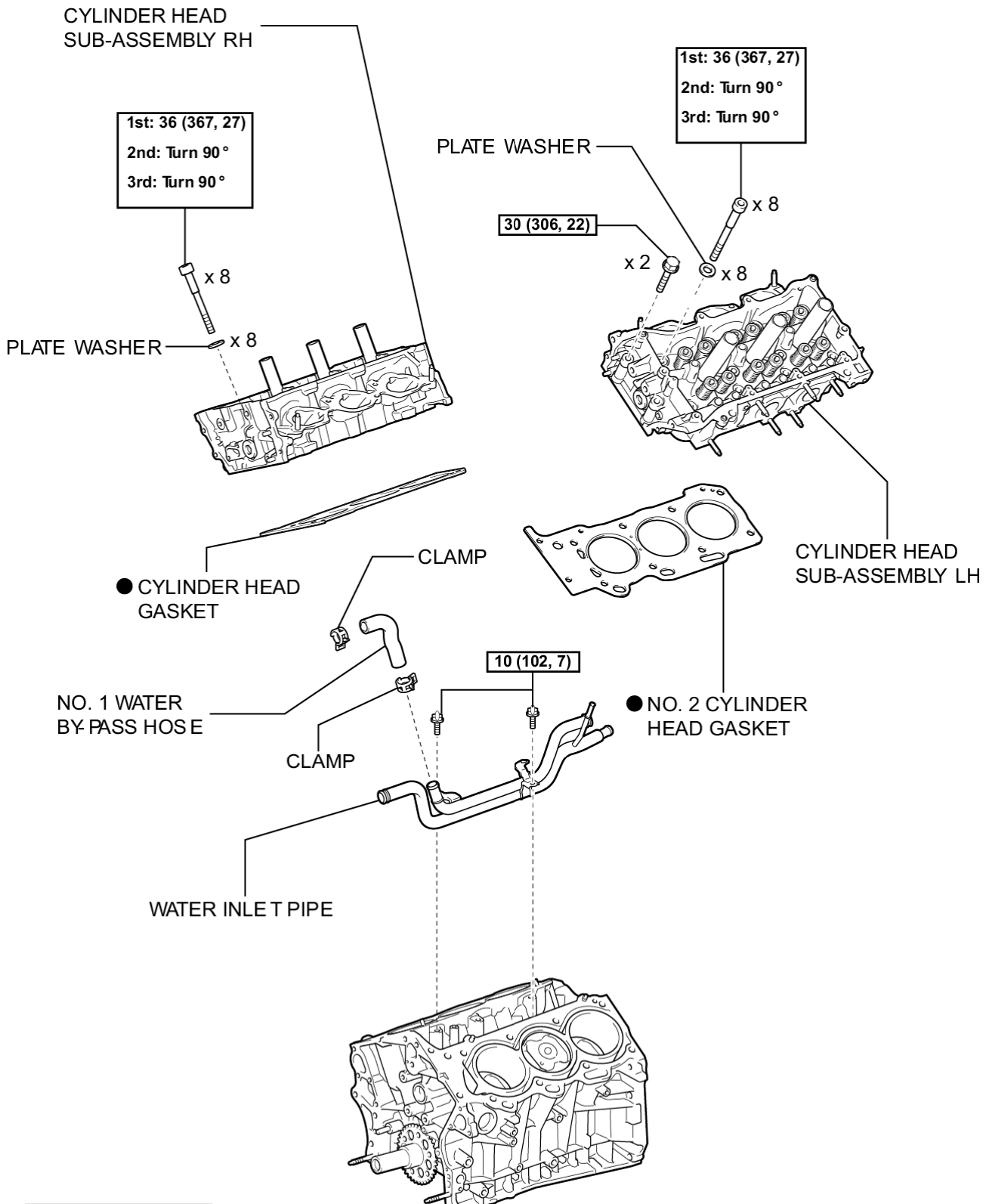

N*m (kgf*cm, ft.*lbf) : Specified torque ● Non-reusable part

P

ILLUSTRATION

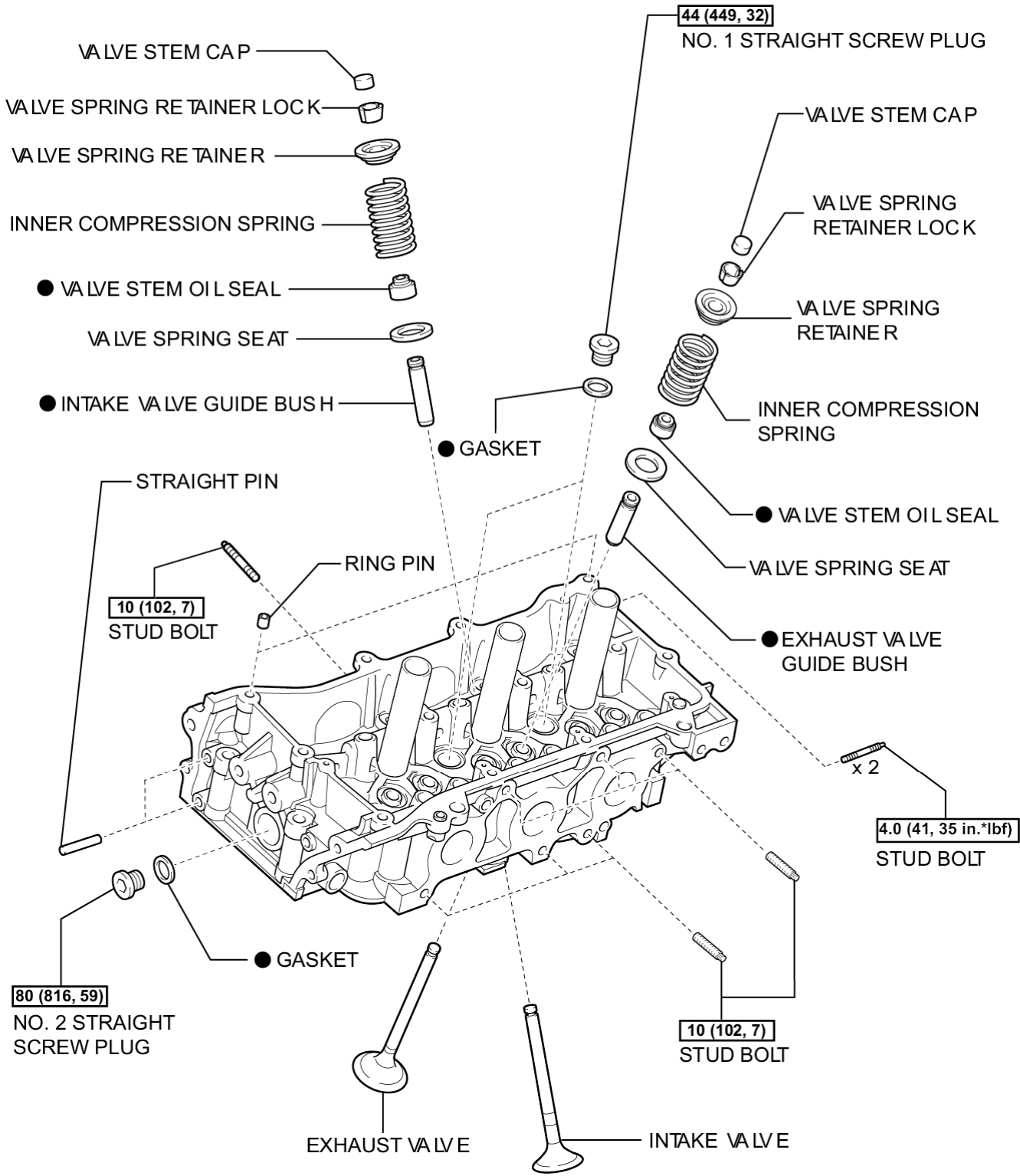

[N*m (kgf*cm, ft.*lbf)] : Specified torque ● Non-reusable part

P

ILLUSTRATION

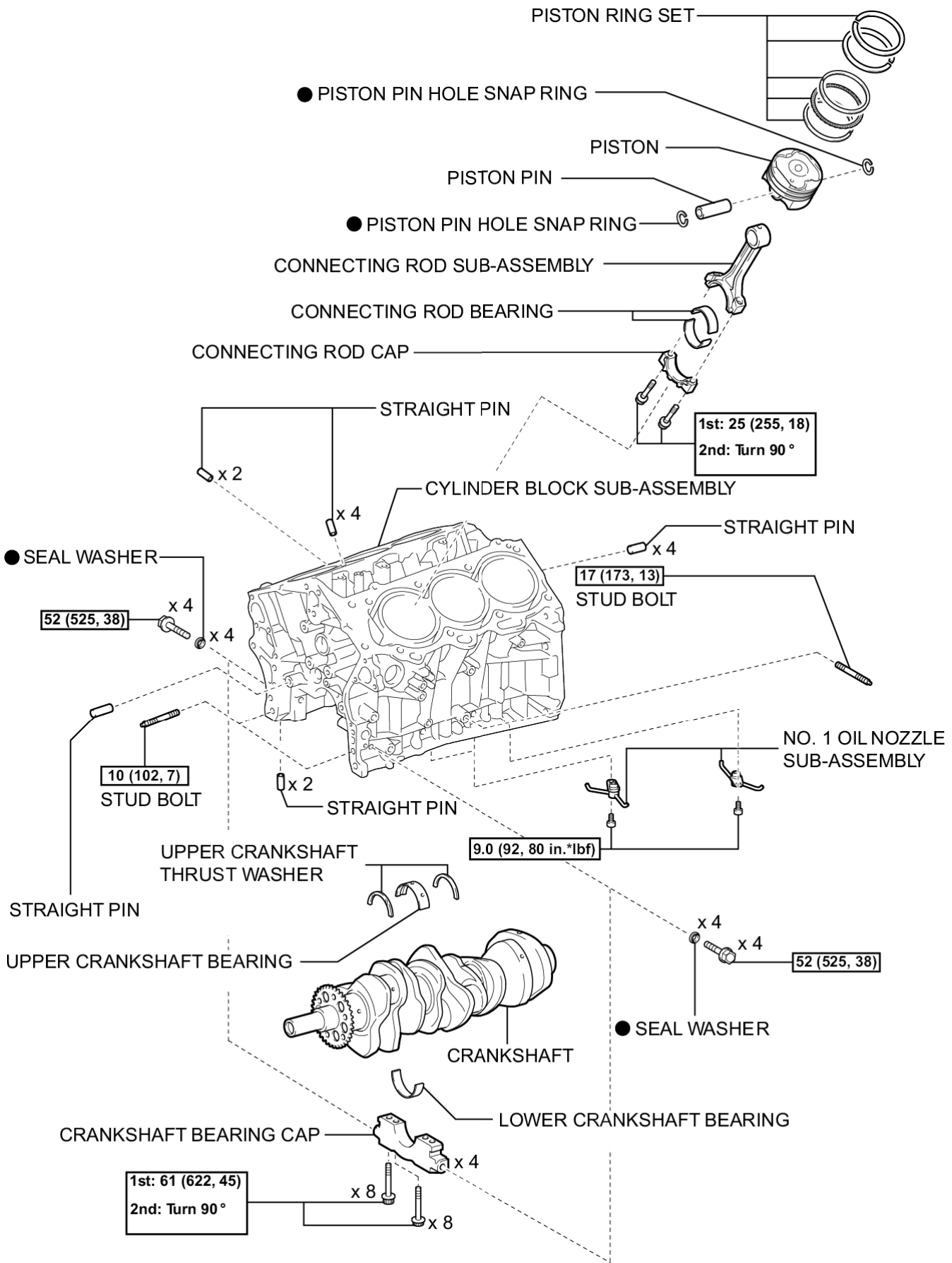

N*m (kgf*cm, ft.*lbf) : Specified torque ● Non-reusable part

