

# FRONT LOWER SUSPENSION ARM COMPONENTS

SAORM-01

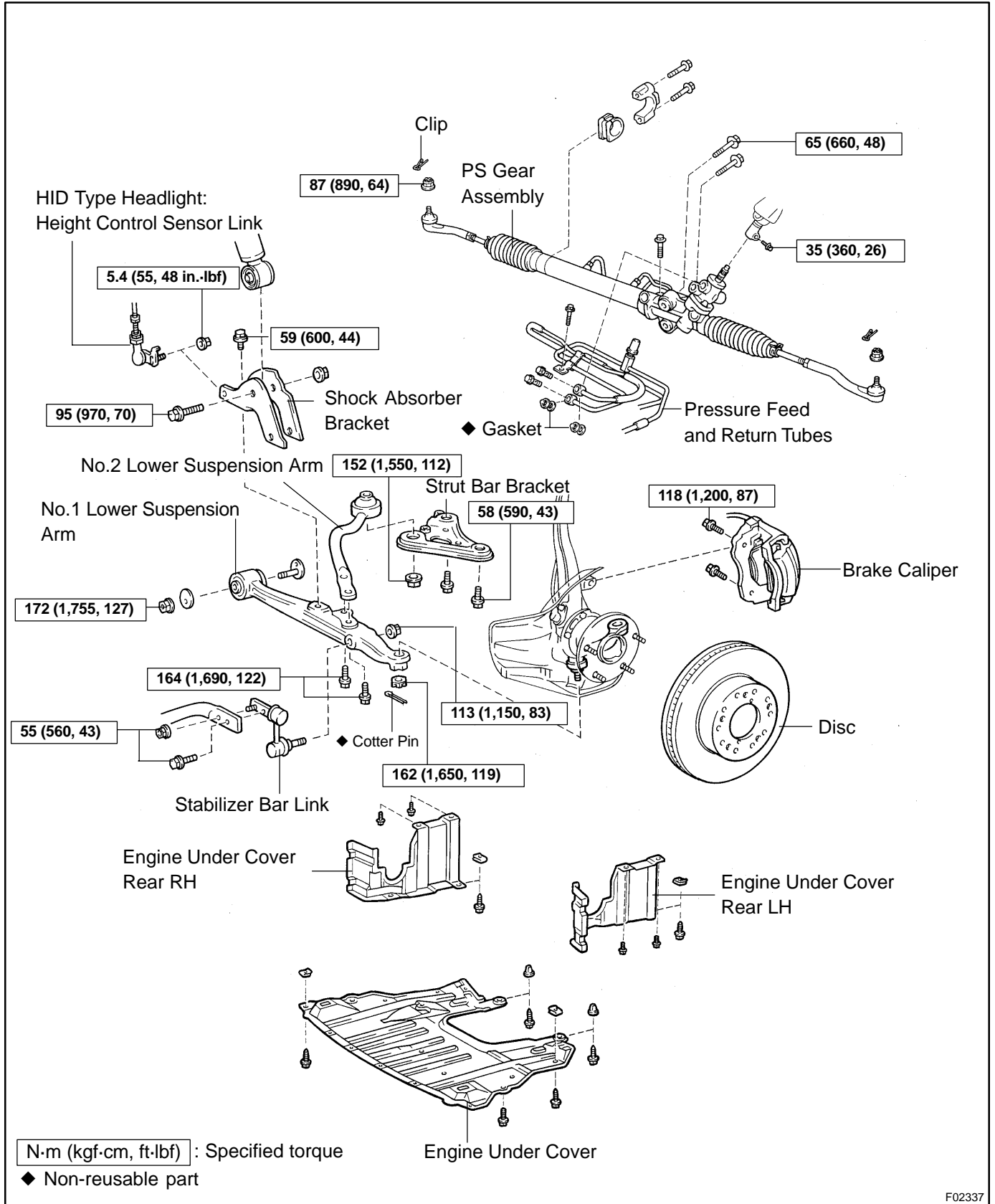

F02337

## REMOVAL

1. REMOVE FRONT WHEEL  
Torque: 103 N·m (1,050 kgf·cm, 76 ft·lbf)
2. REMOVE ENGINE UNDER COVERS

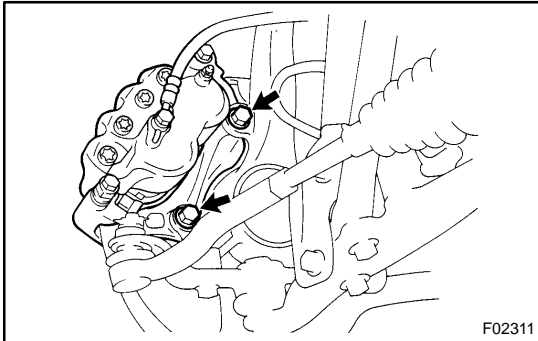

3. REMOVE BRAKE CALIPER
  - (a) Remove the 2 bolts and caliper.  
Torque: 118 N·m (1,200 kgf·cm, 87 ft·lbf)

- (b) Support the brake caliper securely.
  - (c) Remove the disc.

4. DISCONNECT TIE ROD END

- (a) Remove the clip and nut.  
Torque: 87 N·m (890 kgf·cm, 64 ft·lbf)

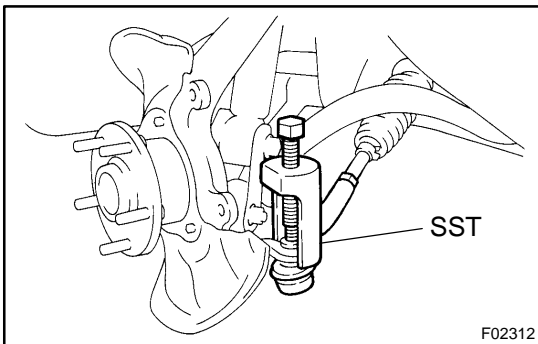

- (b) Using SST, disconnect the tie rod end from the steering knuckle.  
SST 09610-20012

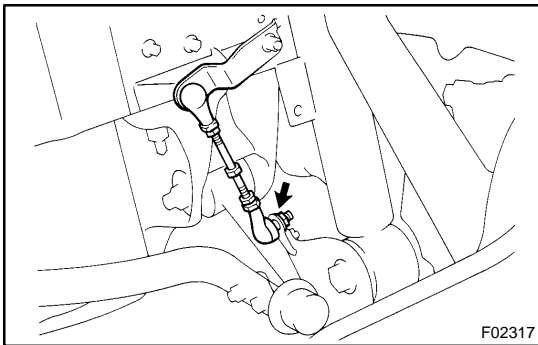

5. HID TYPE HEADLIGHT:  
DISCONNECT HEIGHT CONTROL SENSOR LINK FROM SHOCK ABSORBER BRACKET

Remove the nut and disconnect the height control sensor link from the shock absorber bracket.

**Torque: 5.4 N·m (55 kgf·cm, 48 in.-lbf)**

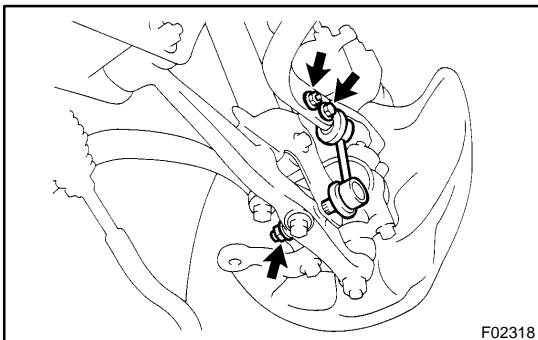

6. REMOVE STABILIZER BAR LINK

- (a) Remove the bolt and nut, disconnect the stabilizer bar link from the stabilizer bar.

**Torque: 55 N·m (560 kgf·cm, 43 ft·lbf)**

- (b) Remove the nut and stabilizer bar link.

**Torque: 113 N·m (1,150 kgf·cm, 83 ft·lbf)**

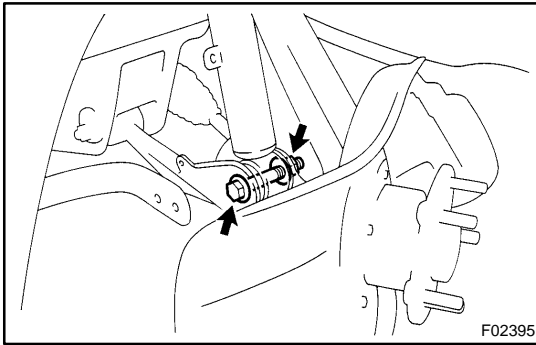
**7. DISCONNECT SHOCK ABSORBER**

Remove the bolt and nut, disconnect the shock absorber from the shock absorber bracket.

**Torque: 95 N·m (970 kgf·cm, 70 ft·lbf)**

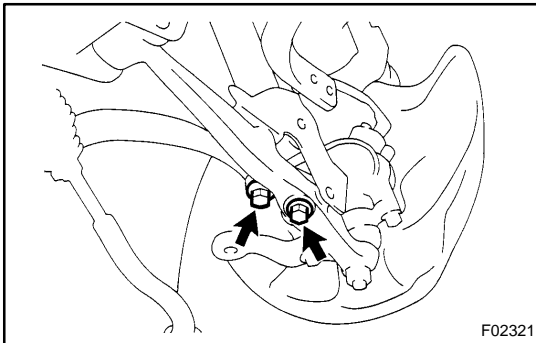
**8. LOOSEN NO.1 AND NO.2 LOWER SUSPENSION ARM SET BOLTS**

**Torque: 164 N·m (1,690 kgf·cm, 122 ft·lbf)**

**HINT:**

At the time of installation, after stabilizing the suspension, torque the bolts.

**9. DISCONNECT NO.2 LOWER SUSPENSION ARM**

(a) Remove the cotter pin and nuts.

**Torque: 162 N·m (1,650 kgf·cm, 119 ft·lbf)**

(b) Using SST, disconnect the No.2 lower suspension arm from the lower ball joint.

SST 09628-6201 1

**10. REMOVE STEERING GEAR ASSEMBLY**

(See page [SR-44](#) )

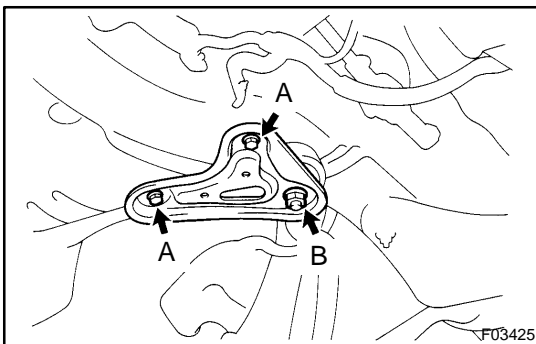
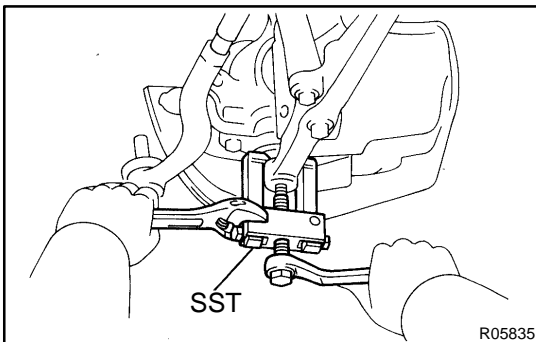
**11. REMOVE STRUT BAR BRACKET**

Remove the nut, 2 bolts and strut bar bracket.

**Torque:**

**A: 58 N·m (590 kgf·cm, 43 ft·lbf)**

**B: 152 N·m (1,550 kgf·cm, 112 ft·lbf)**

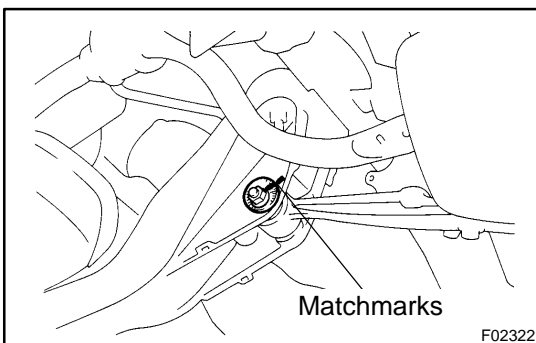
**12. REMOVE LOWER SUSPENSION ARM ASSEMBLY**

(a) Place matchmarks on the camber adjusting cam and suspension crossmember.

(b) Remove the bolt, nut and lower suspension arm assembly.

**Torque: 172 N·m (1,755 kgf·cm, 127 ft·lbf)**

**HINT:**

At the time of installation, after stabilizing the suspension, torque the nut.

**13. REMOVE NO.1 AND NO.2 LOWER SUSPENSION ARMS**

- (a) Remove the bolt, shock absorber bracket from the No.1 lower suspension arm.

**Torque: 59 N·m (600 kgf-cm, 44 ft-lbf)**

- (b) Remove the 2 bolts and separate the No.1 and No.2 lower suspension arms.

## INSTALLATION

Installation is in the reverse order of removal (See page [SA-30](#) ).

AFTER INSTALLATION, CHECK ABS SPEED SENSOR SIGNAL (See page [DI-412](#) ) AND FRONT WHEEL ALIGNMENT (See page [SA-4](#) )