

TELEPHONE MICROPHONE

COMPONENTS

CM

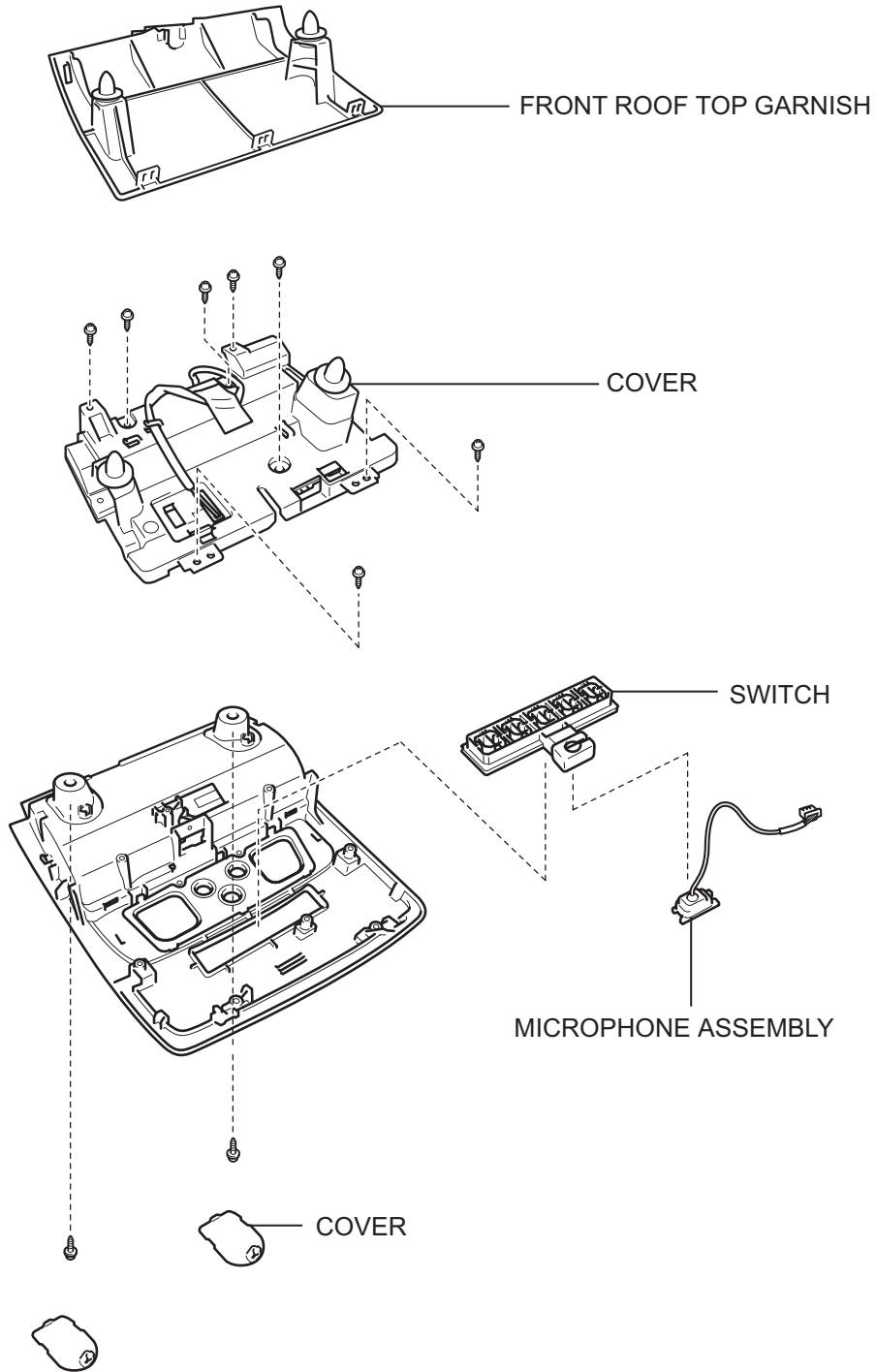

REMOVAL

1. **DISCONNECT CABLE FROM NEGATIVE BATTERY TERMINAL**

CAUTION:

Wait at least 90 seconds after disconnecting the cable from the negative (-) battery terminal to prevent airbag and seat belt pretensioner activation.

2. **REMOVE FRONT ROOF TOP GARNISH**

(a) Pull the cover in the direction indicated by the arrow in the illustration. Then remove the cover.

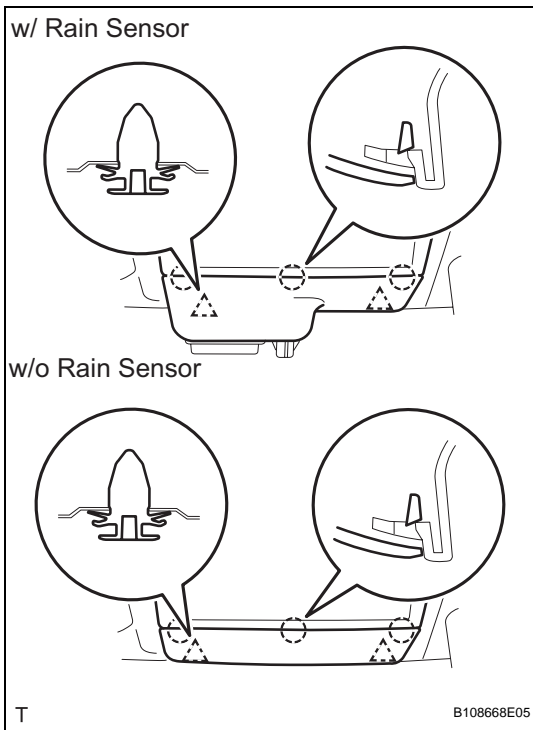
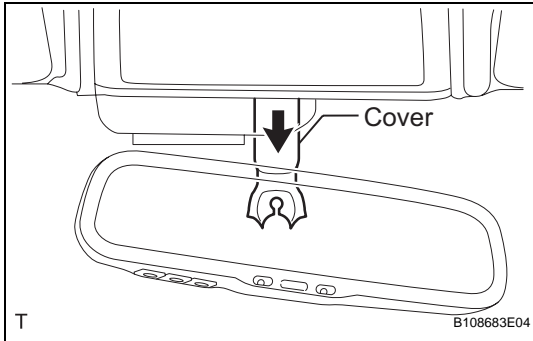

(b) Using a screwdriver, detach the 3 claws and 2 clips, and remove the top garnish.

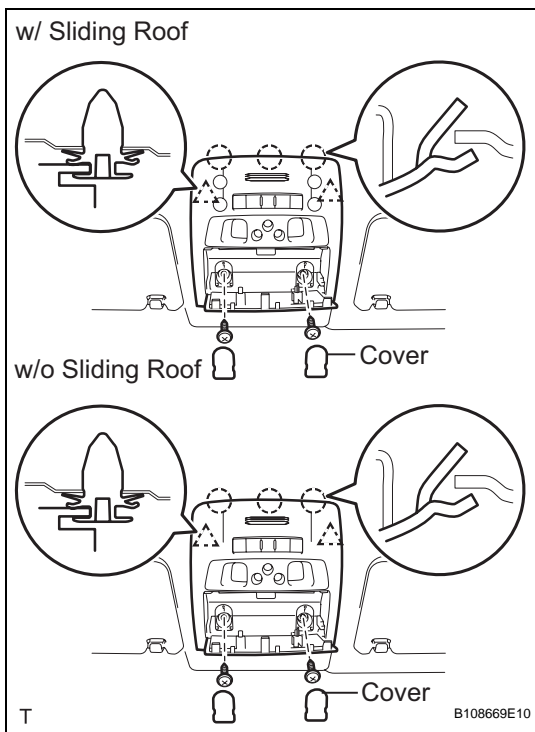

3. REMOVE PERSONAL LIGHT ASSEMBLY

- (a) Using a screwdriver, remove the 2 covers and 2 screws.
- (b) Using a moulding remover, detach the 2 clips and 3 claws.
- (c) Disconnect the connector and remove the personal light.

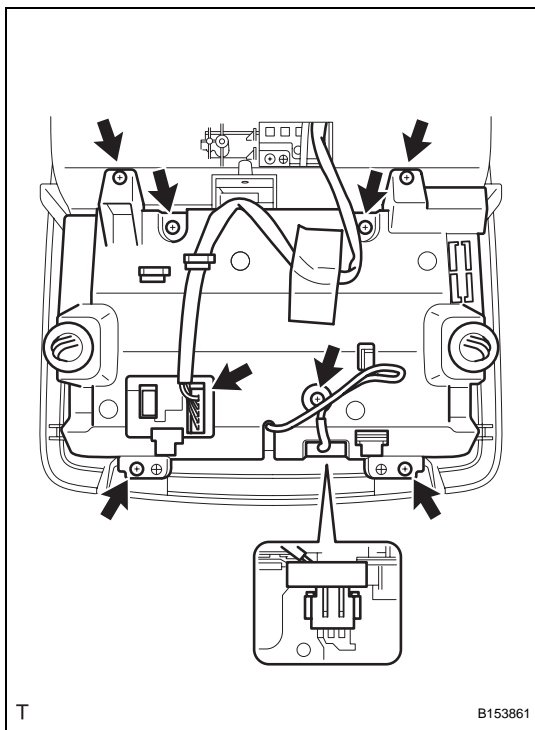

4. REMOVE MICROPHONE ASSEMBLY

- (a) Disconnect the 2 connectors.
- (b) Remove the 7 screws and cover.
- (c) Remove the microphone.

INSTALLATION

1. INSTALL MICROPHONE ASSEMBLY

- (a) Install the microphone.
- (b) Install the cover with the 7 screws.
- (c) Connect the 2 connectors.

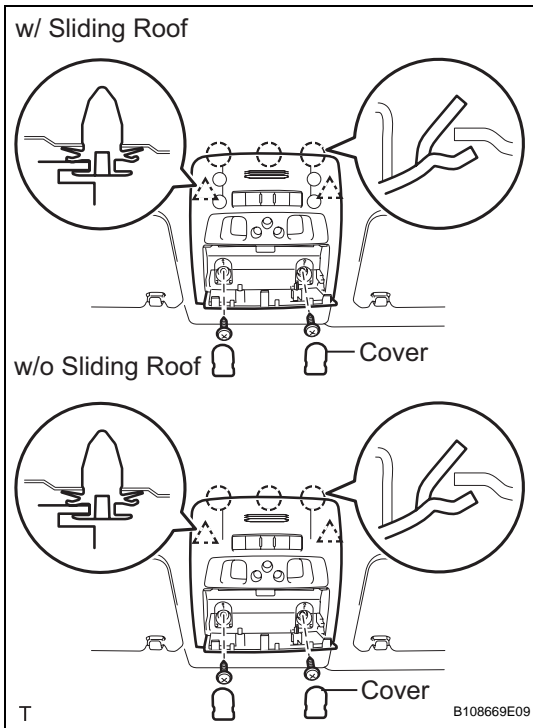
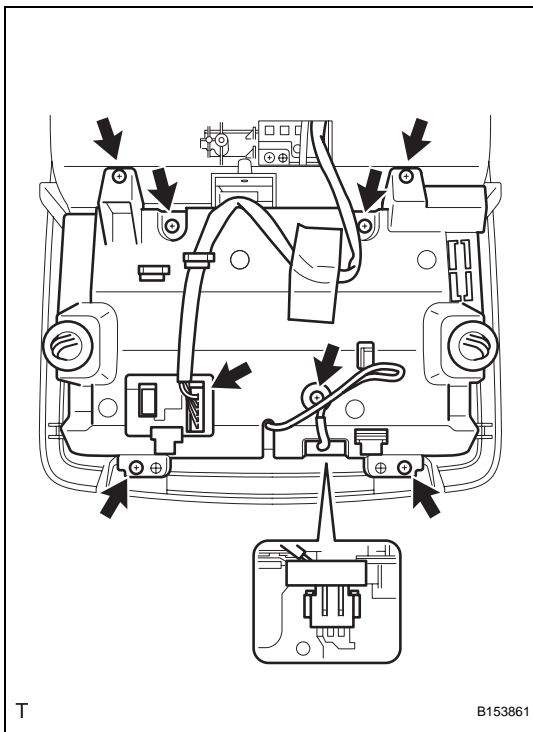

2. INSTALL PERSONAL LIGHT ASSEMBLY

- (a) Connect the connector.
- (b) Attach the 2 clips and 3 claws to install the personal light.
- (c) Install the 2 screws and 2 covers to the personal light.

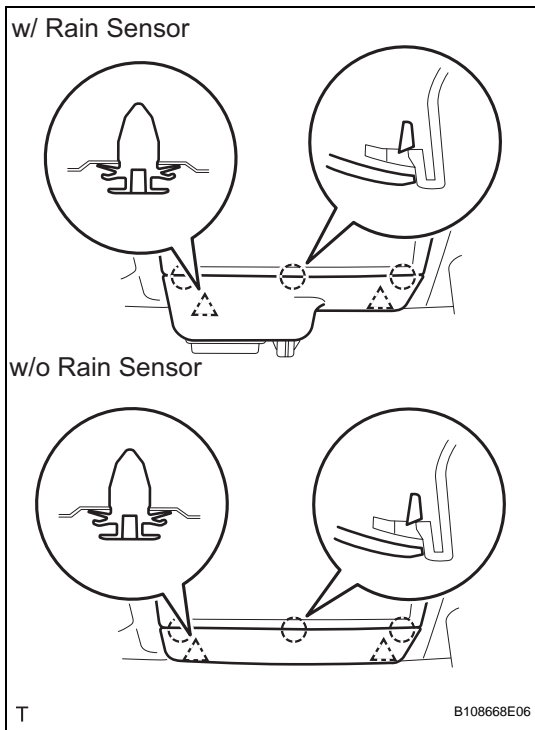

3. INSTALL FRONT ROOF TOP GARNISH

- (a) Attach the 3 claws and 2 clips to install the top garnish.

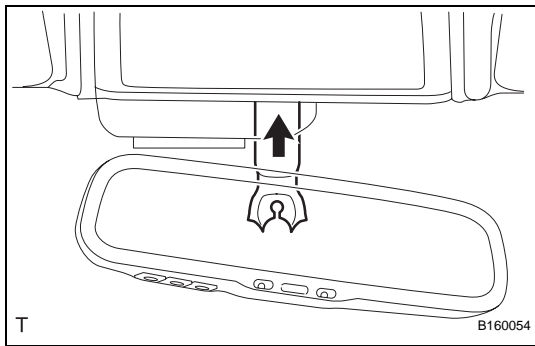

- (b) Push in the cover in the direction indicated by the arrow in the illustration. Then install the cover.

4. CONNECT CABLE TO NEGATIVE BATTERY TERMINAL

5. CHECK SRS WARNING LIGHT

- (a) Check the SRS warning light (see page [RS-34](#)).

6. PERFORM INITIALIZATION

- (a) Perform initialization (see page [IN-37](#)).

NOTICE:

Certain systems need to be initialized after disconnecting and reconnecting the cable from the negative (-) battery terminal.