

Head Unit removal resources:

<http://www.clublexus.com/forums/showthread.php?t=156160> by VVT-i

<http://www.clublexus.com/forums/showthread.php?t=253626> by kuch123

Tools: You will need a small flat head screw driver, a Phillips head screw driver, a 10mm socket and a towel to protect the navigation unit.

1) Remove the plastic trim underneath the cassette deck (just right above the ashtray) by prying it out with a small flat head screw driver.

Tip: *Wrap the screw driver blade with Scotch tape to protect the finish of the trim.*



2) Put the shifter into "D" position. DO NOT START THE CAR. Just press the start button twice (foot off brake pedal at this time) and put the shifter to "D" (or you can remove the shift lock tab above the "P" mark and press the release button so you can move the shifter to "D")

3) Remove the shift knob by rotating counter clockwise.



4) Pry up the top of the console. Start from the back towards where it narrows on both sides of the heated seats controls. It pops up easy there, then just run your fingers under each side and pop it up moving toward the dash. There are 3-4 clips on each side.



5) Unplug the two power/accessory plugs to completely remove the center console and set it aside.



6) Remove two Phillips screws, one from each side.



7) Remove each side panel by pulling the pack side outward towards the seat until the clips are out, then the whole thing pulls out from the dash by pulling backward towards the back of the car.



8) Remove two 10mm bolts from each side.

*TIP: Cover the center console area and shift stick with a towel to protect from any contact with the headunit.*

Find two metal tabs, one on each side attached directly where the bottom bolts screwed into. You can see one of them just below the bottom green circle.

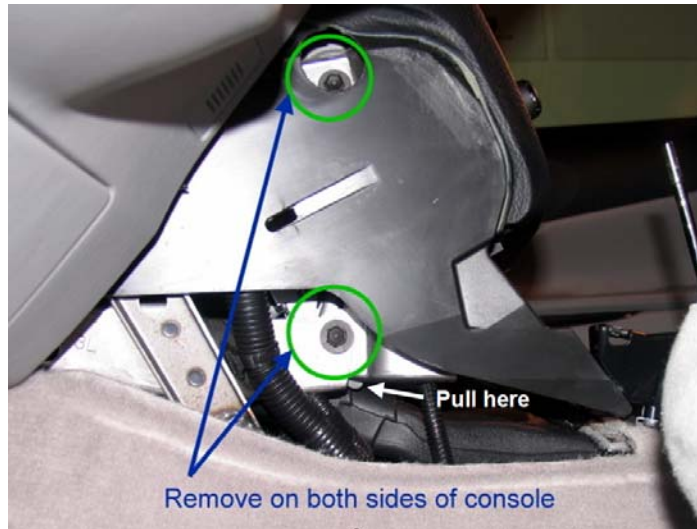

9) Grab these and pull to slide the entire head unit out. It takes a good pull to get it out. Use a rag to grab the tabs because they are a bit sharp.

Here is the head unit removed.

