

FRONT CONSOLE BOX > REMOVAL

for Preparation [Click here](#)

HINT:

- Use the same procedure for RHD and LHD vehicles.
- The procedure listed below is for LHD vehicles.

1. REMOVE CENTER INSTRUMENT CLUSTER FINISH PANEL

- a. Put protective tape around the center instrument cluster finish panel.

Text in Illustration

*1 Protective Tape

- b. Detach the 9 clips and guide.
- c. Disconnect the connector and remove the center instrument cluster finish panel.

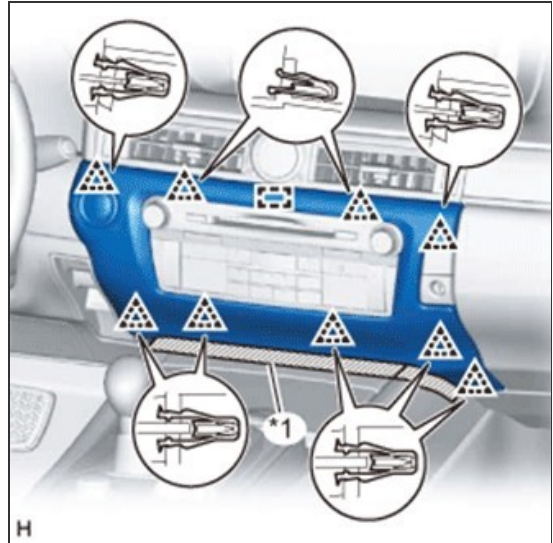

2. REMOVE INSTRUMENT PANEL FINISH PANEL END LH

- a. Put protective tape around the instrument panel finish panel end LH.

Text in Illustration

*1 Protective Tape

- b. Detach the 5 clips and 2 guides and remove the instrument panel finish panel end LH.

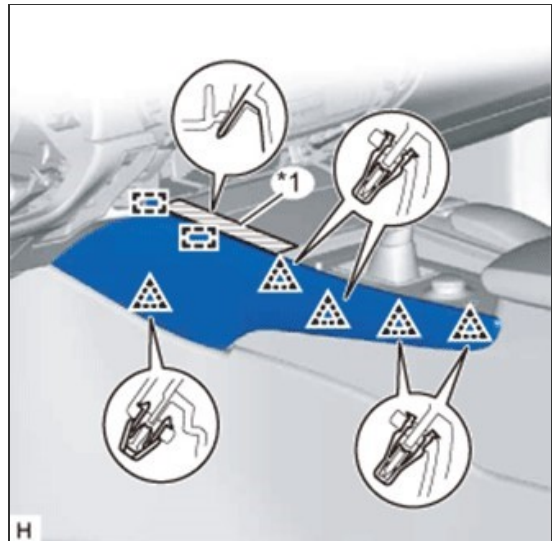

3. REMOVE INSTRUMENT PANEL FINISH PANEL END RH

- a. Put protective tape around the instrument panel finish panel end RH.

Text in Illustration

*1 Protective Tape

- b. Detach the 5 clips and 2 guides and remove the instrument panel finish panel end RH.

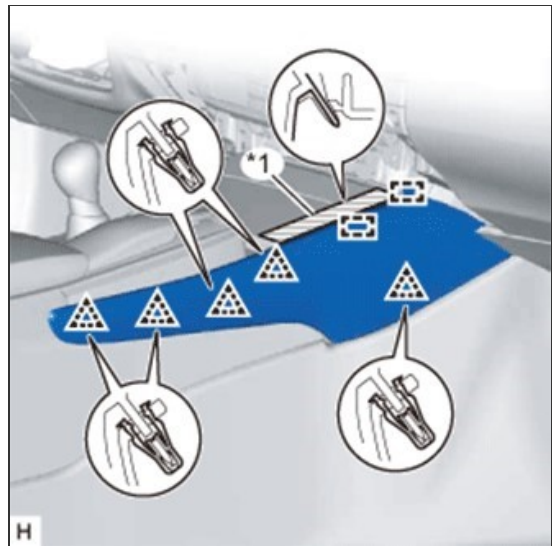

4. REMOVE SHIFT LEVER KNOB SUB-ASSEMBLY

- a. Detach the claw and slide the shifting hole cover downwards.
- b. Twist the shift lever knob sub-assembly in the direction indicated by the arrow and remove it.

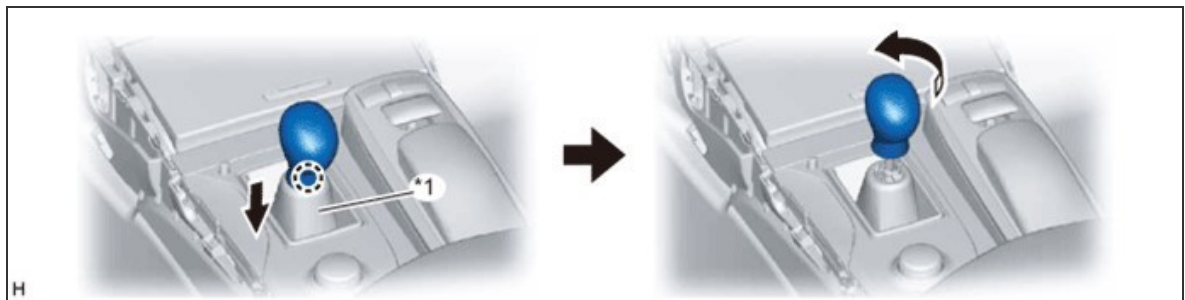

Text in Illustration

*1	Shifting Hole Cover	-	-
----	---------------------	---	---

5. REMOVE UPPER CONSOLE PANEL

- a. Remove the 2 screws.
- b. Detach the 9 clips.
- c. Disconnect the connectors, detach the clamps, and remove the upper console panel together with the upper rear console panel sub-assembly and remote touch assembly.

Text in Illustration

*1	Upper Console Panel
*2	Upper Rear Console Panel Sub-assembly
*3	Remote Touch Assembly

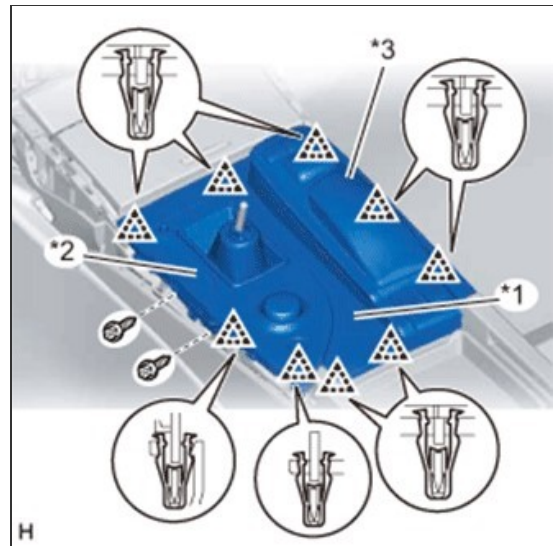

6. REMOVE INSTRUMENT PANEL CUP HOLDER ASSEMBLY

- Detach the 4 clips.
- Disconnect the connector and remove the instrument panel cup holder assembly.

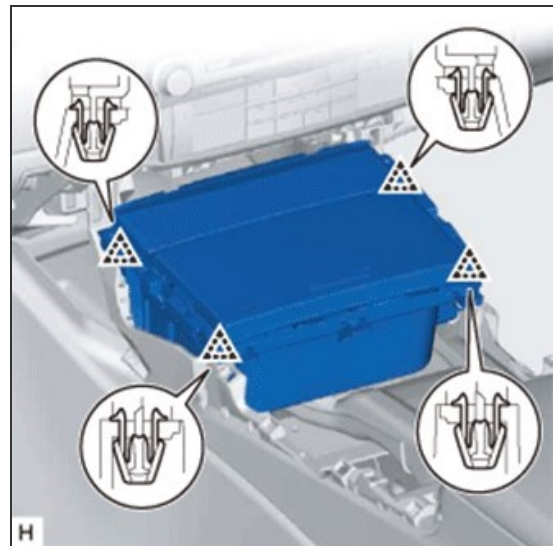

7. REMOVE REAR CONSOLE END PANEL

- Detach the 4 clips, 2 claws and 2 guides.
- Disconnect the connector and remove the rear console end panel.