

2. DTC CHECK (USING SST CHECK WIRE)

(a) Checking DTCs using a SST check wire.

SST 09843-18040

(1) Using the SST, connect terminals TC and CG of DLC3.

(2) Turn the ignition switch ON.

(3) Read and record any DTCs from the height control OFF indicator lamp on the combination meter. Refer to the chart on the left for examples of a normal code and codes 13 and 33.

HINT:

- If the height control OFF indicator lamp does not blink any DTC codes or the normal code, inspect the height control OFF indicator lamp circuit (See page 05-549) and the TC terminal circuit (See page 05-552).
- If 2 or more malfunctions are indicated at the same time, the lowest numbered DTC is displayed first.

(4) Refer to the Diagnostic Trouble Code Chart (See page 05-477) for DTC information.

(5) After completing the check, remove SST check wire from DLC3.

SST 09843-18040

(b) Clearing the DTCs using the SST check wire.

SST 09843-18040

(1) Using SST, connect terminals TC and CG of DLC3.

(2) Turn the ignition switch ON.

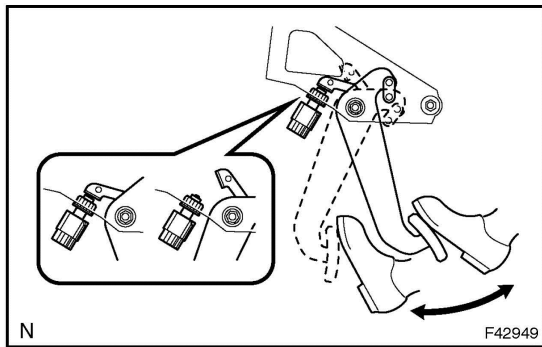

- (3) Clear DTC stored in ECU by depressing the brake pedal 8 times or more within 5 sec.
- (4) Check that the height control OFF indicator lamp shows the normal code.
- (5) Remove SST check wire from DLC3.

SST 09843-18040

HINT:

Disconnect the battery cable during the operation will not erase DTC in ECU.