

2. DTC CHECK (USING SST CHECK WIRE)

(a) Checking DTCs using a SST check wire.

SST 09843-18040

- (1) Using the SST, connect terminals TC and CG of DLC3.
- (2) Turn the ignition switch ON.

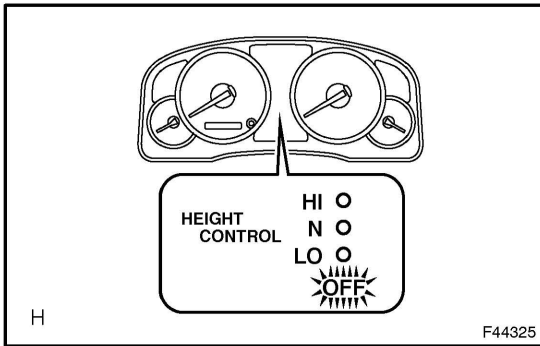

- (3) Read and record any DTCs from the height control OFF indicator lamp on the combination meter. Refer to the chart on the left for examples of a normal code and codes 13 and 33.

HINT:

- If the height control OFF indicator lamp does not blink any DTC codes or the normal code, inspect the height control OFF indicator lamp circuit (See page 05-549) and the TC terminal circuit (See page 05-552).
- If 2 or more malfunctions are indicated at the same time, the lowest numbered DTC is displayed first.

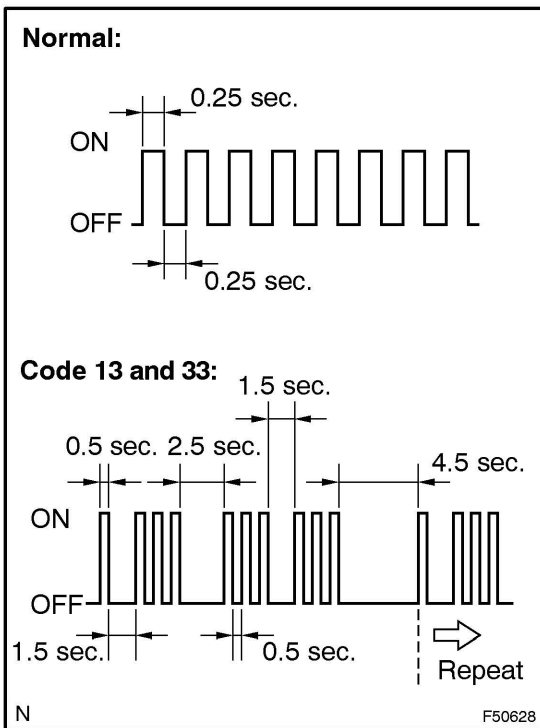

- (4) Refer to the Diagnostic Trouble Code Chart (See page 05-477) for DTC information.
- (5) After completing the check, remove SST check wire from DLC3.

SST 09843-18040

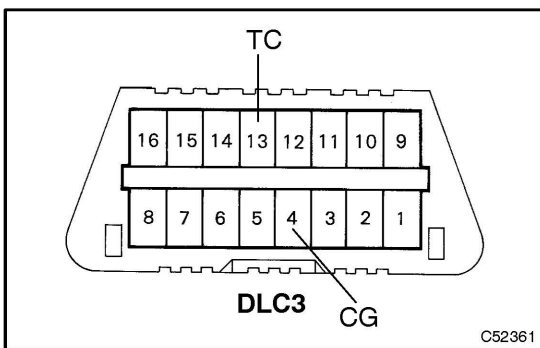

(b) Clearing the DTCs using the SST check wire.

SST 09843-18040

- (1) Using SST, connect terminals TC and CG of DLC3.
- (2) Turn the ignition switch ON.

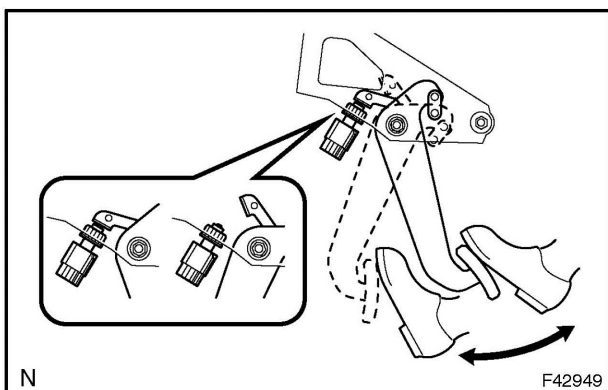

- (3) Clear DTC stored in ECU by depressing the brake pedal 8 times or more within 5 sec.
- (4) Check that the height control OFF indicator lamp shows the normal code.
- (5) Remove SST check wire from DLC3.

SST 09843-18040

HINT:

Disconnect the battery cable during the operation will not erase DTC in ECU.