

## Toyota and Lexus KDSS service and repair – GX460, GX460, 4Runner and Land Cruiser

[Home](#) / [Lexus](#) / [4Runner](#) / [GX470](#) / [Land Cruiser](#) / [GX460](#) / [KDSS](#) / [Toyota and Lexus KDSS service and repair – GX460, GX460, 4Runner and Land Cruiser](#)

[◀ Previous](#) [Next ▶](#)

### Toyota and Lexus KDSS service and repair – GX460, GX460, 4Runner and Land Cruiser

Some late model GX460, GX470, 4Runner and Land Cruisers are equipped with Toyota's Kinetic Dynamic Suspension System. Acting like a sway bar disconnect popular with the off road crowd, KDSS allows the benefits of a disconnected sway bar without having to crawl underneath your truck.

The system has it's own dedicated fluid, lines, cylinders and valve body that control the sway of the truck on and off road. There is a special service tool used to replace and bleed the KDSS fluid. It looks like this:

Article Categories

Article Categories

Related posts:

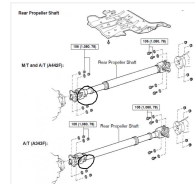

**Toyota and Lexus SUV bump, kick**



**Toyota and Lexus 4.7L V8 2UZ-FE**



**Toyota Sequoia, Tundra, 4Runner**



**GX470/LX470 check engine**

Recent Posts





KDSS Service Tool

The most common symptoms of KDSS failure is a severely uneven ride height side to side and/or a flashing KDSS light. The vehicle will also sway more than normal during a turn. Fluid leaks from the cylinder aren't uncommon as well.

As Eden Prairie and Chanhassen's Toyota and Lexus specialist, CARspec offers KDSS repair and service at a price point lower than all local dealerships. Because the tool is available to the aftermarket only via special order, CARspec is one of only a handful of independent auto repair shops in the Midwest that are able to service the system outside of the dealership.

If you've got KDSS problems in the Minneapolis metro, give us a call today!

**Related Posts:**

1. **Toyota and Lexus SUV bump, kick or jump after stopping – sticking rear driveshaft repair**  
Toyota and Lexus SUV bump, kick or jump after stopping - sticking rear driveshaft repair and maintaining your u-joint and slip yokes...
2. **Toyota and Lexus 4.7L V8 2UZ-FE timing belt replacement note** Replacing the timing belt on a 2UZ-FE, with a little surprise in there for good measure...
3. **Toyota Sequoia, Tundra, 4Runner and Land Cruiser, Lexus GX470 and LX470 engine ticking/exhaust manifold leak** Toyota Sequoia, Tundra, 4Runner and Land Cruiser, Lexus GX470 and LX470 engine ticking/exhaust manifold leak...
4. **GX470/LX470 check engine light, secondary air injection malfunction** GX470/LX470 check engine light, secondary air injection malfunction...

- > **Toyota and Lexus jump start backwards – what to do now**
- > **LX470 vibration when accelerating, no vibration when not accelerating**
- > **Lexus GX470 and LX470 thump, clunk from a stop or taking off – driveshaft binding**
- > **2006-2012 IS250, GS300, GS350 P0420, P0430 check engine light and/or car is loud – pinhole leak at y-pipe assembly**

Find us on Facebook

Recent Tweets

An adorable Prius battery (banana for scale) @ CARspec [instagram.com/p/BrTB...](https://www.instagram.com/p/BrTB...)

12:26 pm · December 12, 2018



Share This Story, Choose Your Platform!

About the Author: **John Cleveland**



After years of experience working for the dealerships, owner John Cleveland set out to start a new kind of shop for Toyota, Lexus and Scion owners unlike any in Minnesota – one that offers a competitive price point, technical prowess, honesty and environmentally friendly practices.

Comments are closed.

#### RECENT TWEETS

An adorable Prius battery (banana for scale) @ CARspec [instagram.com/p/BrTB...](https://www.instagram.com/p/BrTB...)  
 12:26 pm · December 12, 2018

#### FIND US ON FACEBOOK

#### PHOTO GALLERY

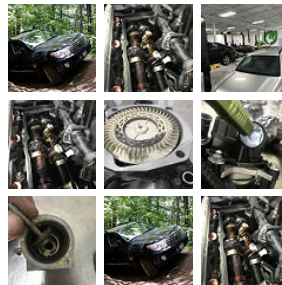

#### CALENDAR OF EVENTS

| Mon | Tue | Wed | Thu | Fri | Sat | Sun |
|-----|-----|-----|-----|-----|-----|-----|
| 25  | 26  | 27  | 28  | 1   | 2   | 3   |
| 4   | 5   | 6   | 7   | 8   | 9   | 10  |
| 11  | 12  | 13  | 14  | 15  | 16  | 17  |
| 18  | 19  | 20  | 21  | 22  | 23  | 24  |
| 25  | 26  | 27  | 28  | 29  | 30  | 31  |

**Disclaimer:** CARspec is an independently owned and operated business not affiliated with Toyota Motor Corp or any other subsidiary, dealership, or supplier. The Toyota, Lexus, Scion, Prius, Hybrid Synergy Drive, Hybrid, Plug in Hybrid, or any other Toyota, Lexus, and Scion logos and language seen here are trademarks of their respective owners and are used to illustrate the type of vehicles CARspec services. CARspec is not a Toyota, Lexus or Scion dealership nor a factory-authorized repair facility.

Copyright © 2014 CARspec. All Rights Reserved.

