

FUEL SYSTEM > ON-VEHICLE INSPECTION

for Preparation [Click here](#)

1. CHECK FUEL PUMP OPERATION AND FOR FUEL LEAK

- a. Connect the intelligent tester to the DLC3.
- b. Turn the engine switch on (IG).
NOTICE:
Do not start the engine.
- c. Turn the intelligent tester on.
- d. Enter the following menus: Powertrain / Engine and ECT / Active Test / Control the Fuel Pump / Speed.
- e. Check the fuel pump operation.
 - i. Check for pressure in the fuel inlet tube from the fuel line. Check that the sound of fuel flowing in the fuel tank can be heard.
If there is no sound, check the integration relay, fuel pump, ECM and wiring connector.
- f. Inspect for fuel leaks ([Click here](#)).

2. CHECK FUEL PRESSURE

- a. Check the battery voltage ([Click here](#)).
- b. Discharge the fuel system pressure ([Click here](#)).
- c. Disconnect the cable from the negative (-) battery terminal.

NOTICE:

- **w/ Navigation System (for HDD):**
After the engine switch is turned off, the display and navigation module display (HDD navigation system) records various types of memory and settings. As a result, after turning the engine switch off, be sure to wait for the time specified in the following table before disconnecting the cable from the negative (-) battery terminal.

Waiting Time before Disconnecting Cable from Negative (-) Battery Terminal:

Condition	Waiting Time
Vehicle enrolled in G-BOOK system	6 minutes
Vehicle not enrolled in G-BOOK system	1 minute

- When disconnecting the cable, some systems need to be initialized after the cable is reconnected ([Click here](#)).

d. Disconnect the fuel hose ([Click here](#)).

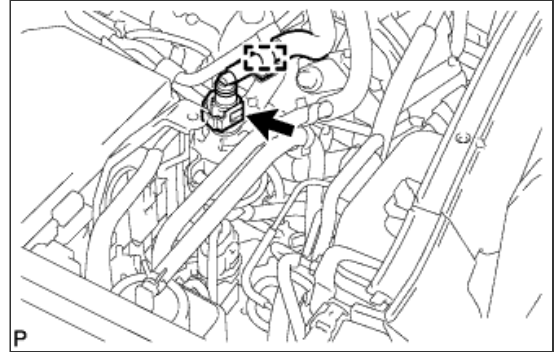

e. Install SST (pressure gauge) as shown in the illustration.

SST

**09268-31012 (90467-13001, 95336-08070, 09268-41500, 09268-41120)
09268-45014 (09268-41200, 09268-41220)**

Text in Illustration

*1	SST (3 Way)
*2	SST (Clip)
*3	SST (Gauge)
*4	Fuel Tube
*5	SST (Hose)
*6	SST (Fuel Tube Connector)

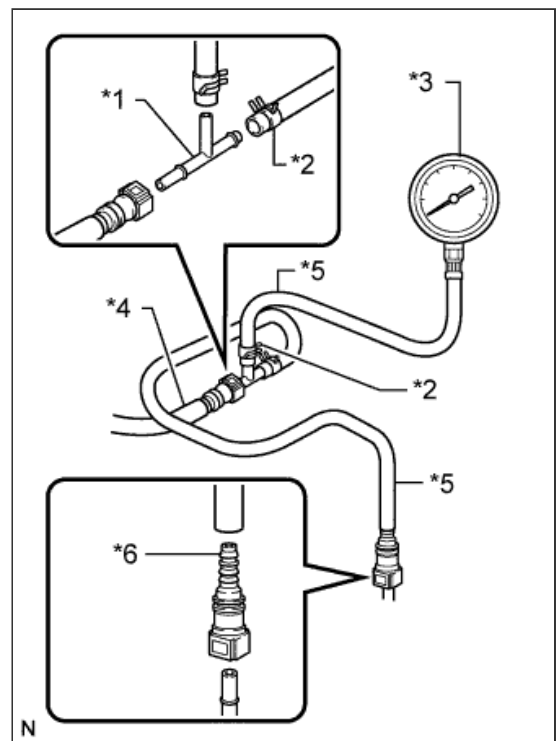

f. Wipe off any gasoline.

g. Reconnect the cable to the negative (-) battery terminal.

h. Operate the fuel pump.

i. Connect the intelligent tester to the DLC3.

ii. Turn the engine switch on (IG).

NOTICE:

Do not start the engine.

iii. Turn the intelligent tester on.

iv. Enter the following menus: Powertrain / Engine and ECT / Active Test / Control the Fuel Pump / Speed.

i. Measure the fuel pressure.

Standard fuel pressure:

321 to 327 kPa (3.27 to 3.33 kgf/cm², 46.5 to 47.4 psi)

If the pressure is higher than the specification, replace the fuel pressure regulator.

If the pressure is below the specification, check the fuel hoses and connections, fuel pump, fuel filter and fuel pressure regulator.

j. Start the engine.

k. Measure the fuel pressure.

Standard fuel pressure:

321 to 327 kPa (3.27 to 3.33 kgf/cm², 46.5 to 47.4 psi)

If the pressure is not as specified, check the fuel pump, pressure regulator and/or injectors.

l. Stop the engine.

m. Check that the fuel pressure remains as specified for 5 minutes after the engine has stopped.

Standard fuel pressure:

147 kPa (1.5 kgf/cm², 21 psi) or higher

If the pressure is not as specified, check the fuel pump, pressure regulator and/or injectors.

n. After checking the fuel pressure, disconnect the cable from the negative (-) battery terminal and carefully remove SST and the fuel tube connector to prevent gasoline from spraying.

o. Connect the fuel hose ([Click here](#)).

p. Inspect for fuel leaks ([Click here](#)).

