

## FUEL SYSTEM > DETAILS

### CONSTRUCTION

#### a. Fuel Injector Assembly

- i. A 12-hole fuel injector assembly with optimized fuel flow amount is used to improve the atomization of fuel.

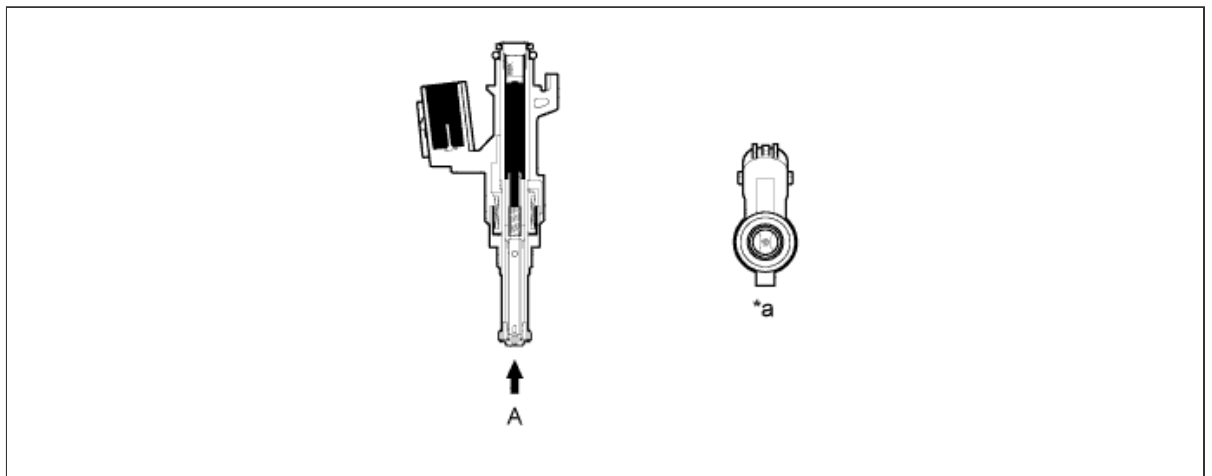

#### Text in Illustration

*a	View from A	-	-
----	-------------	---	---

#### b. Fuel Delivery Pipe

- i. Fuel delivery pipes formed from stamped steel are used to deliver fuel to the fuel injectors.
- ii. A pulsation damper is provided on the fuel delivery pipe in the left bank. A fuel pressure regulator is installed on the right bank fuel delivery pipe.

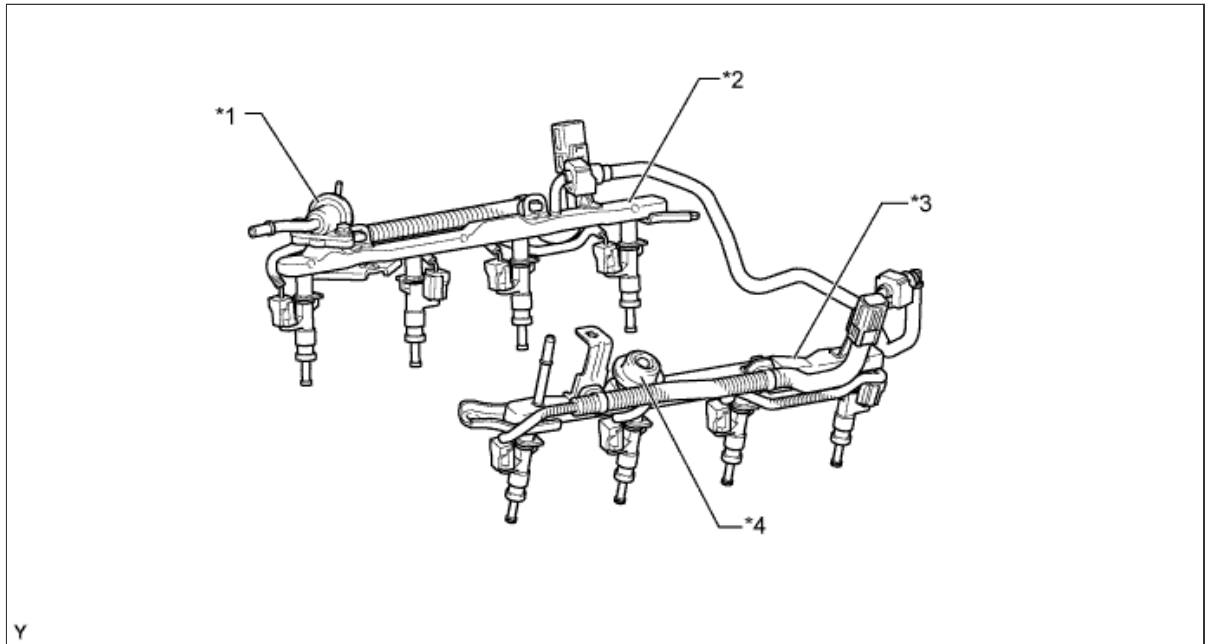

**Text in Illustration**

*1	Fuel Pressure Regulator	*2	Fuel Delivery Pipe (Right Bank)
*3	Fuel Delivery Pipe (Left Bank)	*4	Pulsation Damper

**c. Fuel Tank**

- i. A multi-layer plastic fuel tank is used. The multiplex layered plastic fuel tank consists of six layers of four types of materials, and one of those is a recyclable material to address environmental concerns.

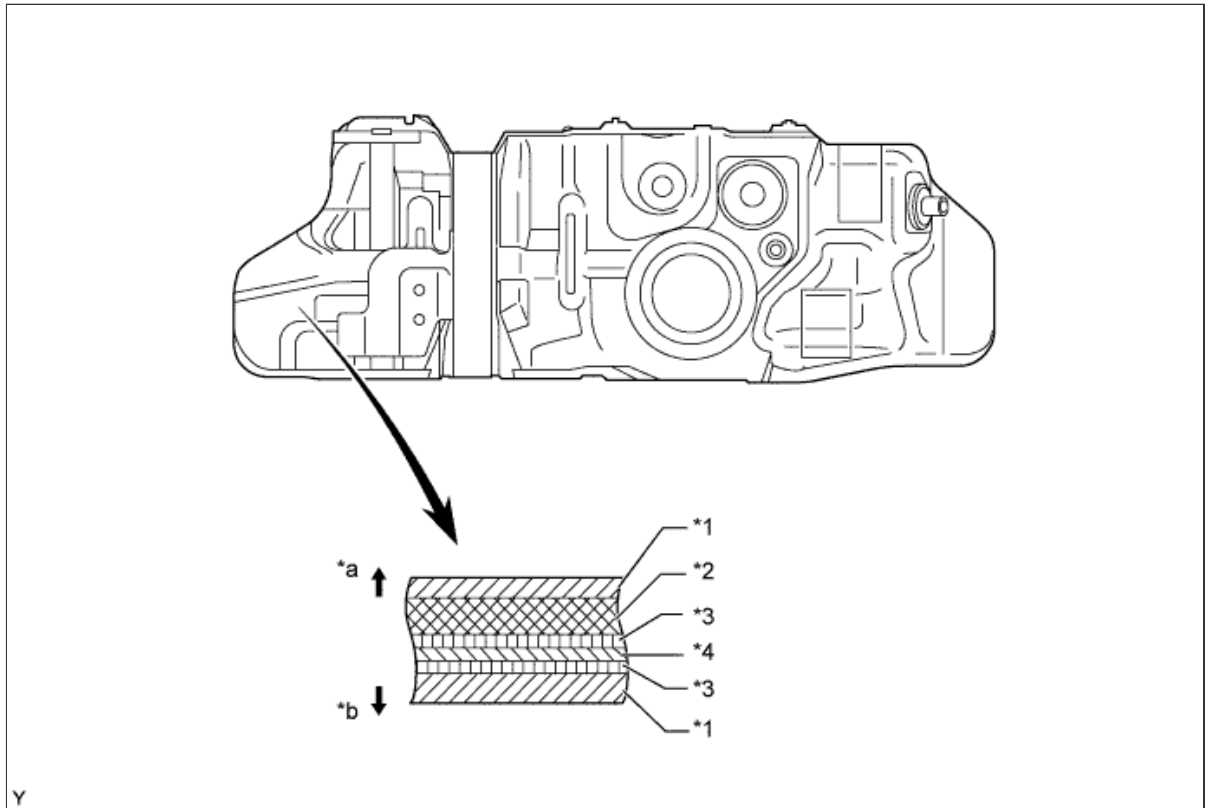

**Text in Illustration**



*1	High Density Polyethylene (HDPE)	*2	Regrind Material
*3	Adhesive	*4	Ethylene Vinyl Alcohol Copolymer (EVOH)
*a	Fuel Tank Outside	*b	Fuel Tank Inside

**d. Fuel Filter**

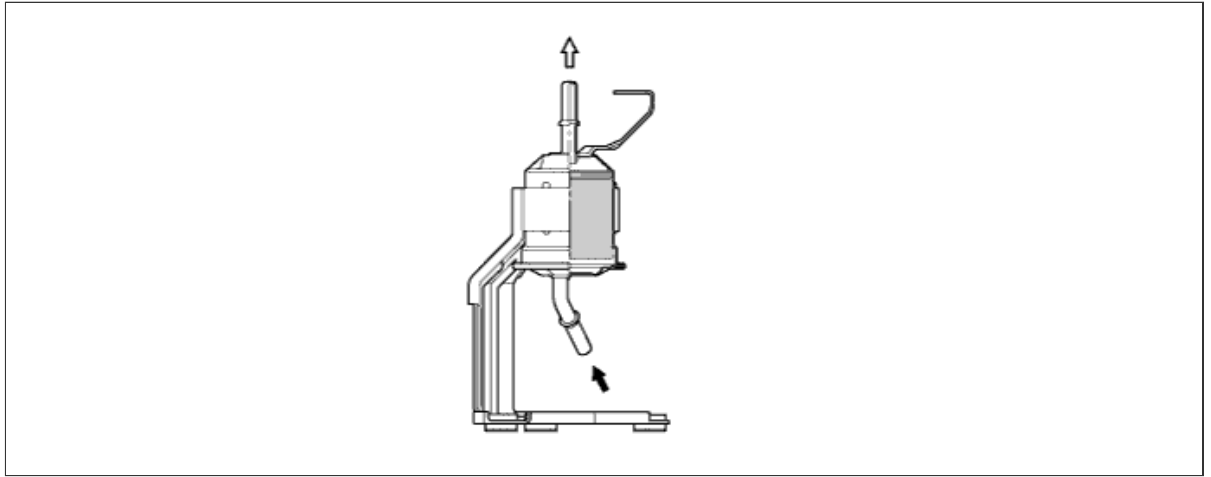
- i. A compact, lightweight fuel filter is used.



**Text in Illustration**

	Fuel Inlet		Fuel Outlet
---	------------	---	-------------

