

COOLING SYSTEM > GENERAL

OUTLINE

- a. The cooling system is a pressurized, forced-circulation type. The reservoir tank is not pressurized.
- b. A thermostat with a bypass valve is located in the water inlet housing to maintain suitable temperature distribution in the cooling system.
- c. Toyota Genuine Super Long Life Coolant (SLLC) is used.

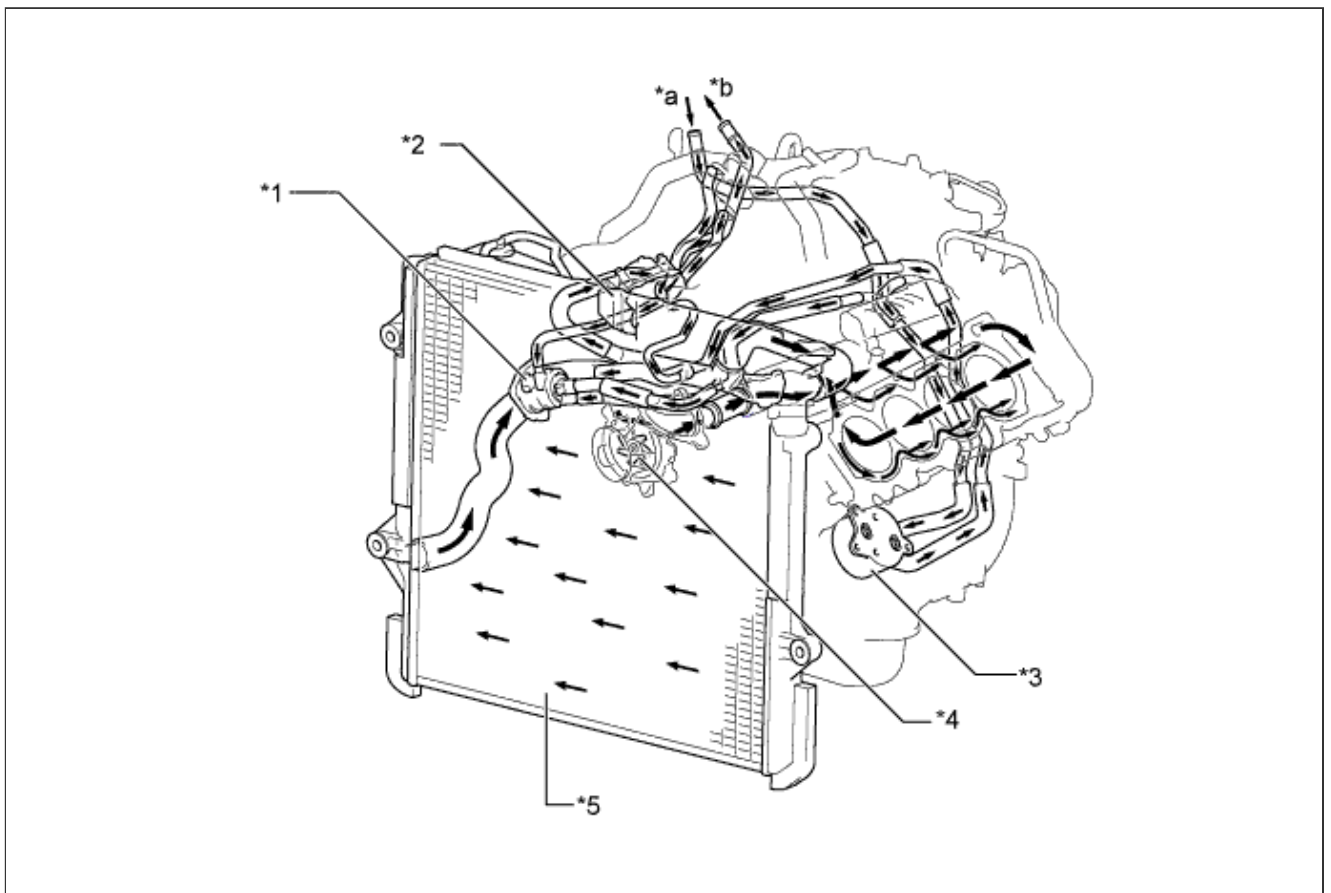

Text in Illustration

*1	Thermostat	*2	Throttle Body Assembly
*3	ATF Warmer	*4	Water Pump
*5	Radiator	-	-
*a	From Heater Core	*b	To Heater Core

SPECIFICATION

a. Engine Coolant

i. Toyota Genuine SLLC is used. The maintenance interval is as shown in the table below:

Engine Coolant Type		Toyota Genuine Super Long Life Coolant (SLLC) or similar high quality ethylene glycol based non-silicate, non-amine, non-nitrite and non-borate coolant with long-life hybrid organic acid technology (coolant with long-life hybrid organic acid technology is a combination of low phosphates and organic acids). Do not use plain water alone.
Maintenance Intervals	First Time	160000 km (100000 miles)
	Subsequent	Every 80000 km (50000 miles)
Color		Pink

HINT:

SLLC is pre-mixed (50% coolant and 50% deionized water). Therefore, no dilution is needed when SLLC in the vehicle is added or replaced.

b. Thermostat

Thermostat Opening Temperature	80°C to 84°C (176°F to 183°F)
--------------------------------	-------------------------------

