

GX460 FRONT: ELECTRONIC SUSPENSION

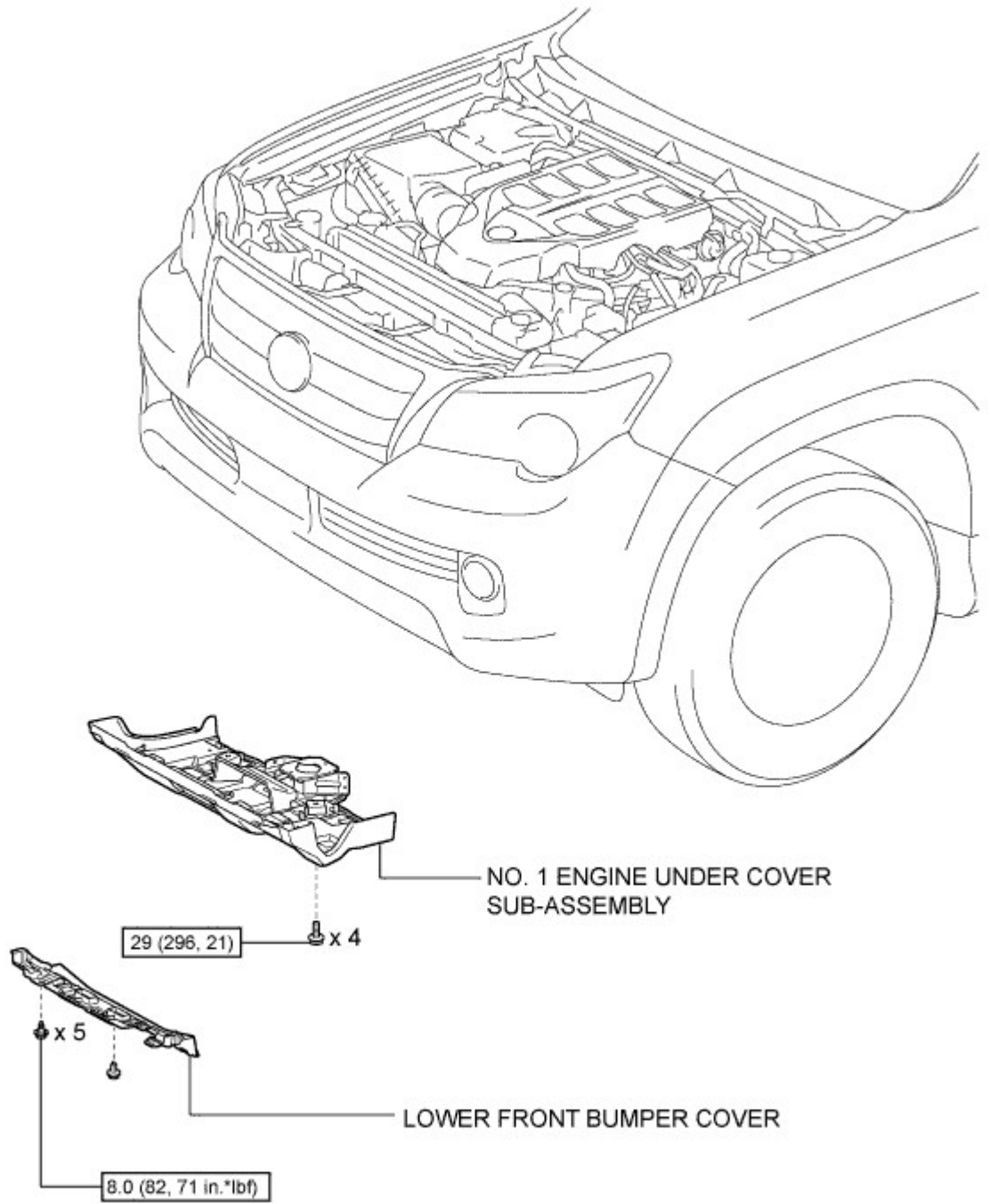

N*m (kgf*cm, ft.*lbf) : Specified torque

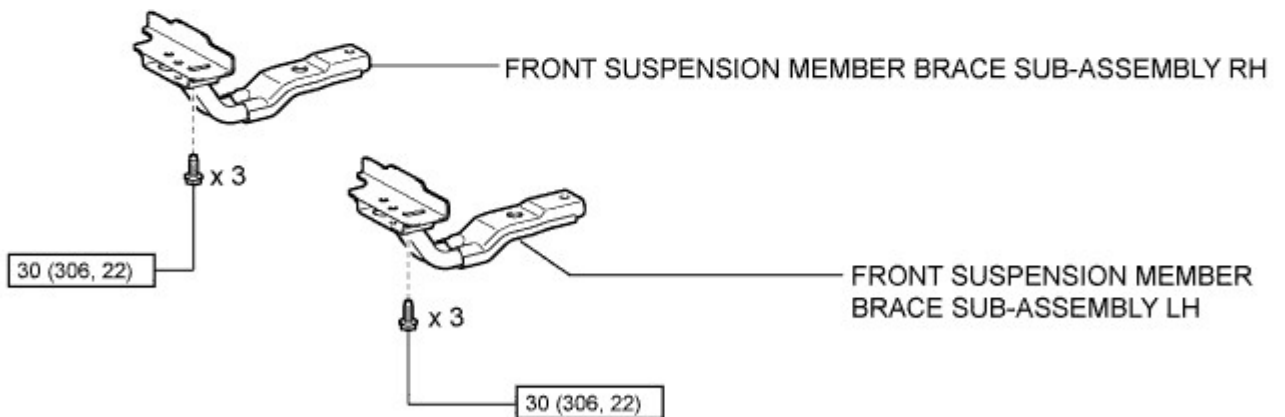
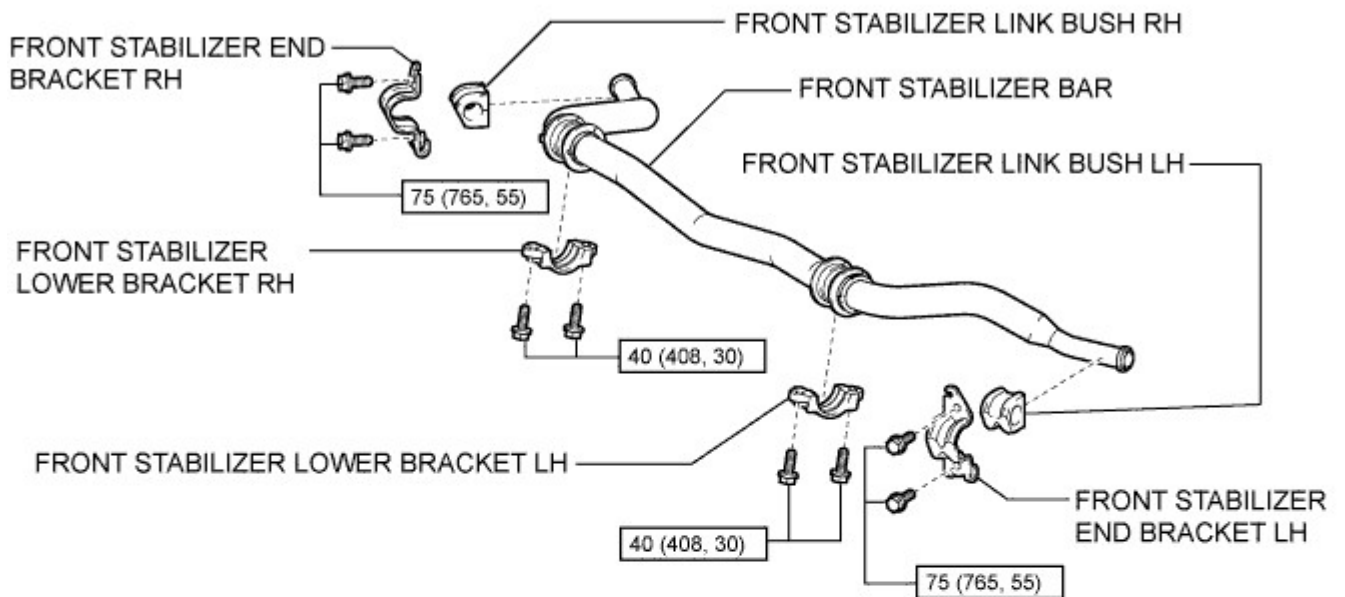

N*m (kgf*cm, ft.*lbf) : Specified torque

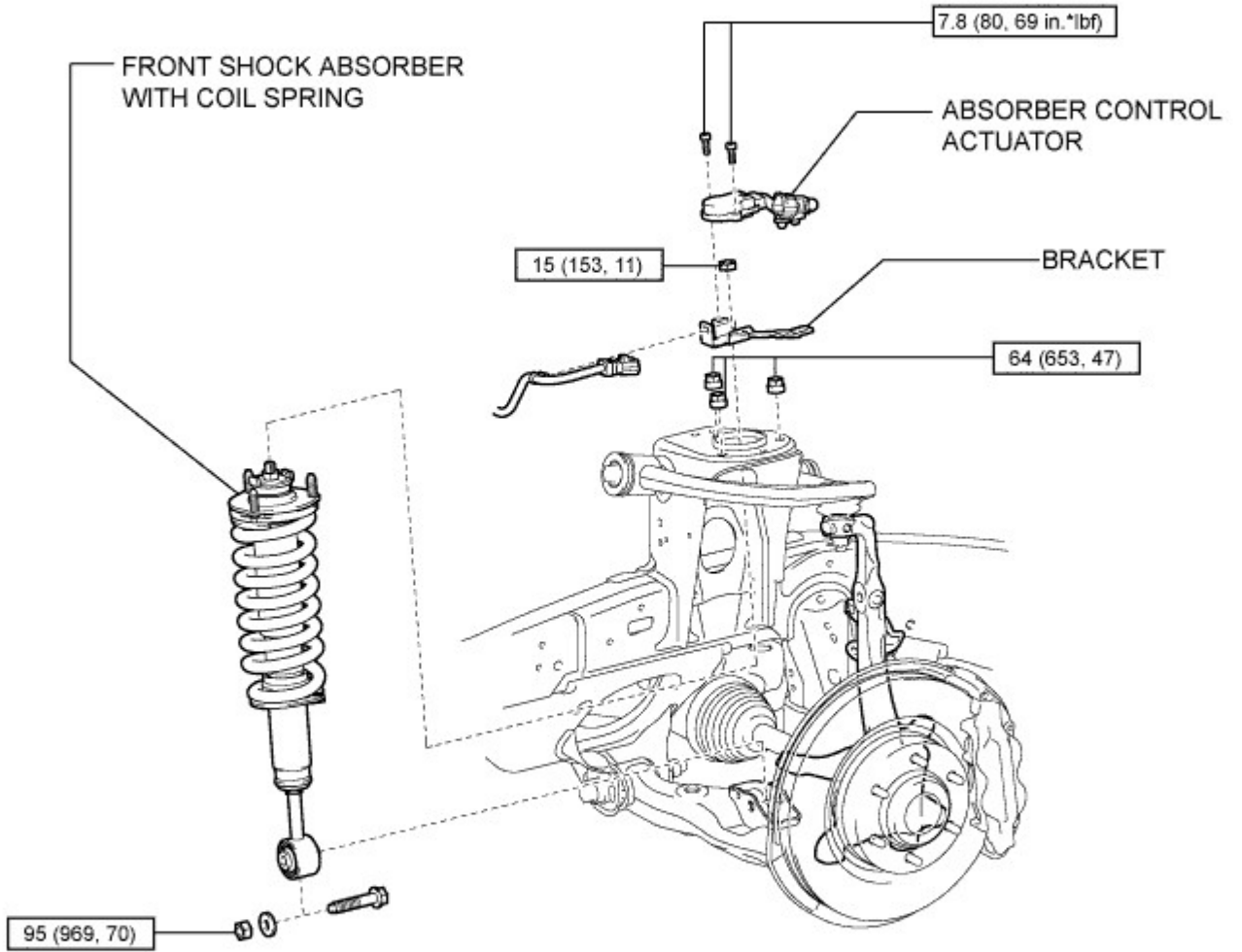

N*m (kgf*cm, ft.*lbf) : Specified torque

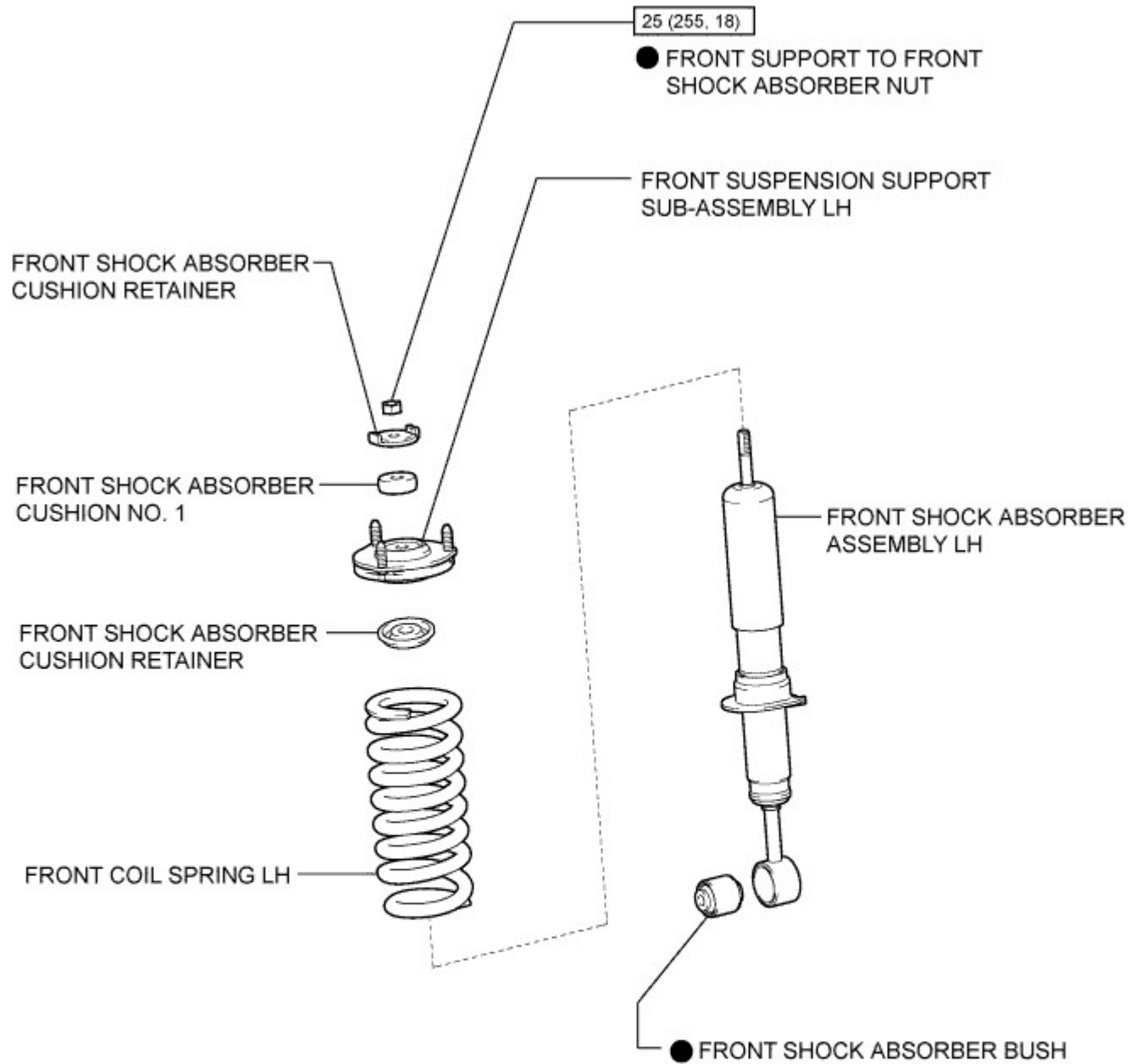

$\boxed{\text{N}\cdot\text{m (kgf}\cdot\text{cm, ft.}\cdot\text{lbf)}}$: Specified torque

● Non-reusable part

HINT:

- Use the same procedure for the RH and LH sides.
- The procedure listed below is for the LH side.

1. REMOVE FRONT WHEEL

2. REMOVE LOWER FRONT BUMPER COVER

- a. Remove the clip, 5 bolts and lower front bumper cover.

3. REMOVE NO. 1 ENGINE UNDER COVER SUB-ASSEMBLY

- a. Remove the 4 bolts.

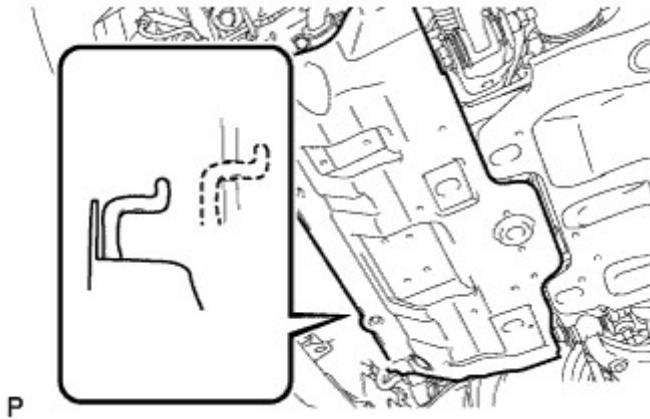

- b. Unhook the No. 1 engine under cover from the vehicle body as shown in the illustration.

4. REMOVE FRONT SUSPENSION MEMBER BRACE SUB-ASSEMBLY

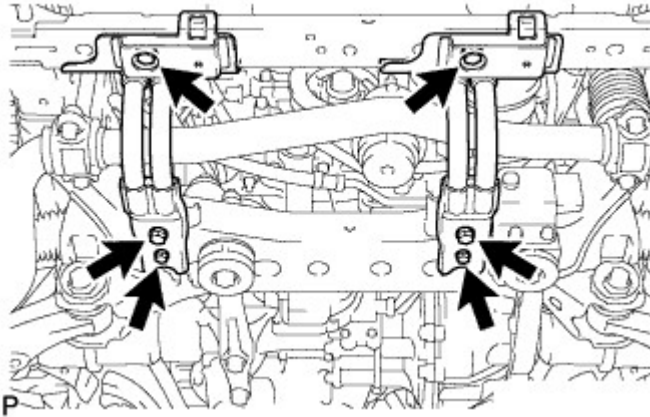

- a. Remove the 6 bolts and 2 member braces from the front frame assembly.

5. REMOVE FRONT STABILIZER END BRACKET

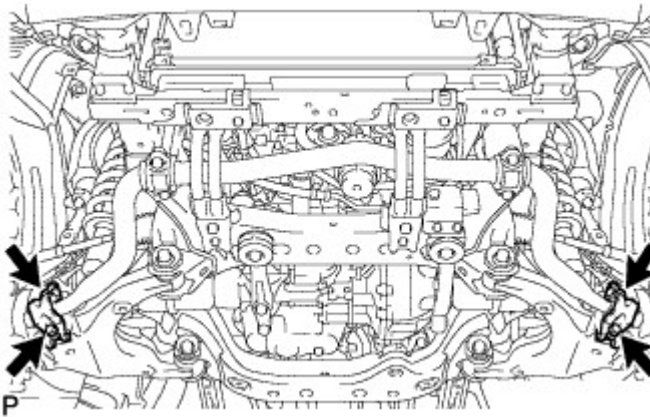

- a. Remove the 4 bolts and 2 brackets from the lower arm.

6. REMOVE FRONT STABILIZER BAR

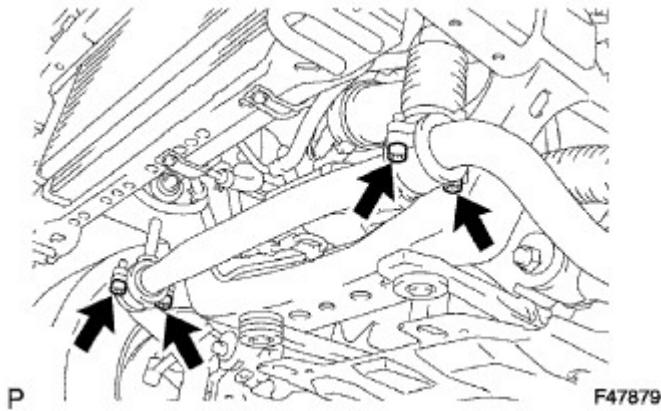

- a. Remove the 4 bolts, 2 front stabilizer lower brackets and front stabilizer bar.
- b. Remove the 2 front stabilizer link bushes and front stabilizer lower bracket bushes from the stabilizer bar front.

7. REMOVE FRONT SHOCK ABSORBER WITH COIL SPRING

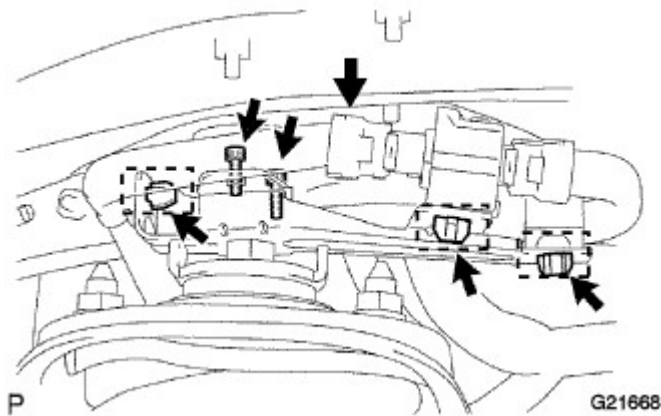

- a. Detach the 3 clamps and disconnect the connector.
- b. Using a 4 mm hexagon wrench, remove the 2 bolts and absorber control actuator.

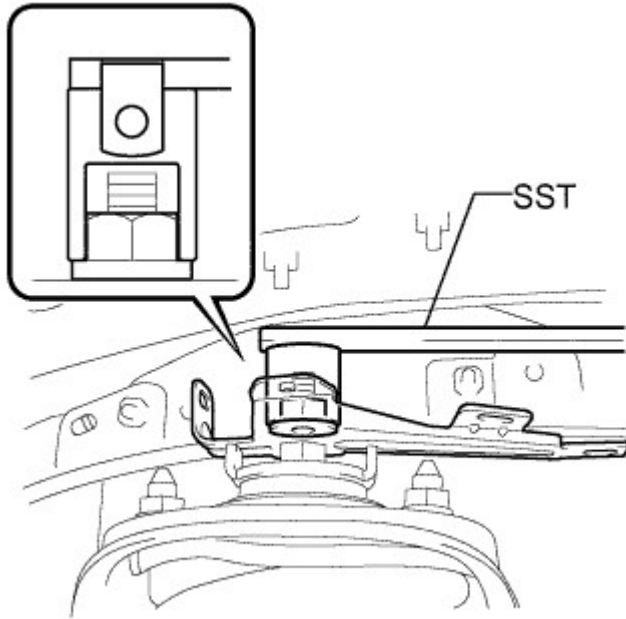

P

- c. Using SST, remove the nut and bracket.

SST
09961-00950

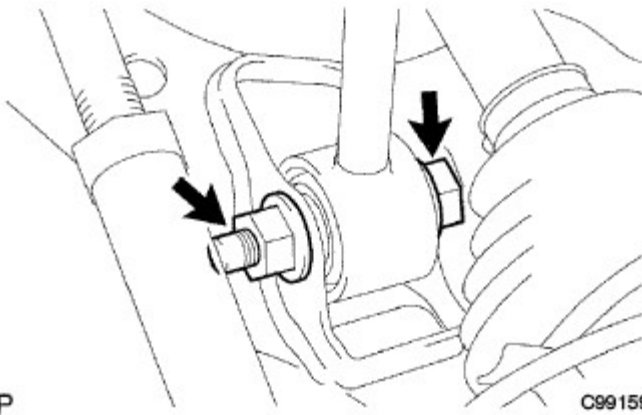

P

C99159

- d. Remove the bolt, nut and washer.

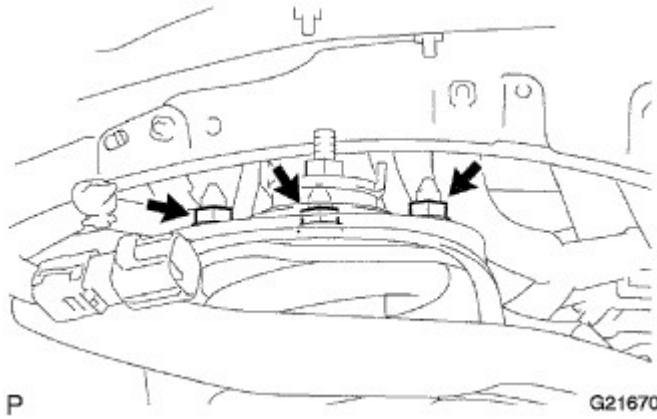

- e. Remove the 3 nuts on the top of the front shock absorber with coil spring.
- f. Remove the front shock absorber with coil spring.