

■ Recalling the memorized position

Vehicles with an automatic transmission: Check that the shift lever is set in P.

Vehicles with a manual transmission: Check that the parking brake is set.

STEP 1 Switch to IG-ON mode.



Push button 1, 2 or 3 to recall the desired position.

1



Before driving

Linking driving position memory with door unlock operation

Record your driving position to button 1, 2 or 3 before performing the following.

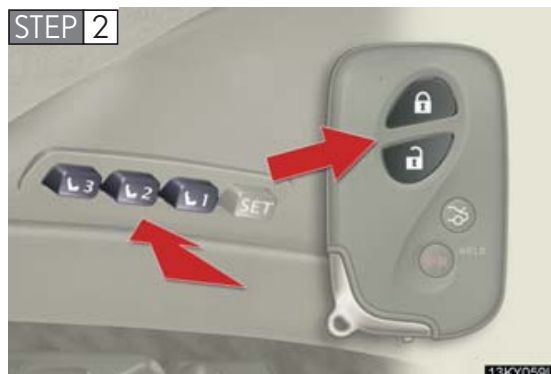
STEP 1 Turn the engine switch OFF and close the driver's door.





Press and hold the desired button (1, 2 or 3) while pressing the  or  button on the wireless remote control until the signal beeps.

The driving position is recalled when the driver's door is unlocked using the entry function or wireless remote control and the driver's door is opened.

■ Canceling the linked door unlock operation

STEP 1 Turn the engine switch OFF and close the driver's door.

STEP 2 While pushing the SET button, push the  or  button on the wireless remote control until the signal beeps.

■ Retained accessory power

Memorized positions (except for the steering wheel positions) can be activated up to 30 seconds after the driver's door is opened, even after turning the engine switch OFF.

■ To cancel seat position recall

Perform any of the following operations.

- Push the SET button.
- Push button 1, 2, or 3.
- Adjust the seat using the switches (only cancels seat position recall).

■ If the battery is disconnected

The memorized positions must be reset because the computer's memory is erased when the battery is disconnected.

CAUTION

■ Seat adjustment caution

Take care during seat adjustment that the seat does not strike the rear passenger or squeeze your body against the steering wheel.

1-3. Adjustable components

Seat position memory (if equipped)

1

Before driving

Your preferred front passenger seat position can be entered into the computer's memory and recalled with the touch of a button.

Three different seat positions can be entered into memory.

■ Entering a position to memory

Vehicles with an automatic transmission: Check that the shift lever is set in P.

Vehicles with a manual transmission: Check that the parking brake is set.

STEP 1 Switch to IG-ON mode.

STEP 2 Adjust the front passenger seat to the desired position.

STEP 3



While pushing the SET button, push button 1, 2 or 3 until the signal beeps.

If the selected button has already been preset, the previously recorded position will be overwritten.

■ Recalling the memorized position

Vehicles with an automatic transmission: Check that the shift lever is set in P.

Vehicles with a manual transmission: Check that the parking brake is set.



Push button 1, 2 or 3 to recall the desired position.