

Last Modified: 1-7-2009	5.1 A	From: 200708
Model Year: 2008	Model: IS250	Doc ID: RM000001PLO005X
Title: EXTERIOR: FRONT DOOR WINDOW FRAME MOULDING: REMOVAL (2008 IS250 IS350)		

REMOVAL

1. REMOVE FRONT DOOR INSIDE HANDLE BEZEL PLUG [INFO](#)
2. REMOVE POWER WINDOW REGULATOR MASTER SWITCH ASSEMBLY [INFO](#)
3. REMOVE COURTESY LIGHT ASSEMBLY [INFO](#)
4. REMOVE FRONT DOOR TRIM BOARD SUB-ASSEMBLY [INFO](#)
5. REMOVE FRONT DOOR INNER GLASS WEATHERSTRIP [INFO](#)
6. REMOVE FRONT DOOR FRAME COVER [INFO](#)
7. REMOVE FRONT DOOR BELT MOULDING ASSEMBLY [INFO](#)
8. REMOVE FRONT DOOR TRIM COVER [INFO](#)
9. REMOVE DOOR FRAME GARNISH [INFO](#)
10. REMOVE FRONT DOOR WEATHERSTRIP [INFO](#)
11. REMOVE FRONT DOOR REAR WINDOW FRAME MOULDING

When installing the front door rear window frame moulding, heat the vehicle body and front door rear window frame moulding using a heat light.

Heating temperature:

ITEM	TEMPERATURE
Vehicle Body	40 to 60°C (104 to 140°F)
Moulding	20 to 30°C (68 to 86°F)

Do not heat the vehicle body and moulding excessively.

- (a) Fully open the front door glass.
- (b) Using a heat light, heat the front door rear window frame moulding.

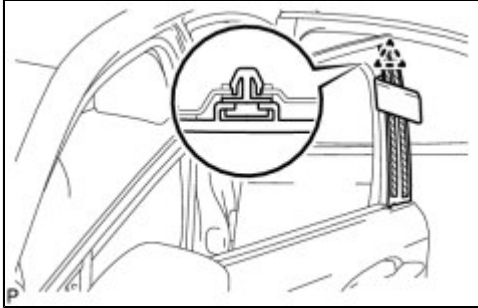

(c) Using a moulding remover, remove the clip and front door rear window frame moulding.

12. REMOVE FRONT DOOR UPPER WINDOW FRAME MOULDING

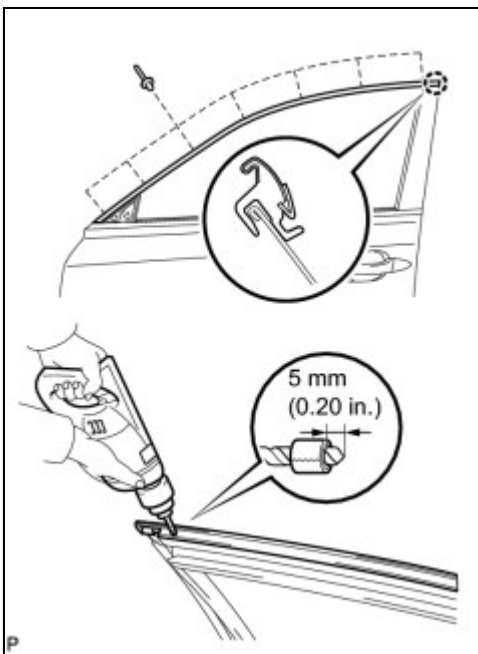

(a) Put a 4 mm (0.16 in.) drill bit into a drill.

(b) Tape the 4 mm (0.16 in.) drill bit without the portion of 5 mm (0.20 in.) from the tip covered.

Tape the 4 mm (0.16 in.) drill bit to prevent the drill bit from going too deep.

(c) Lightly press the drill against the rivets, drill off the flanges of the rivets, and remove the 7 rivets.

NOTICE:

- Pressing the drill too firmly will cause the rivet to turn and result in the rivet not being drilled through.
- Do not pry the rivets with the drill, because this may cause damage to the installation holes of the rivets or the drill bit.
- Be careful of the drilled rivets as they may become hot.

(d) Using a vacuum cleaner, remove the rivet fragments and shavings from the drilled areas.

(e) Remove the front door upper window frame moulding from the door frame.

