

2007 Lexus IS 250 RWD V6-2.5L (4GR-FSE)

[Vehicle Level](#) → [Body and Frame](#) → [Bumper](#) → [Front Bumper](#) → [Service and Repair](#) → [Removal and Replacement](#)

Removal and Replacement

FRONT BUMPER

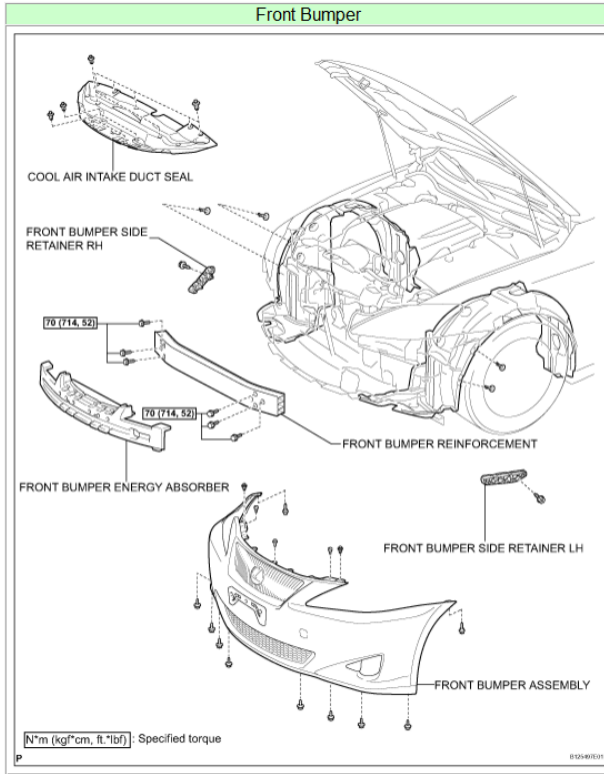

Zoom

Sized for Print

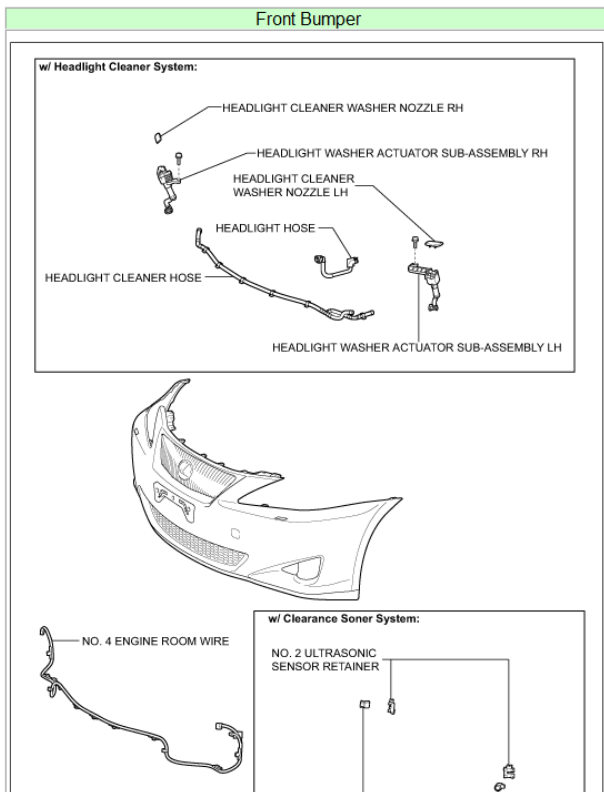

Zoom

Sized for Print

Front Bumper

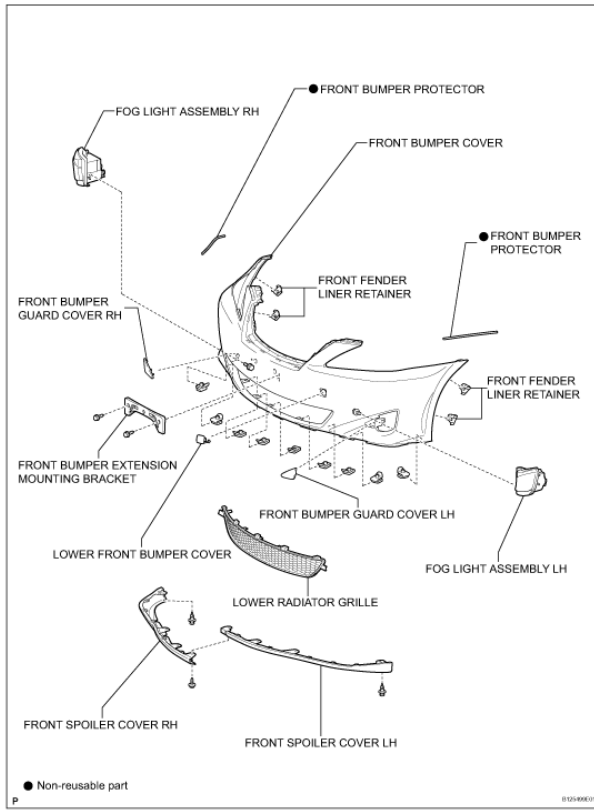

Zoom

Sized for Print

Front Bumper

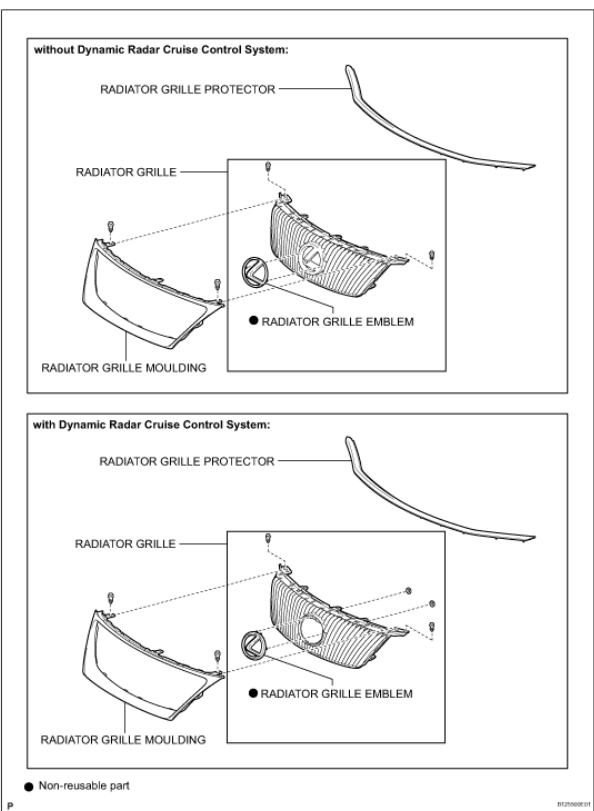

Zoom

Sized for Print

Zoom

Sized for Print

REMOVAL

1. DISCONNECT CABLE FROM NEGATIVE BATTERY TERMINAL
2. REMOVE COOL AIR INTAKE DUCT SEAL

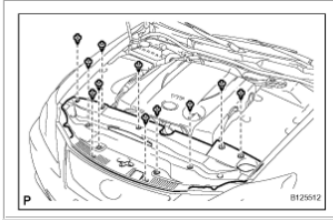

Zoom

Sized for Print

- a. Using a clip remover, remove the 11 clips and cool air intake duct seal.

3. REMOVE FRONT BUMPER ASSEMBLY

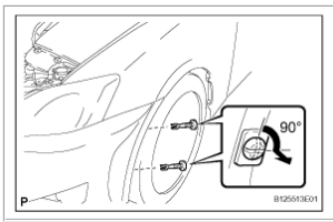

Zoom

Sized for Print

- a. Using a screwdriver, turn the pin **90 degrees** and remove the 2 pin hold clips. **HINT:**

- Tape the screwdriver tip before use.
- Use the same procedures for the RH side and LH side.

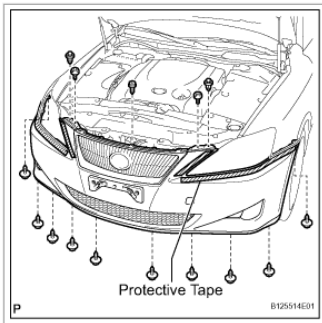

Zoom

Sized for Print

- b. Put protective tape around the front bumper assembly.
- c. Using a clip remover, remove the 2 clips.
- d. Remove the 2 radiator grille protectors.
- e. Remove the bolt and 10 screws.

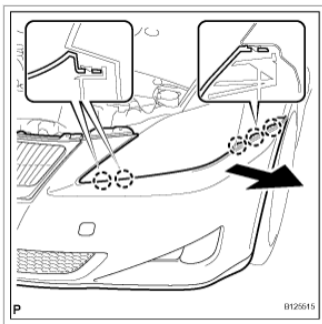

Zoom

Sized for Print

- f. Disengage the 5 claws and disconnect the front bumper assembly as shown in the illustration. **HINT:** Use the same procedures for the RH side and LH side.
- g. Disconnect the headlight washer hose. (w/ headlight cleaner system)
- h. Disconnect the connector and remove the front bumper assembly.

INSTALLATION

1. INSTALL FRONT BUMPER ASSEMBLY
2. INSTALL COOL AIR INTAKE DUCT SEAL
3. CONNECT CABLE TO NEGATIVE BATTERY TERMINAL
4. VEHICLE PREPARATION FOR FOG LIGHT AIM
5. PREPARATION FOR FOG LIGHT AIMING
6. FOG LIGHT AIMING INSPECTION
7. FOG LIGHT AIMING ADJUSTMENT
8. PERFORM INITIALIZATION Some systems need initialization after reconnecting the cable to the negative battery terminal.