



Technical Service Information Bulletin

September 14, 2005

Title:

FRONT LICENSE PLATE MOUNTING BRACKET AND LICENSE PLATE INSTALLATION

Models:

'06 IS 250 & IS 350

PD039-05

PRE-DELIVERY SERVICE

Introduction The front license plate mounting bracket and two self-tapping screws for the 2006 model year IS 250 and IS 350 are placed in the luggage compartment of the vehicle at the assembly plant. For states that require a front license plate, install the bracket and bolts on the bumper cover during Pre-Delivery Service (PDS) according to the following procedures.

Applicable Vehicles

- 2006 model year **IS 250** and **IS 350** vehicles.

Warranty Information

OP CODE	DESCRIPTION	TIME	OFF	T1	T2
N/A	Not Applicable to Warranty	-	-	-	-

Installation Procedure

1. Align holes "A" of the mounting bracket with the dimples on the front bumper cover. Mark the location of holes "B" on the front bumper cover.

NOTE:

- Holes "A" are used to install the mounting bracket to the bumper cover.
- Holes "B" are used for installation of the front license plate to the mounting bracket.

2. Drill two relief holes with a diameter of 11 mm (0.43 in.) at the marks on the front bumper cover (holes "B" location) to prevent the license plate retaining bolt ends from contacting the cover.

NOTE:

Do NOT drill into the dimples on the front bumper cover.

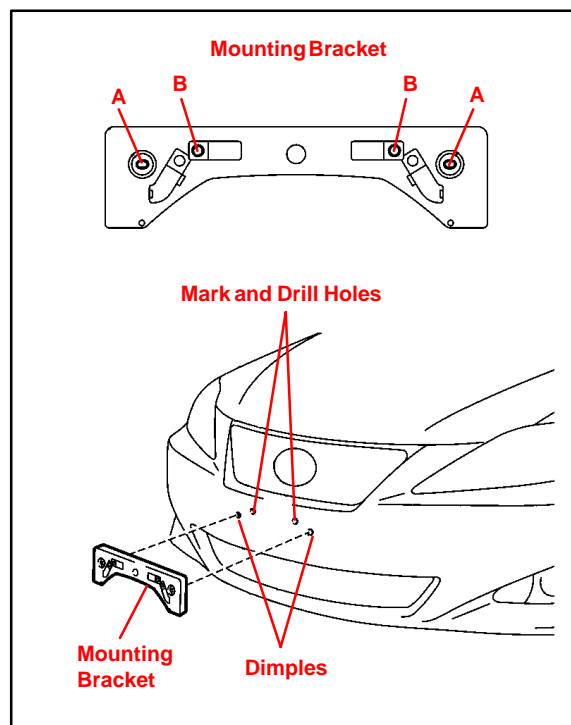

**Installation
Procedure**
(Continued)

3. Install the mounting bracket to the front bumper cover at holes “A” using the two supplied self-tapping screws.

NOTE:

Tighten the driver’s side screw first and then tighten the passenger’s side.

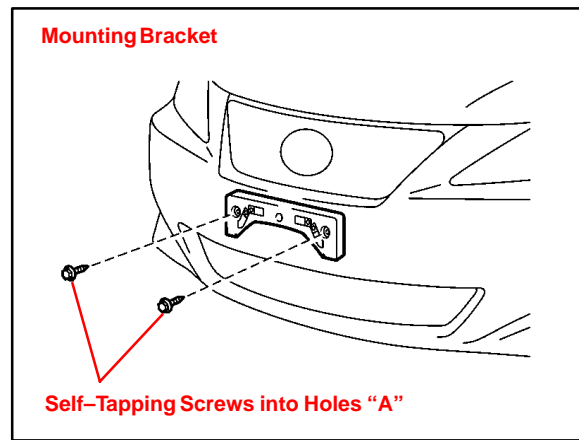

4. Install the front license plate to the mounting bracket at holes “B” using two bolts of the size listed below.

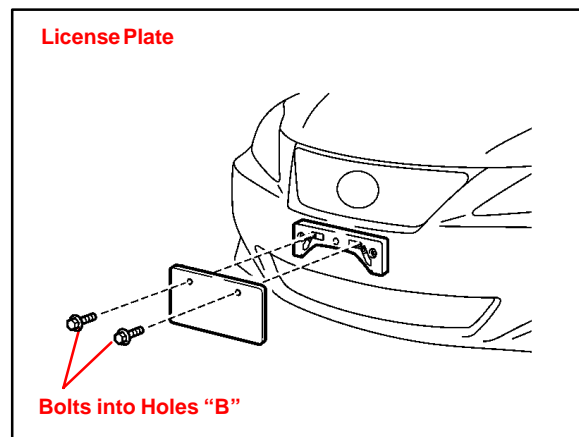

Use bolts of a non-corroding type with the following dimensions to install the front license plate:

Nominal Length: 15.0 mm (0.59 in.)

Diameter: 6.0 mm (0.24 in.)

