

Last Modified: 09-03-2021	6.10:8.0.50	Doc ID: RM1000000006IJB
Model Year Start: 2014	Model: IS250	Prod Date Range: [04/2013 -]
Title: DRIVE SHAFT / PROPELLER SHAFT: FRONT DRIVE SHAFT ASSEMBLY (for AWD): DISASSEMBLY; 2014 - 2022 MY IS250 IS300 IS350 [04/2013 -]		

DISASSEMBLY

CAUTION / NOTICE / HINT

NOTICE:

- When using a vise, place aluminum plates between the part and vise.
- When using a vise, do not overtighten it.

PROCEDURE

1. SEPARATE FRONT NO. 2 AXLE INBOARD JOINT BOOT CLAMP

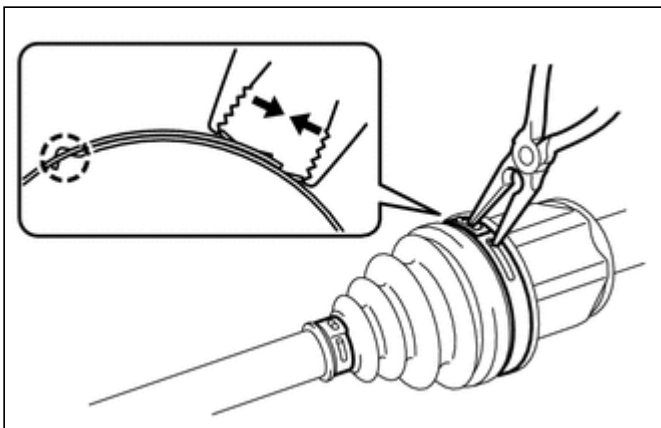

- (a) Using needle-nose pliers, disengage the claw and separate the front No. 2 axle inboard joint boot clamp as shown in the illustration.

2. SEPARATE FRONT AXLE INBOARD JOINT BOOT CLAMP

HINT:

Perform the same procedure as for the front No. 2 axle inboard joint boot clamp.

3. SEPARATE FRONT AXLE INBOARD JOINT BOOT

- (a) Separate the front axle inboard joint boot from the front drive inboard joint assembly.

4. REMOVE FRONT DRIVE INBOARD JOINT ASSEMBLY

- (a) Remove the old grease from the front drive inboard joint assembly.

- (b) Put matchmarks on the front drive inboard joint assembly and front drive outboard joint shaft assembly.

NOTICE:

Do not use a punch for the marks.

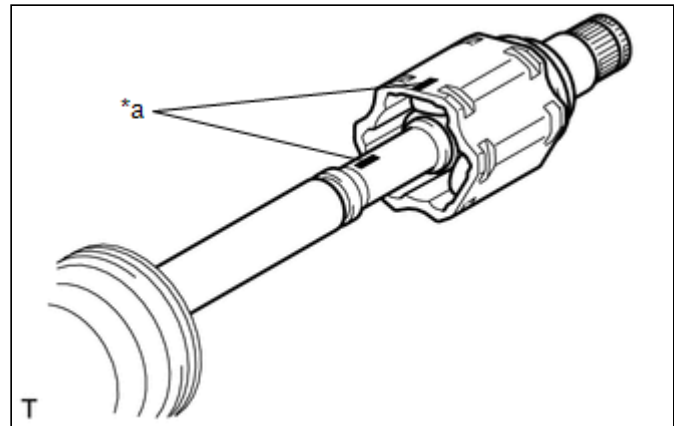

*a	Matchmark
----	-----------

(c) Remove the front drive inboard joint assembly from the front drive outboard joint shaft assembly.

(d) Using a snap ring expander, remove the front drive inner shaft inner shaft snap ring from the front drive outboard joint shaft assembly.

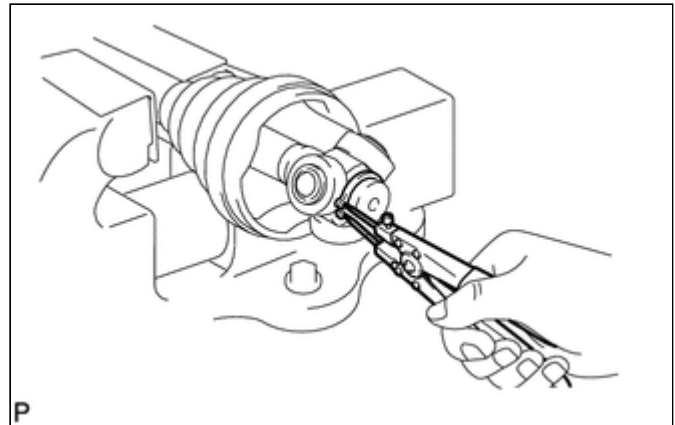

(e) Put matchmarks on the front drive outboard joint shaft assembly and tripod joint.

NOTICE:

Do not use a punch for the marks.

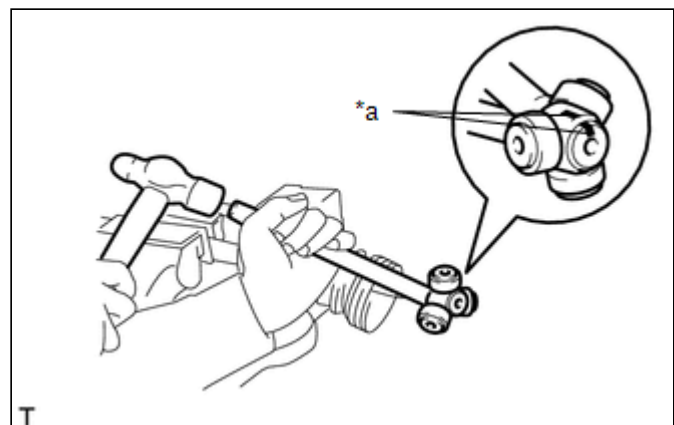

*a	Matchmark
----	-----------

(f) Using a brass bar and a hammer, tap out the tripod joint from the front drive outboard joint shaft assembly.

NOTICE:

- Do not tap the rollers.

- Do not drop the tripod joint.

5. REMOVE FRONT AXLE INBOARD JOINT BOOT

- (a) Remove the front No. 2 axle inboard joint boot clamp, front axle inboard joint boot and front axle inboard joint boot clamp.

6. SEPARATE FRONT NO. 2 AXLE OUTBOARD JOINT BOOT CLAMP

- (a) Using pliers, separate the front No. 2 axle outboard joint boot clamp.

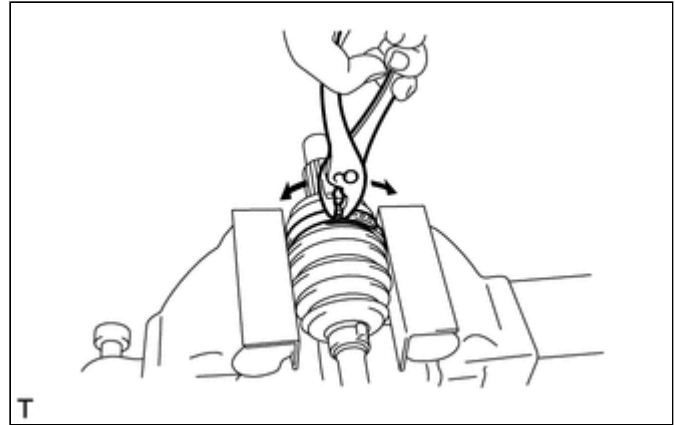

7. SEPARATE FRONT AXLE OUTBOARD JOINT BOOT CLAMP

HINT:

Perform the same procedure as for the front No. 2 axle outboard joint boot clamp.

8. REMOVE FRONT AXLE OUTBOARD JOINT BOOT

- (a) Remove the front axle outboard joint boot clamp, front axle outboard joint boot and front No. 2 axle outboard joint boot clamp from the front drive outboard joint shaft assembly.
- (b) Remove the old grease from the outboard joint.

9. REMOVE FRONT DRIVE SHAFT DUST COVER LH

- (a) Using SST and a press, remove the front drive shaft dust cover LH.

SST: 09950-00020

NOTICE:

- Be careful not to drop the front drive inboard joint assembly.
- Do not overtighten SST.

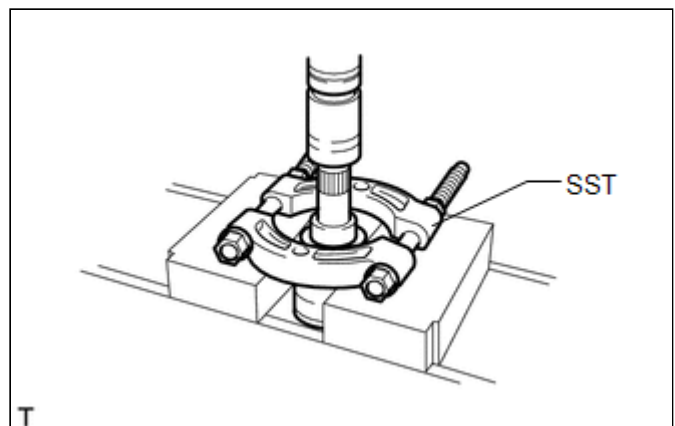

10. REMOVE FRONT DRIVE SHAFT BEARING (for RH Side)

- (a) Using a snap ring expander, remove the front drive shaft hole snap ring RH.

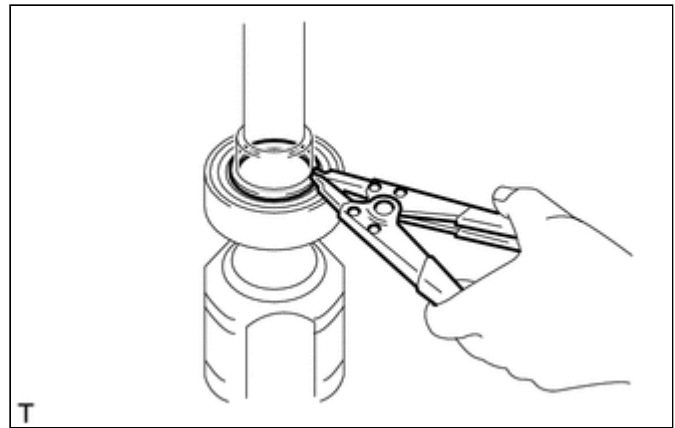

(b) Using SST and a press, remove the front drive shaft bearing.

SST: 09527-10011

NOTICE:

Be careful not to drop the front drive inboard joint assembly.

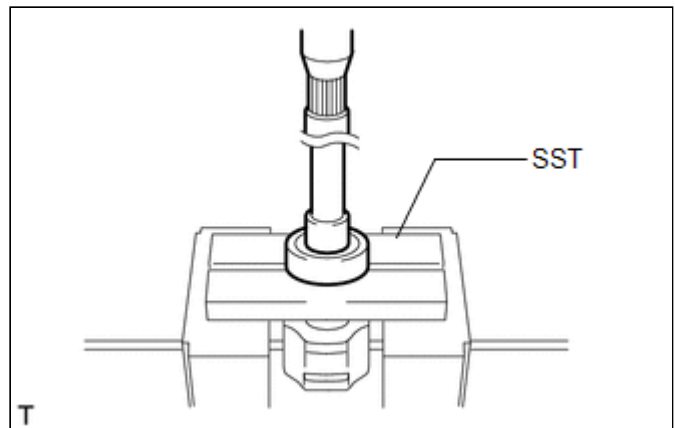

11. REMOVE FRONT NO. 1 WHEEL BEARING DUST DEFLECTOR

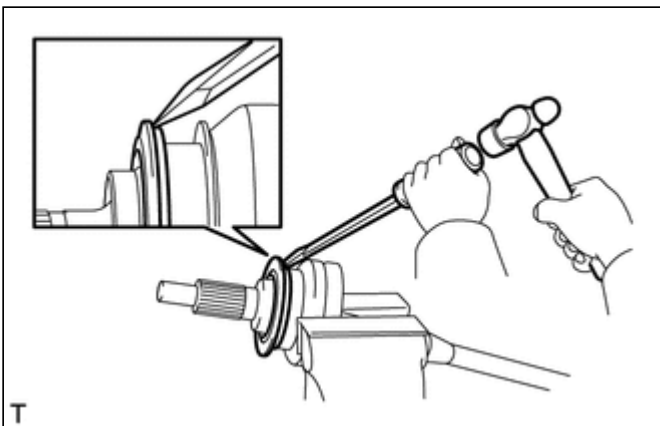

(a) Using a screwdriver and hammer, remove the front No. 1 wheel bearing dust deflector.

