

# ELECTRONIC MODULATED AIR SUSPENSION INSPECTION

SA21Y-01

## 1. OPERATE HEIGHT CONTROL SWITCH AND CHECK CHANGE OF VEHICLE HEIGHT

- (a) Check the tires for the proper inflation pressure (See page SA-3).
- (b) Check the vehicle height (See page SA-5).
- (c) Start the engine and change the height control switch from the NORM position to the HIGH position. Check the time until the height adjustment is completed and the amount of change in the vehicle height.

### Adjustment time

From operation of height control switch to start of compressor.	Approx. 2 sec.
From start of compressor to completion of height adjustment.	20 – 40 sec.

**Amount of change in vehicle height:  
10 – 30 mm (0.39 – 1.18 in.)**

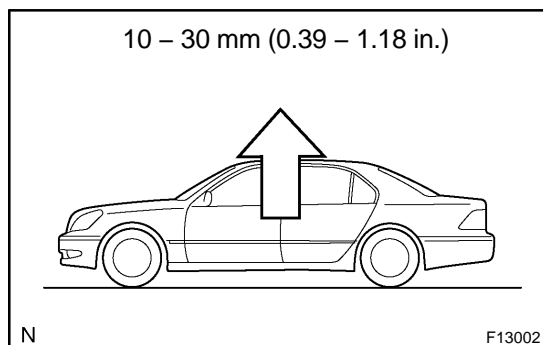

- (d) With the vehicle in the HIGH position height adjustment, start the engine and change the height control switch from the HIGH position to the NORM position. Check the time until the height adjustment is completed and the amount of change in the vehicle height.

### Adjustment time

From operation of height control switch to open of exhaust valve.	Approx. 2 sec.
From open of exhaust valve to completion of height adjustment.	20 – 40 sec.

**Amount of change in vehicle height:  
10 – 30 mm (0.39 – 1.18 in.)**

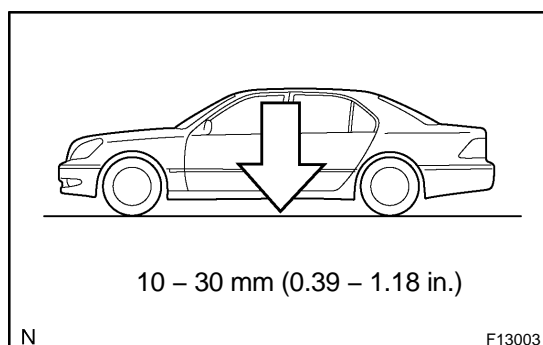

## 2. CHECK CONNECTIONS OF TUBES AND HOSES FOR AIR LEAKAGE

- (a) Set the height control switch in the HIGH position and raise the vehicle height.
- (b) Stop the engine.
- (c) Apply soapy water to the connections of the tubes and hoses and check if there is any air leakage.

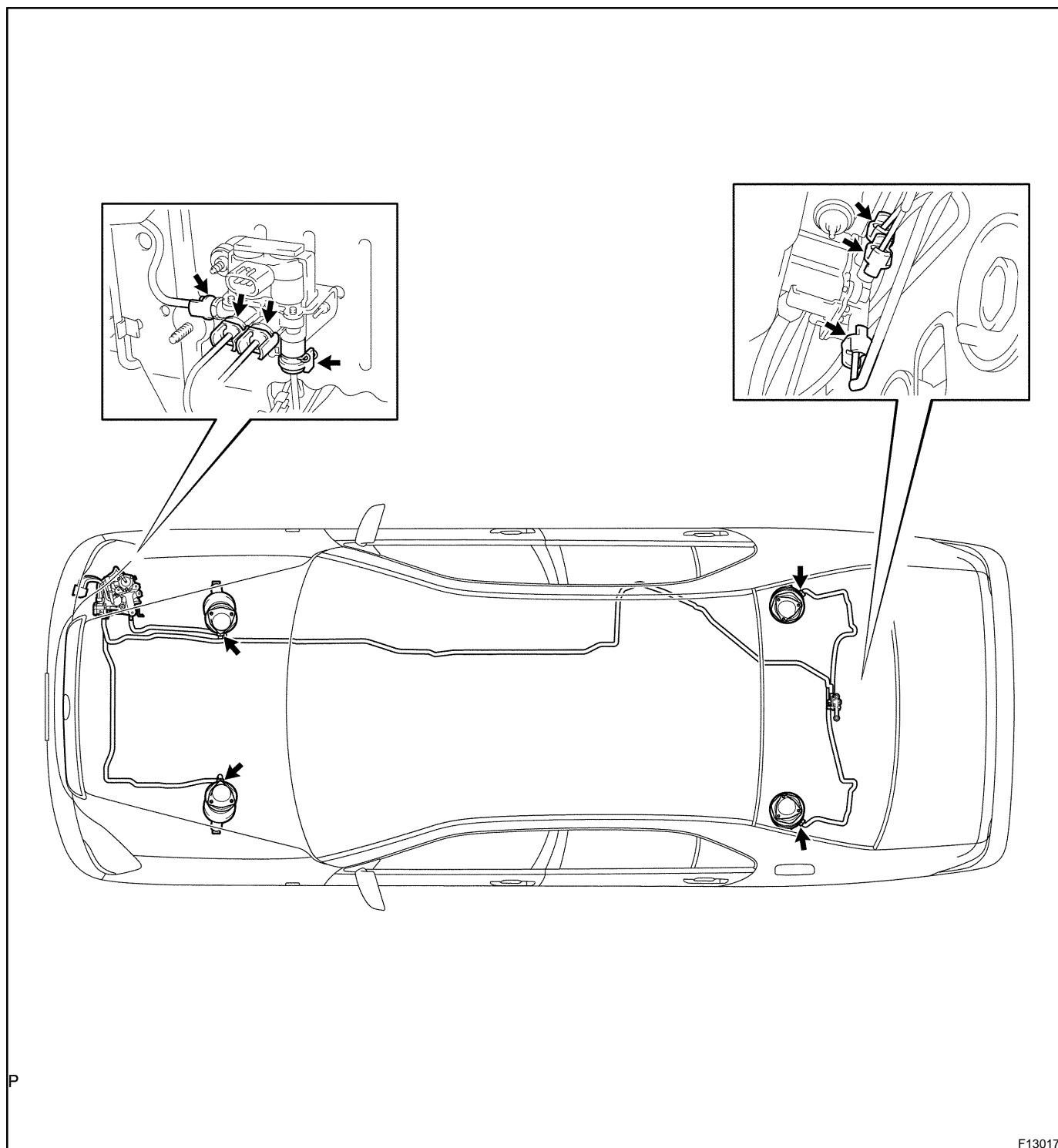

P

F13017