

Last Modified: 7-25-2017	6.8:8.0.51	Doc ID: RM000002LDE000X
Model Year Start: 2007	Model: LS460	Prod Date Range: [09/2006 -]
Title: INTERIOR: ROOF HEADLINING (for Standard Body): REMOVAL; 2007 MY LS460 [09/2006 -]		

REMOVAL

1. REMOVE COWL TOP VENTILATOR LOUVER RH INFO

2. REMOVE FRONT SEAT ASSEMBLY

(a) Remove the front seat INFO .

3. REMOVE REAR SEAT ASSEMBLY (for Fixed Type)

(a) Remove the rear seat INFO .

4. REMOVE REAR SEAT ASSEMBLY (for Power Seat)

(a) Remove the rear seat INFO .

5. REMOVE FRONT DOOR SCUFF PLATE LH

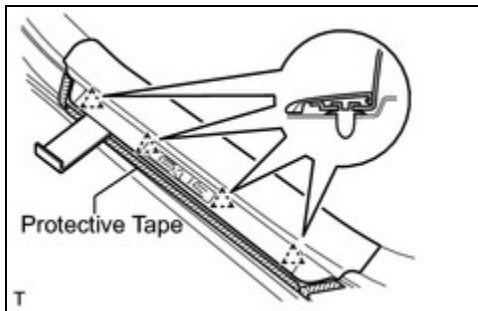

(a) Put protective tape around the front door scuff plate.

(b) Using a moulding remover, detach the 4 clips.

(c) Detach the 7 claws and remove the front door scuff plate LH.

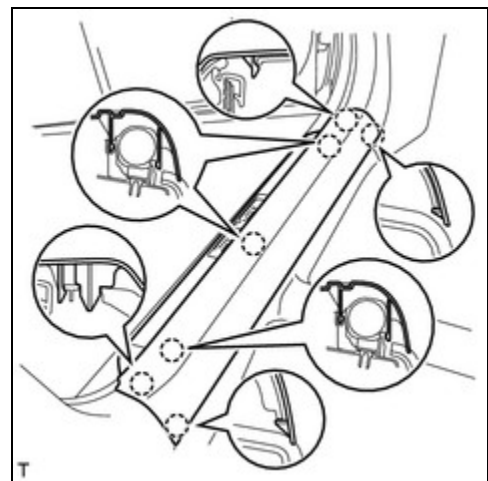

6. REMOVE FRONT DOOR SCUFF PLATE RH

HINT:

Use the same procedures described for the LH side.

7. REMOVE COWL SIDE TRIM BOARD LH

- (a) Detach the 3 claws and remove the cowl side trim board.

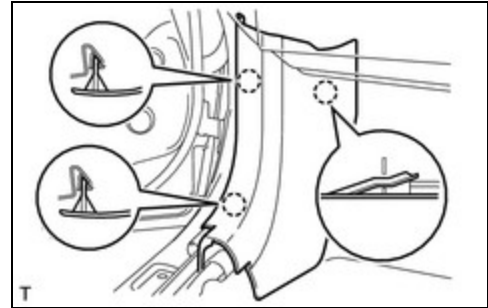

8. REMOVE COWL SIDE TRIM BOARD RH

HINT:

Use the same procedures described for the LH side.

9. REMOVE FRONT PILLAR GARNISH LH

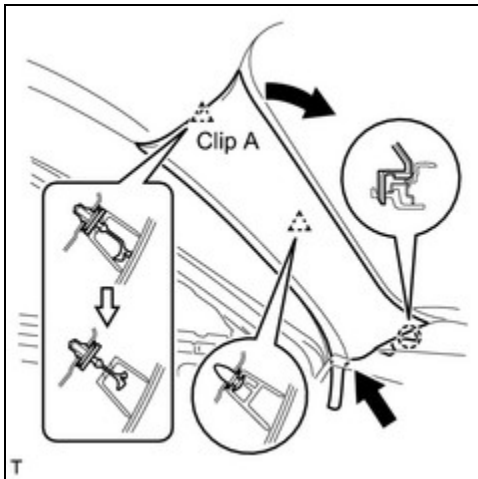

- (a) Detach the 2 clips from the vehicle body.
- (b) Cut off the clip A.
- (c) Detach the claw and remove the front pillar garnish.
- (d) Remove the clip A from the vehicle body.
- (e) Protect the curtain shield airbag assembly.
 - (1) Thoroughly cover the airbag with a cloth or nylon sheet and fix the ends of the cover with adhesive tape, as shown in the illustration.

NOTICE:

Cover the curtain shield airbag with a protective cover as soon as the front pillar garnish is removed.

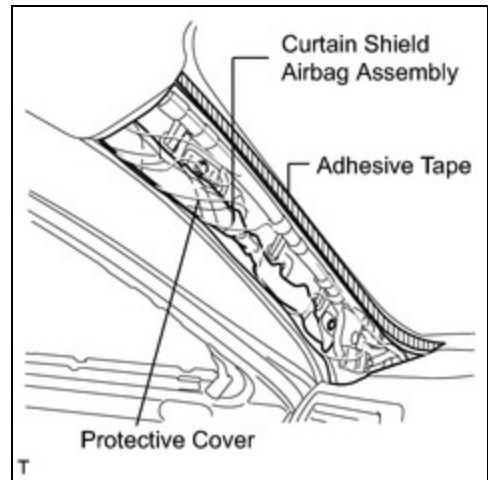

10. REMOVE FRONT PILLAR GARNISH RH

HINT:

Use the same procedures described for the LH side.

11. REMOVE REAR DOOR SCUFF PLATE LH

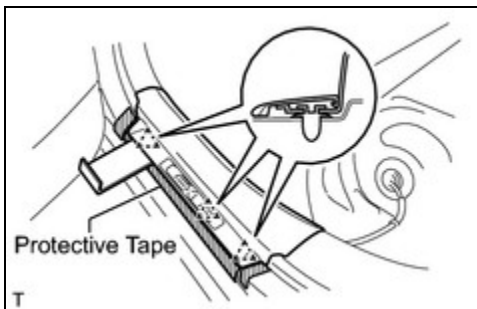

- (a) Put protective tape around the rear door scuff plate.
- (b) Using a moulding remover, detach the 3 clips.

- (c) Detach the 7 claws and remove the rear door scuff plate.

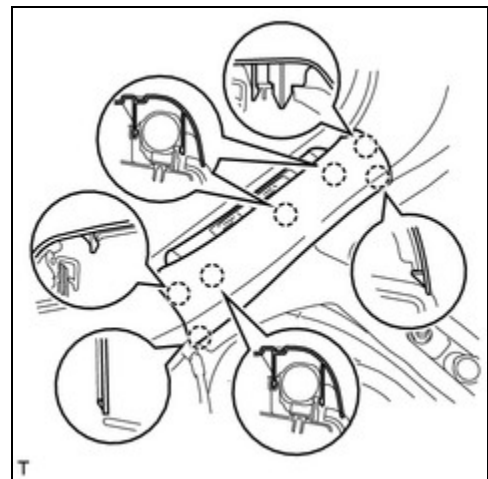

12. REMOVE REAR DOOR SCUFF PLATE RH

HINT:

Use the same procedures described for the LH side.

13. REMOVE CENTER PILLAR GARNISH LOWER LH

- (a) Detach the 2 claws and 6 clips, and remove the center pillar garnish lower.

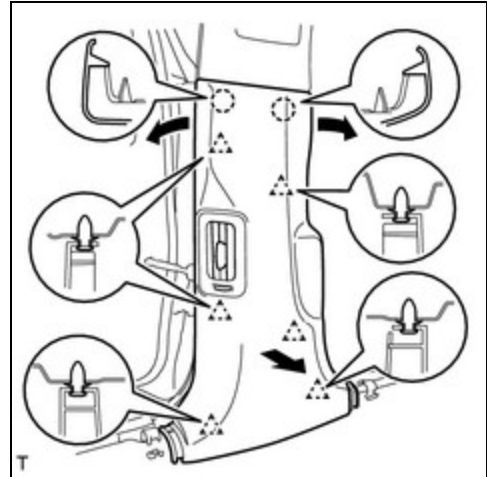

14. REMOVE CENTER PILLAR GARNISH LOWER RH

HINT:

Use the same procedures described for the LH side.

15. REMOVE CENTER PILLAR GARNISH UPPER LH

- (a) Remove the 2 screws.
- (b) Detach the claw.
- (c) Pass the front seat outer belt floor anchor through the center pillar garnish lower, and remove the center pillar garnish lower.

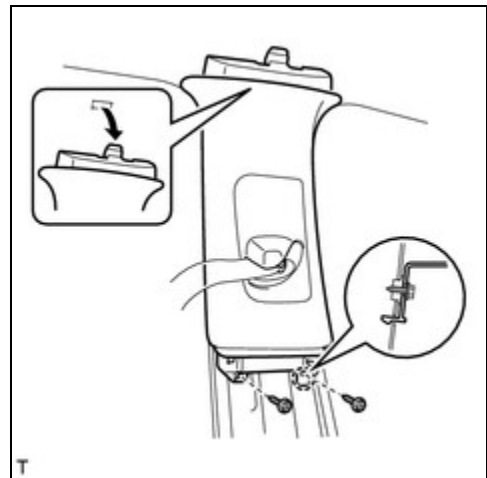

16. REMOVE CENTER PILLAR GARNISH UPPER RH

HINT:

Use the same procedures described for the LH side.

17. REMOVE SHOULDER BELT ANCHOR COVER LH

- (a) Detach the 6 claws of the cover, and slide the cover in the direction of the arrow to remove it.

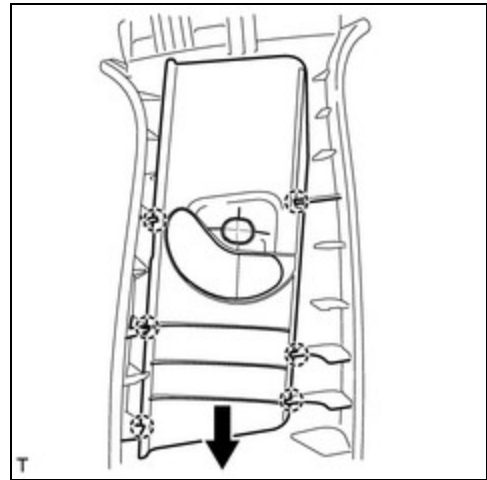

18. REMOVE SHOULDER BELT ANCHOR COVER RH

HINT:

Use the same procedures described for the LH side.

19. REMOVE REAR SEAT SIDE GARNISH LH

- (a) Detach the 6 claws and remove the rear seat side garnish.

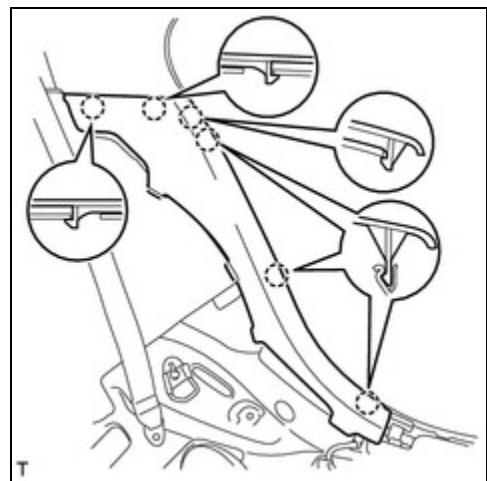

20. REMOVE REAR SEAT SIDE GARNISH RH

HINT:

Use the same procedures described for the LH side.

21. REMOVE ROOF SIDE GARNISH INNER LH

- (a) Pull the garnish away from the body and detach the 4 clips (do not detach clip A).
- (b) Detach the 2 claws of the guide, and remove the roof side garnish inner toward the front of the vehicle (in the direction of the arrow).

HINT:

Clip A remains attached to the body.

- (c) Remove clip A from the vehicle body.

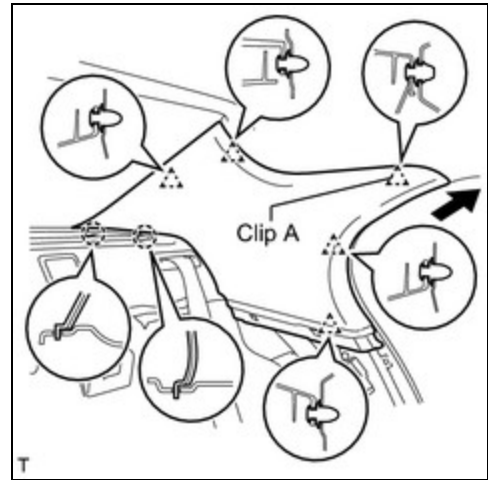

22. REMOVE ROOF SIDE GARNISH INNER RH

HINT:

Use the same procedures described for the LH side.

23. REMOVE MAP LIGHT ASSEMBLY

- (a) Using a screwdriver, detach the 2 claws and open the 2 covers.

HINT:

Tape the screwdriver tip before use.

- (b) Remove the 2 screws.
 (c) Using a moulding remover, detach the 2 clips.
 (d) Disconnect the 2 connectors and then remove the map light.

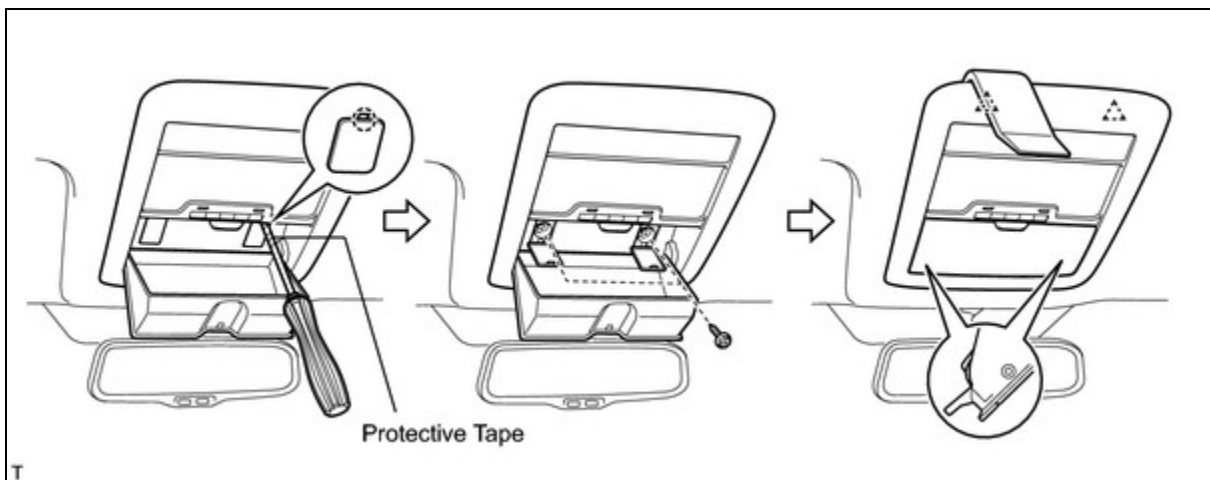

- (e) w/ Sliding Roof:

Disconnect the drive gear connector.

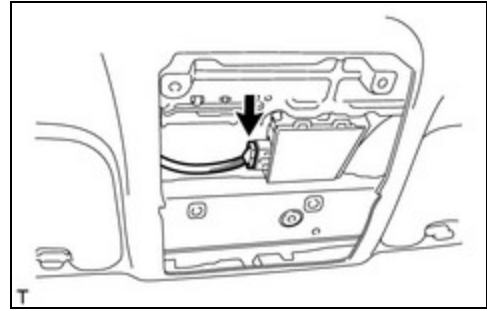

24. REMOVE SPOT LIGHT ASSEMBLY

- (a) Using a moulding remover, detach the 4 claws.
- (b) Disconnect the connector and then remove the spot light.

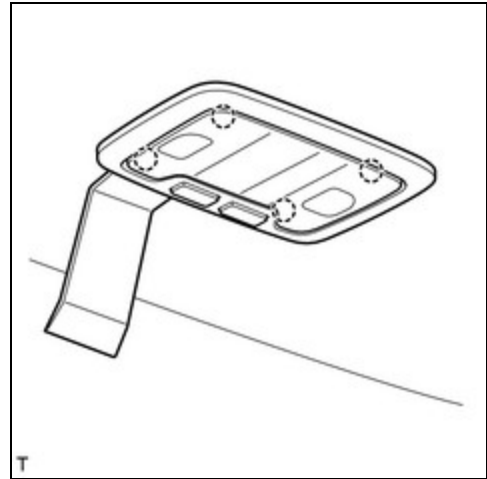

25. REMOVE REAR VANITY LIGHT ASSEMBLY

HINT:

Use the same procedures to remove the vanity light on the other side.

- (a) Using a screwdriver, detach the 4 claws and remove the lens.

HINT:

Tape the screwdriver tip before use.

- (b) Remove the 2 screws.
- (c) Using a moulding remover, detach the claw.
- (d) Disconnect the connector and then remove the vanity light.

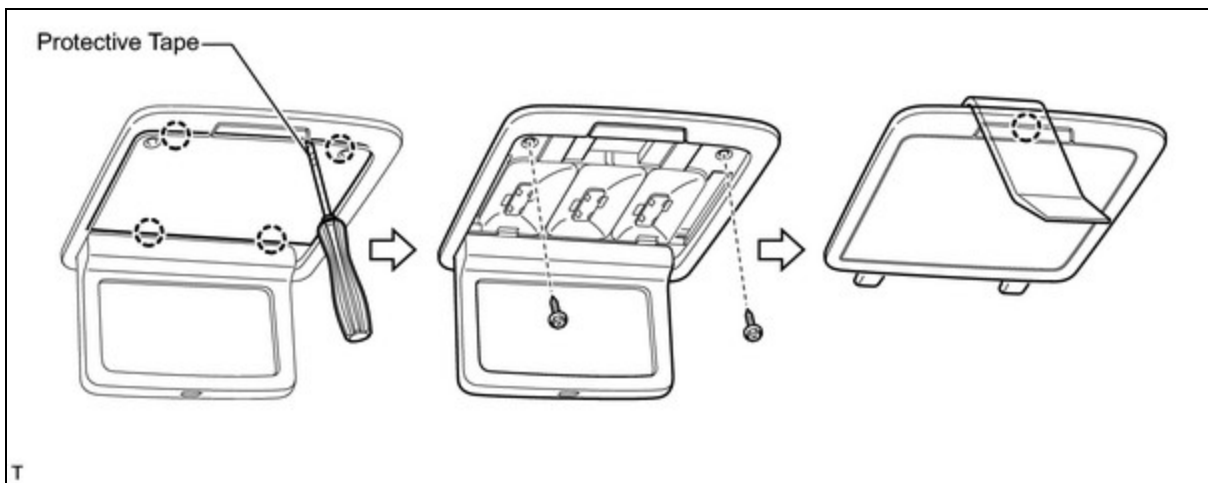

26. REMOVE COAT HOOK

HINT:

Use the same procedures to remove the hook on the other side.

- (a) Remove the screw and coat hook.

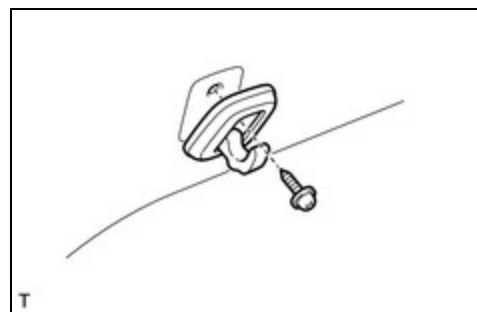

27. REMOVE ROOF SIDE REGISTER BEZEL LH (w/ Rear Cooler)

- (a) Remove the screw.
- (b) Detach the claw and remove the roof side register.

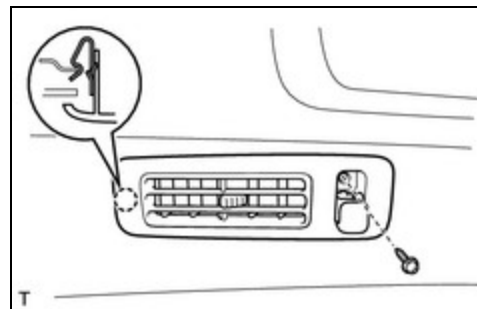

28. REMOVE ROOF SIDE REGISTER BEZEL RH (w/ Rear Cooler)

HINT:

Use the same procedures described for the LH side.

29. REMOVE ASSIST GRIP SUB-ASSEMBLY

HINT:

Use the same procedures for the other 3 assist grips.

- (a) Using a screwdriver, detach the 4 claws and remove the 2 assist grip covers.

HINT:

Tape the screwdriver tip before use.

- (b) Detach the 2 clips and remove the assist grip.

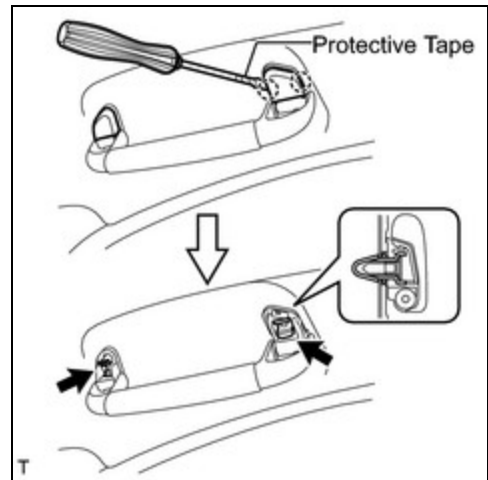

30. REMOVE VISOR BRACKET COVER

HINT:

Use the same procedures to remove the cover on the other side.

- (a) Using a moulding remover, detach the 4 claws and remove the visor bracket cover.

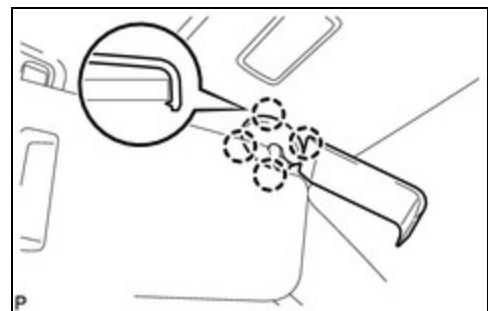

31. REMOVE VISOR ASSEMBLY LH

- (a) Remove the 2 screws and visor.

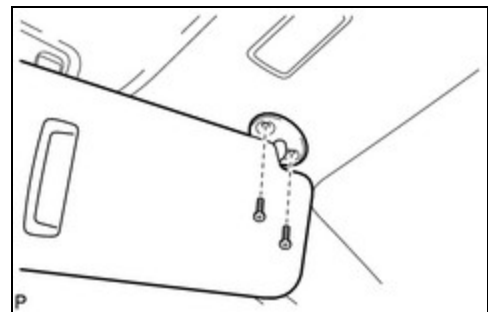

32. REMOVE VISOR ASSEMBLY RH

HINT:

Use the same procedures described for the LH side.

33. REMOVE VISOR HOLDER

HINT:

Use the same procedures to remove the holder on the other side.

- (a) Turn the visor holder approximately 45° and pull it out as shown in the illustration.
- (b) Detach the 2 claws and remove the visor holder.

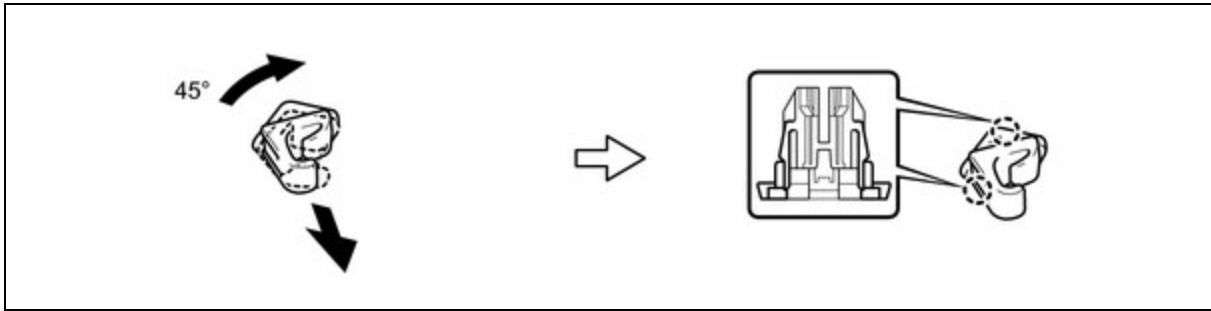

34. REMOVE FRONT WIPER ARM LH [INFO](#)

35. REMOVE FRONT WIPER ARM RH [INFO](#)

36. REMOVE FRONT FENDER TO COWL SIDE SEAL LH [INFO](#)

37. REMOVE FRONT FENDER TO COWL SIDE SEAL RH [INFO](#)

38. REMOVE HOOD TO COWL TOP SEAL [INFO](#)

39. REMOVE COWL TOP VENTILATOR LOUVER PROTECTOR LH [INFO](#)

40. REMOVE COWL TOP VENTILATOR LOUVER SUB-ASSEMBLY [INFO](#)

41. REMOVE ROOF DRIP SIDE FINISH MOULDING CENTER LH

(a) Remove the roof drip side finish moulding center [INFO](#) .

42. REMOVE ROOF DRIP SIDE FINISH MOULDING CENTER RH

(a) Remove the roof drip side finish moulding center [INFO](#) .

43. REMOVE INNER REAR VIEW MIRROR COVER (w/o Rain Sensor) [INFO](#)

44. REMOVE RAIN SENSOR COVER (w/ Rain Sensor) [INFO](#)

45. DISCONNECT RAIN SENSOR CONNECTOR (w/ Rain Sensor)

46. REMOVE INNER REAR VIEW MIRROR ASSEMBLY [INFO](#)

47. REMOVE WINDSHIELD OUTSIDE MOULDING UPPER [INFO](#)

48. REMOVE WINDSHIELD GLASS [INFO](#)

49. REMOVE NO. 2 WINDSHIELD GLASS STOPPER [INFO](#)

50. REMOVE WINDSHIELD GLASS RETAINER [INFO](#)

51. REMOVE WINDSHIELD GLASS ADHESIVE DAM [INFO](#)

52. REMOVE WINDSHIELD GLASS SEAL [INFO](#)

53. CLEAN WINDSHIELD GLASS [INFO](#)

54. REMOVE NO. 1 WINDSHIELD GLASS STOPPER [INFO](#)

55. CLEAN VEHICLE BODY [INFO](#)

56. REMOVE ROOF HEADLINING ASSEMBLY

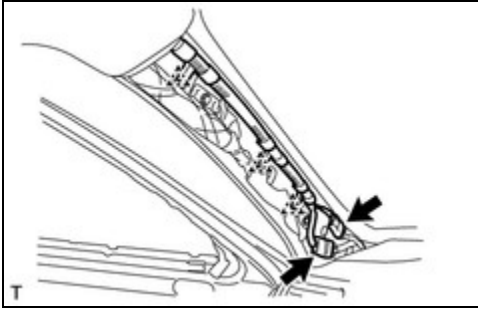

(a) Disconnect the roof wire connectors and detach each clamp from the front pillar.

(b) for Standard Type:

Detach the hook, 12 claws, 3 fasteners and 4 clips.

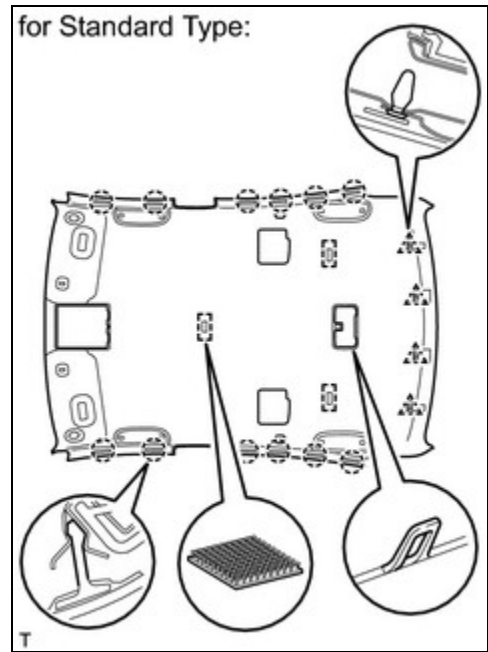

(c) w/ Sliding Roof:

Detach the hook, 12 claws, 10 fasteners and 4 clips.

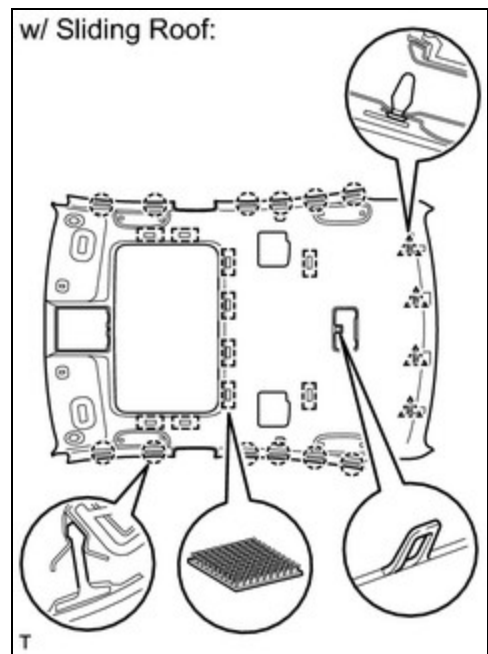

(d) Remove the roof headlining through the front of the vehicle.

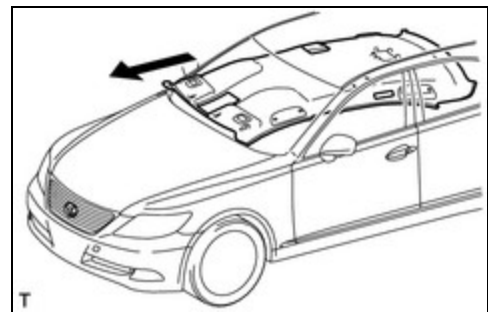

57. REMOVE FRONT DOOR OPENING TRIM WEATHERSTRIP LH

58. REMOVE FRONT DOOR OPENING TRIM WEATHERSTRIP RH

59. REMOVE REAR DOOR OPENING TRIM WEATHERSTRIP LH

60. REMOVE REAR DOOR OPENING TRIM WEATHERSTRIP RH

