



2008 Lexus LS600h L, 5.0L 32-valve 8-cylinder (2UR-FSE) engine, electric/gas

Lexus 2008 LS600H Repair Manual (RM05A0U)

< Hide

Lexus 2008 LS600H Repair Manual (RM05A0U)

**INTRODUCTION**

**INTRODUCTION**

**HOW TO USE THIS MANUAL**

GENERAL INFORMATION; 2008 MY LS600H [04/2007 - later]

**IDENTIFICATION INFORMATION**

**REPAIR INSTRUCTION**

HOW TO TROUBLESHOOT ECU CONTROLLED SYSTEMS

**TERMS**

FOREWORD / CAUTION / SECTION TOC

TOC2

TOC3

TOC4

TOC5

TOC6

TOC7

**PREPARATION**

**SERVICE SPECIFICATIONS**

**MAINTENANCE**

**ENGINE**

**HYBRID SYSTEM**

**DRIVE LINE**

**SUSPENSION & AXLE**

**AXLE**

**SUSPENSION CONTROL**

**SUSPENSION**

SUSPENSION SYSTEM

FRONT WHEEL ALIGNMENT

REAR WHEEL ALIGNMENT

FRONT SHOCK ABSORBER

FRONT SUSPENSION MEMBER

FRONT UPPER SUSPENSION ARM

FRONT LOWER SUSPENSION ARM

FRONT LOWER BALL JOINT

**SUSPENSION: REAR SUSPENSION MEMBER: REMOVAL; 2008 MY LS600H [04/2007 - later]**

**Notice:**

While the battery is connected, even if the power switch is OFF, the brake control system activates when the brake pedal is depressed or the door courtesy switch turns on. Therefore during servicing of the brake system components, do not operate the brake pedal or open/close the doors while the battery is connected.

**REMOVE REAR WHEEL**

**REMOVE LUGGAGE COMPARTMENT MAT SUB-ASSEMBLY ([info](#))**

**REMOVE TOOL BOX**

**REMOVE SPARE TIRE**

**REMOVE BATTERY SERVICE HOLE COVER LH ([info](#))**

**REMOVE BATTERY SERVICE HOLE COVER ([info](#))**

**DISCONNECT CABLE FROM NEGATIVE BATTERY TERMINAL**

**Warning:**

Wait at least 90 seconds after disconnecting the cable from the negative (-) battery terminal to prevent airbag and seat belt pretensioner activation.

FRONT STABILIZER BAR  
FRONT ACTIVE STABILIZER  
CONTROL ACTUATOR  
REAR SHOCK ABSORBER  
**REAR SUSPENSION MEMBER**  
COMPONENTS; 2008 MY LS600H  
[04/2007 - later]  
REMOVAL; 2008 MY LS600H  
[04/2007 - later]  
INSTALLATION; 2008 MY LS600H  
[04/2007 - later]  
REAR UPPER ARM  
REAR LOWER ARM  
TOE CONTROL LINK  
REAR STABILIZER BAR  
REAR ACTIVE STABILIZER  
CONTROL ACTUATOR  
TIRE AND WHEEL  
BRAKE  
STEERING  
HEATER & AIR CONDITIONING  
SYSTEM  
RESTRAINTS  
SECURITIES  
CRUISE CONTROL SYSTEM  
BODY ELECTRICAL  
BODY  
COMMUNICATION SYSTEM

**Notice:**

- Some systems need to be initialized after the cable is reconnected ( ([info](#)) ).
- After the power switch is turned OFF, the HDD navigation system requires approximately 6 minutes to record various types of memory and settings. As a result, after turning the power switch OFF, wait 6 minutes or more before disconnecting the cable from the negative (-) battery terminal.

REMOVE BATTERY ([info](#))

REMOVE BATTERY CARRIER ([info](#))

REMOVE SERVICE PLUG GRIP  
([info](#))

REMOVE ROPE HOOK ([info](#))

REMOVE ROPE HOOK ASSEMBLY  
([info](#))

REMOVE DECK TRIM SIDE BOARD  
RH ([info](#))

REMOVE NO. 1 LUGGAGE  
COMPARTMENT LIGHT  
ASSEMBLY ([info](#))

REMOVE NO. 1 COOLER COVER  
(w/ Rear Cooler) ([info](#))

REMOVE FRONT LUGGAGE  
COMPARTMENT TRIM COVER  
([info](#))

REMOVE REAR FLOOR FINISH  
PLATE ([info](#))

REMOVE LUGGAGE  
COMPARTMENT TRIM COVER  
ASSEMBLY LH ([info](#))

REMOVE SEAT VIBRATOR  
MODULE ASSEMBLY (for  
Ottoman) ([info](#))

DISCONNECT REAR ACTIVE  
STABILIZER CONTROL  
ACTUATOR CONNECTOR (w/  
Active Stabilizer) ([info](#))

REMOVE REAR ACTIVE  
STABILIZER CONTROL ECU (w/  
Active Stabilizer) ([info](#))

DISCONNECT ELECTRIC PARKING  
BRAKE ACTUATOR CONNECTOR  
([info](#))

REMOVE NO. 2 DIFFERENTIAL  
SUPPORT PROTECTOR ([info](#))

REMOVE NO. 1 DIFFERENTIAL  
SUPPORT PROTECTOR ([info](#))

REMOVE NO. 6 ROCKER PANEL  
MOULDING PROTECTOR ([info](#))

REMOVE NO. 5 ROCKER PANEL  
MOULDING PROTECTOR ([info](#))

REMOVE REAR FLOOR SIDE  
MEMBER COVER LH ([info](#))

REMOVE REAR FLOOR SIDE  
MEMBER COVER RH ([info](#))

REMOVE FRONT FLOOR COVER  
LH ([info](#))

REMOVE FRONT FLOOR COVER  
RH ([info](#))

REMOVE FRONT CENTER FLOOR  
BRACE ([info](#))

REMOVE FRONT CENTER FLOOR  
COVER ([info](#))

REMOVE EXHAUST PIPE AIR  
HOSE ([info](#))

REMOVE EXHAUST GAS  
TEMPERATURE SENSOR ([info](#))

REMOVE NO. 2 HEATED OXYGEN  
SENSOR (for Bank 2 Sensor 2)  
([info](#))

REMOVE FRONT EXHAUST PIPE  
ASSEMBLY ([info](#))

REMOVE HEATED OXYGEN  
SENSOR (for Bank 1 Sensor 2)  
([info](#))

REMOVE TAILPIPE LH ([info](#))

REMOVE TAILPIPE RH ([info](#))

REMOVE EXHAUST PIPE DAMPER  
([info](#))

REMOVE NO. 1 EXHAUST PIPE  
SUPPORT BRACKET SUB-  
ASSEMBLY ([info](#))

REMOVE FRONT FLOOR NO. 1  
HEAT INSULATOR ([info](#))

REMOVE PROPELLER SHAFT  
HEAT INSULATOR ([info](#))

REMOVE PROPELLER SHAFT  
WITH CENTER BEARING  
ASSEMBLY ([info](#))

REMOVE REAR WHEEL HOUSE  
LINER LH ([info](#))

DISCONNECT WIRE HARNESS  
CLAMP ([info](#))

REMOVE FLOOR NO. 1 UNDER  
COVER ([info](#))

DISCONNECT ELECTRIC PARKING  
BRAKE ACTUATOR CAP ([info](#))

REMOVE REAR DISC BRAKE  
CALIPER ASSEMBLY LH ([info](#))

REMOVE REAR DISC BRAKE  
CALIPER ASSEMBLY RH

**Hint:**

Use the procedures described for the LH side.

REMOVE PARKING BRAKE SHOE  
ADJUSTING HOLE PLUG

REMOVE REAR DISC ([info](#))

REMOVE NO. 2 PARKING BRAKE  
SHOE RETURN TENSION SPRING  
([info](#))

REMOVE NO. 1 PARKING BRAKE SHOE RETURN TENSION SPRING ([info](#))

REMOVE PARKING BRAKE SHOE ADJUSTING SCREW SET LH ([info](#))

REMOVE PARKING BRAKE SHOE ADJUSTING SCREW SET RH ([info](#))

REMOVE NO. 2 PARKING BRAKE SHOE ASSEMBLY LH ([info](#))

REMOVE NO. 2 PARKING BRAKE SHOE ASSEMBLY RH ([info](#))

REMOVE NO. 1 PARKING BRAKE SHOE ASSEMBLY LH ([info](#))

REMOVE NO. 1 PARKING BRAKE SHOE ASSEMBLY RH ([info](#))

REMOVE PARKING BRAKE SHOE LEVER LH ([info](#))

REMOVE PARKING BRAKE SHOE LEVER RH

**Hint:**

Use the same procedures described for the LH side.

DISCONNECT PARKING BRAKE CABLE LH ([info](#))

DISCONNECT PARKING BRAKE CABLE RH ([info](#))

REMOVE SKID CONTROL SENSOR WIRE ([info](#))

## REMOVE REAR HEIGHT CONTROL SENSOR SUB-ASSEMBLY LH ([info](#))

## REMOVE REAR HEIGHT CONTROL SENSOR SUB-ASSEMBLY RH

**Hint:**

Use the procedures described for the LH side.

## REMOVE LOAD SENSING VALVE SENSOR BRACKET ([info](#))

## DISCONNECT REAR STABILIZER LINK ASSEMBLY LH

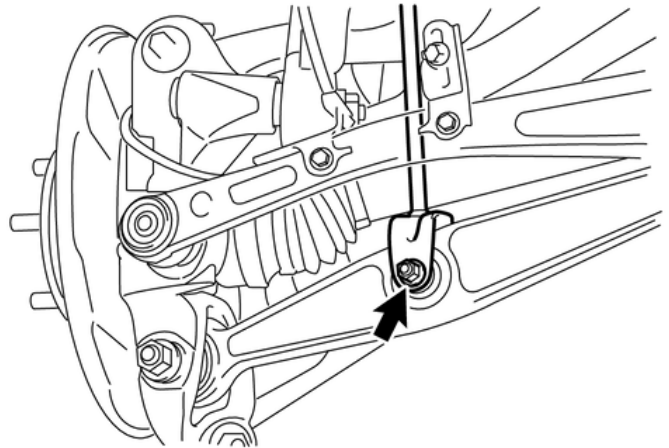

T

Remove the bolt, nut and **stabilizer** link from the rear No. 2 suspension arm.

## DISCONNECT REAR STABILIZER LINK ASSEMBLY RH

**Hint:**

Use the same procedures described for the LH side.

## DISCONNECT PNEUMATIC CYLINDER WITH REAR SHOCK ABSORBER ASSEMBLY LH ([info](#))

## DISCONNECT PNEUMATIC CYLINDER WITH REAR SHOCK

## ABSORBER ASSEMBLY RH

**Hint:**

Use the same procedures described for the LH side.

## REMOVE REAR NO. 2 SUSPENSION ARM ASSEMBLY LH ([info](#))

## REMOVE REAR NO. 2 SUSPENSION ARM ASSEMBLY RH

**Hint:**

Use the same procedures described for the LH side.

## DISCONNECT REAR NO. 1 SUSPENSION ARM ASSEMBLY LH ([info](#))

## DISCONNECT REAR NO. 1 SUSPENSION ARM ASSEMBLY RH

**Hint:**

Use the same procedures described for the LH side.

## DISCONNECT TOE CONTROL LINK SUB-ASSEMBLY LH ([info](#))

## DISCONNECT TOE CONTROL LINK SUB-ASSEMBLY RH

**Hint:**

Use the same procedures described for the LH side.



DISCONNECT REAR UPPER NO. 1  
CONTROL ARM ASSEMBLY LH  
([info](#))

DISCONNECT REAR UPPER NO. 1  
CONTROL ARM ASSEMBLY RH

**Hint:**

Use the same procedures described for the LH side.

DISCONNECT REAR UPPER NO. 2  
CONTROL ARM ASSEMBLY LH  
([info](#))

DISCONNECT REAR UPPER NO. 2  
CONTROL ARM ASSEMBLY RH

**Hint:**

Use the same procedures described for the LH side.

REMOVE REAR AXLE SHAFT NUT  
LH ([info](#))

REMOVE REAR AXLE SHAFT NUT  
RH

**Hint:**

Use the same procedures described for the LH side.

REMOVE REAR AXLE ASSEMBLY  
LH ([info](#))

REMOVE REAR AXLE ASSEMBLY  
RH

**Hint:**

Use the same procedures described for the LH side.

## REMOVE REAR SUSPENSION MEMBER BRACE LH ([info](#))

## REMOVE REAR SUSPENSION MEMBER BRACE RH

### Hint:

Use the same procedures described for the LH side.

## REMOVE REAR DIFFERENTIAL CARRIER ASSEMBLY WITH DRIVE SHAFT ([info](#))

## REMOVE REAR SUSPENSION MEMBER SUB-ASSEMBLY

Support the rear suspension member with an engine lift and attachments.

### Warning:

- As the rear suspension member is very heavy, securely support it with the engine lift and attachments.
- Perform this procedure with several people supporting the rear differential carrier assembly (with drive shaft) so that it does not tilt or fall.

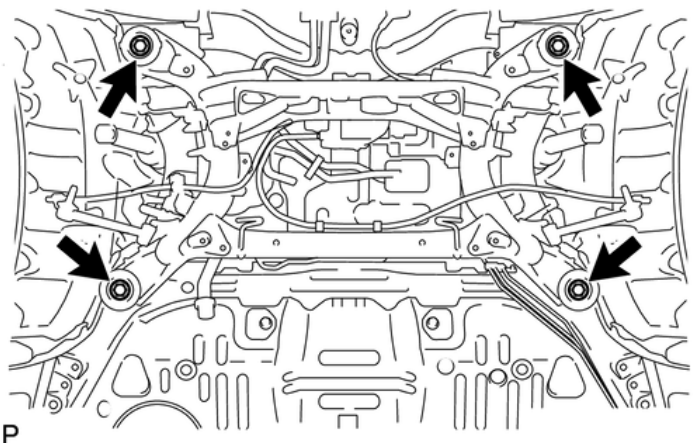

Remove the 4 bolts. Then remove the 2 lower rear suspension member stoppers, and the 2 lower differential support member stoppers.

Lower the engine lift slowly, and remove the rear suspension member.

## REMOVE REAR STABILIZER LINK ASSEMBLY LH

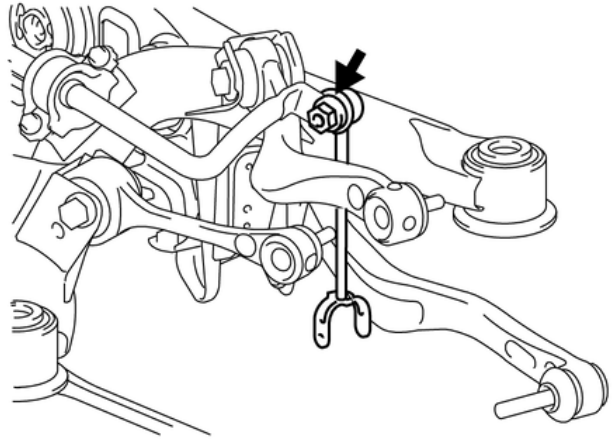

Remove the nut and disconnect the **stabilizer** link from the **stabilizer** bar.

### Hint:

If the ball joint turns together with the nut, use a 6 mm hexagon wrench to hold the stud.

## REMOVE REAR STABILIZER LINK ASSEMBLY RH

### Hint:

Use the same procedures described for the LH side.

## REMOVE ELECTRIC PARKING BRAKE ACTUATOR ([info](#))

## REMOVE REAR STABILIZER BAR (w/o Active Stabilizer) ([info](#))

## REMOVE REAR ACTIVE STABILIZER CONTROL

## ACTUATOR ASSEMBLY (w/ Active stabilizer) ([info](#))

## REMOVE REAR SUSPENSION MEMBER DAMPER ([info](#))

## REMOVE REAR NO. 1 SUSPENSION ARM ASSEMBLY LH

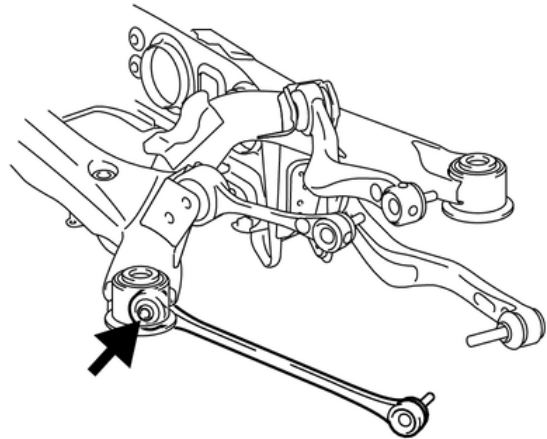

0

Remove the bolt, nut and No. 1 suspension arm from the suspension member.

## REMOVE REAR NO. 1 SUSPENSION ARM ASSEMBLY RH

### Hint:

Use the same procedures described for the LH side.

## REMOVE TOE CONTROL LINK SUB-ASSEMBLY LH

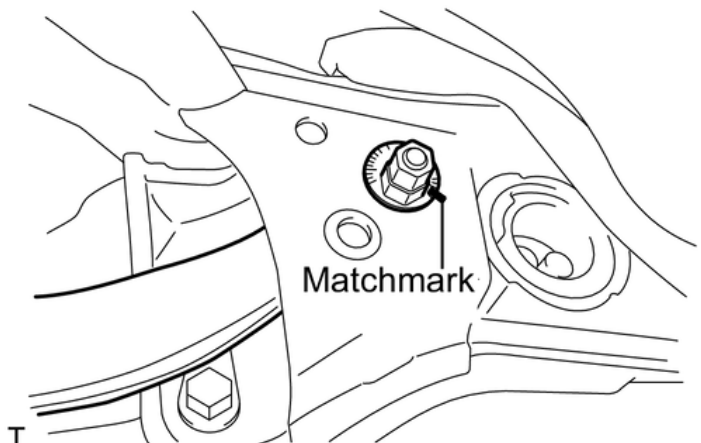

Place matchmarks on the No. 2 suspension toe adjust plate and suspension member.

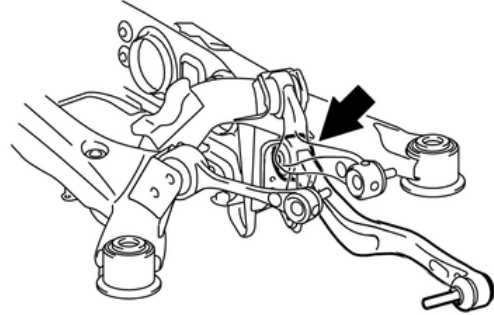

0

Remove the nut, No. 2 toe adjust plate, toe adjust cam and toe control link from the suspension member.

## REMOVE TOE CONTROL LINK SUB-ASSEMBLY RH

**Hint:**

Use the same procedures described for the LH side.

## REMOVE REAR UPPER NO. 1 CONTROL ARM ASSEMBLY LH

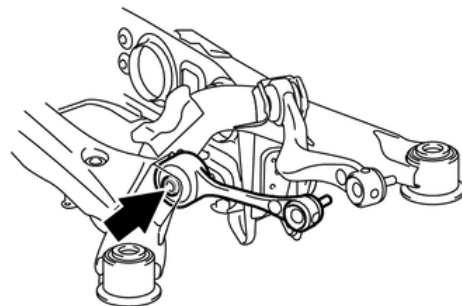

0

Remove the nut, washer, bolt and control arm from the rear suspension member.

## REMOVE REAR UPPER NO. 1 CONTROL ARM ASSEMBLY RH

**Hint:**

Use the same procedures described for the LH side.

## REMOVE REAR UPPER NO. 2 CONTROL ARM ASSEMBLY LH

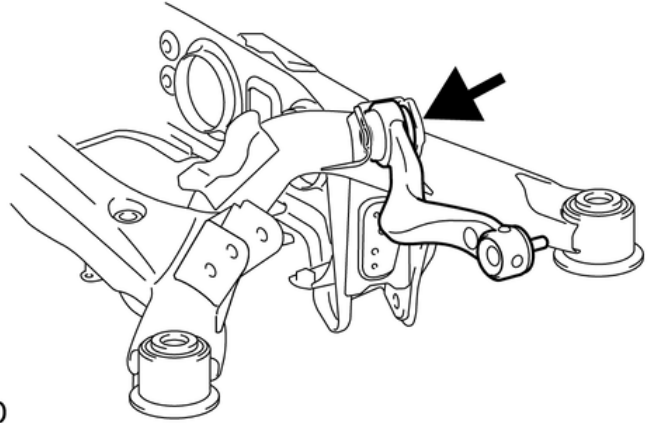

Remove the nut, washer, bolt and rear control arm from the rear suspension member.

## REMOVE REAR UPPER NO. 2 CONTROL ARM ASSEMBLY RH

**Hint:**

Use the same procedures described for the LH side.

## REMOVE REAR NO. 1 DIFFERENTIAL MOUNT CUSHION ([info](#))

## REMOVE REAR NO. 2 DIFFERENTIAL MOUNT CUSHION ([info](#))

## REMOVE REAR SUSPENSION MEMBER BODY MOUNTING CUSHION LH (for Front Side)

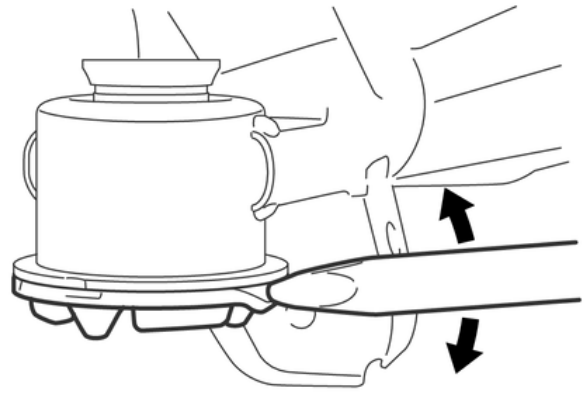

0

Using a chisel, widen the area between the rear suspension member and the body mounting cushion enough for the claws of SST.

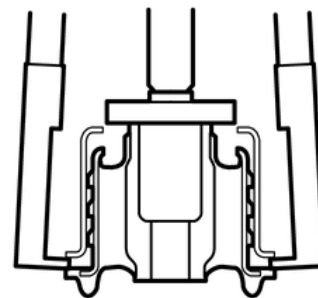
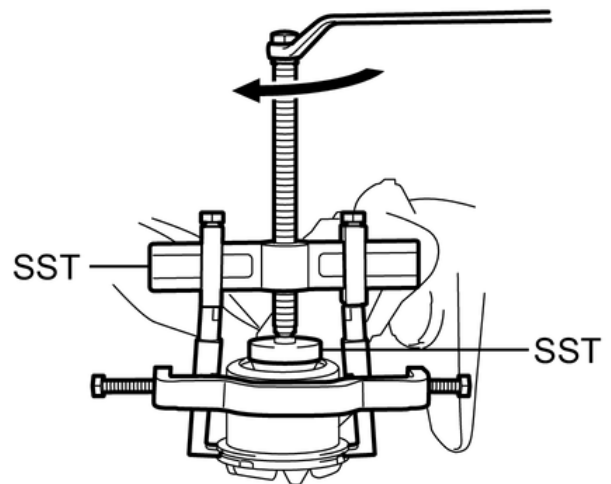

0

Using SST, remove the rear suspension member body mounting cushion.

- **SST:** 09950-40011 (09951-04020) (09952-04010) (09953-04030) (09954-04020) (09957-04010) (09958-04011)
- **SST:** 09950-60010 (09951-00540)

**Notice:**

- Be careful as the rear suspension member body mounting cushion may

come out with force.

- Do not reuse the removed rear suspension body mounting cushion.

If the outer cylinder of the rear suspension member body mounting cushion remains, insert SST into the gaps between the rear suspension member and the body mounting cushion and remove it.

Cut off the mounting cushion until SST can be set.

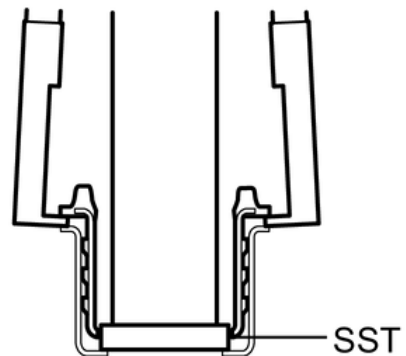
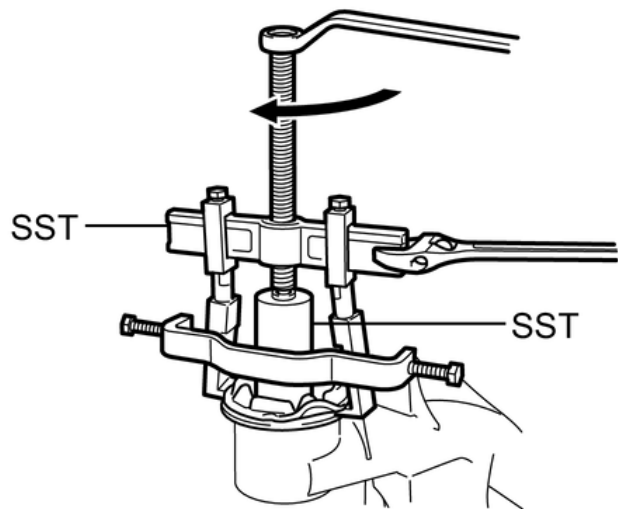

0

Using SST, remove the outer cylinder of the body mounting cushion.

- **SST:** 09608-06041
- **SST:** 09950-40011 (09951-04020) (09952-04010) (09953-04030) (09954-04020) (09957-04010) (09958-04011)
- **SST:** 09950-60010 (09951-00540)
- **SST:** 09950-60020 (09951-00680)

## REMOVE REAR SUSPENSION MEMBER BODY MOUNTING CUSHION RH (for Front Side)

**Hint:**



Use the same procedures described for the LH side.

## REMOVE REAR SUSPENSION MEMBER BODY MOUNTING CUSHION (for Rear Side)

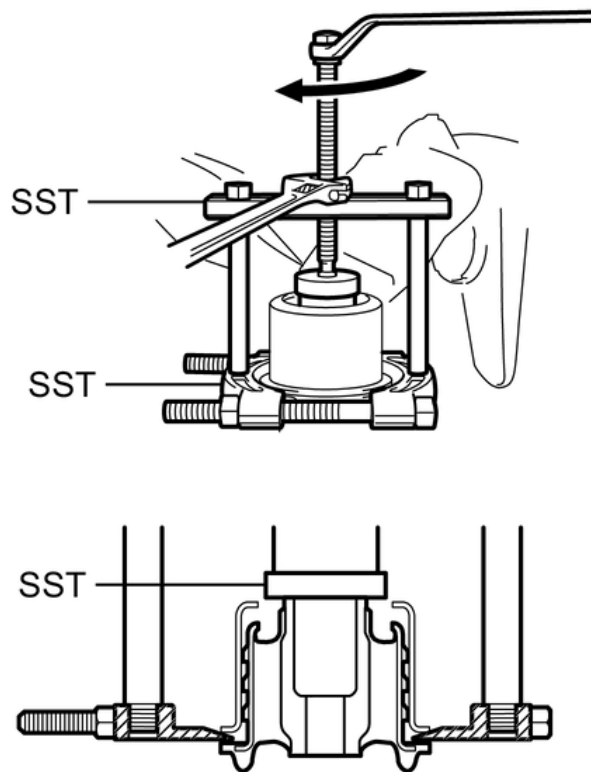

0

Using SST, remove the rear suspension member body mounting cushion.

- **SST:** 09950-00020
- **SST:** 09950-00030
- **SST:** 09950-40011 (09957-04010)
- **SST:** 09950-60010 (09951-00540)

### Notice:

- Be careful as the rear suspension member body mounting cushion may come out with force.
- Do not reuse the removed rear suspension body mounting cushion.

If the outer cylinder of the rear suspension member body mounting cushion remains, insert SST into the

gaps between the rear suspension member and the body mounting cushion and remove it.

Cut off the mounting cushion until SST can be set.

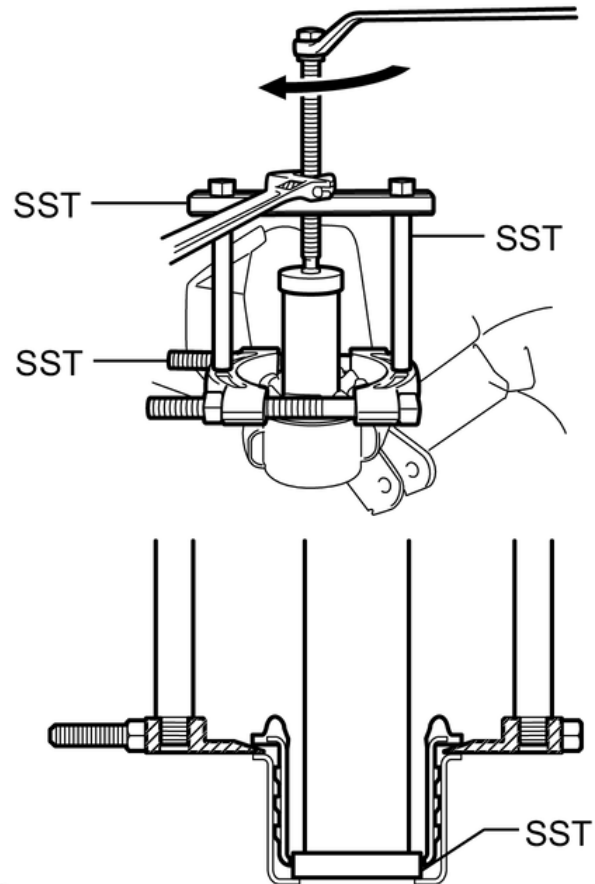

0

Using SST, remove the outer cylinder of the body mounting cushion.

- **SST:** 09608-06041
- **SST:** 09950-00020
- **SST:** 09950-00030
- **SST:** 09950-60020

2008 Lexus LS600h L, 5.0L 32-valve 8-cyli ▾

Search query

Search

[Affiliates](#) | [Contact Us](#) | [Windows Version](#) | [Cancellations & Returns](#) | [Privacy Policy](#) | [Legal Terms](#)