

Adding RX Tow Converter for trailer lights on FWD RX 350

1. Purchase P/N PT219-48101-TC.
2. The converter is installed in the Rear Right (passenger) quadrant of the RX, near the tire. The cable and connector is taped in place and has sufficient lengths to easily reach and be connected to the converter.
3. To install the converter empty the trunk area and remove the mats, cover and storage bins. To remove the cover you must take out the two bolts (near the hinge) which holds the cover in place. The bolts are hidden by the carpeting.

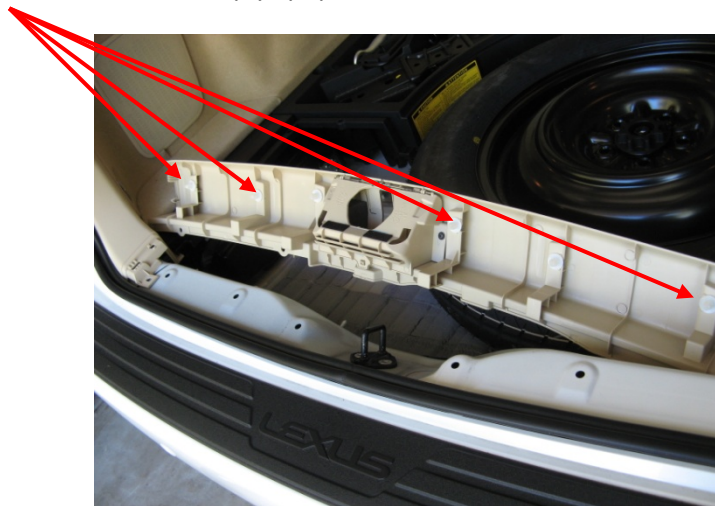

4. Then remove the covering strip at the entrance of the truck area. Note, the strip is held in place with plastic fasteners and simply “pops” off.



5. With the strip removed, access to the plastic molding is now possible and it too can be removed by carefully prying it back. Note it is also held in place by two plastic fasteners and a “hook” on the bottom that connects the molding to the carpeted wall board. With the plastic molding

removed, the two plastic fasteners can be removed with a pry bar (or two flat head screwdrivers)

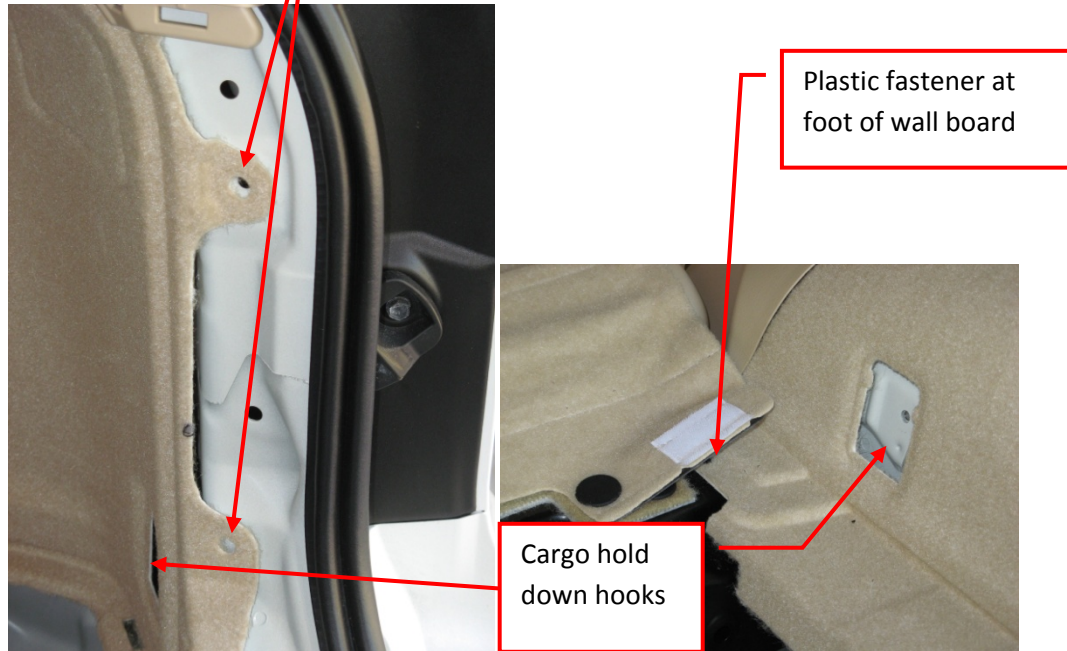

6. At this point the goal is to get behind the carpeted wall board. To do so remove the two cargo hooks (there is a bolt behind the plastic hinge which can easily be pried open with a very small screwdriver) and the frame around the seat release. The plastic fasteners at the foot of the wall board must also be removed.



7. There are two screws that hold down the wall board. One is located behind the "privacy cover" hold down and the other is at the privacy cover base where it sits in place. Now the wall board can be gently pulled back. Do not attempt to remove it from the plastic molding. Simply pull back gently as the fasteners disengage one-by-one until you gain access to the area where the converter can be installed. Be careful to disconnect the wire attached to the compartment light while peeling back the wall board.

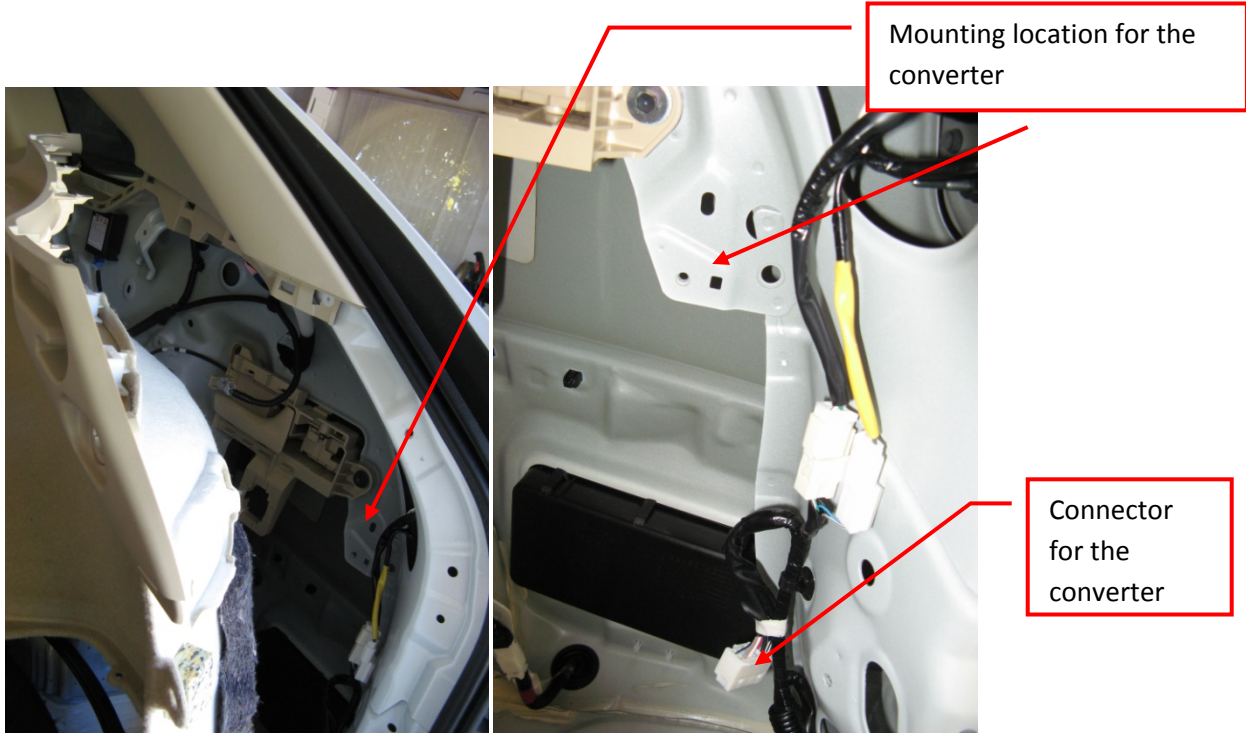

8. Install the converter with the bolt hole over the fastener and the 90 degree bent flange in the hole. Note the converter does not come with a bolt so ask the parts person for a bolt to properly fasten the converter in place. Connect the cable to the connector.

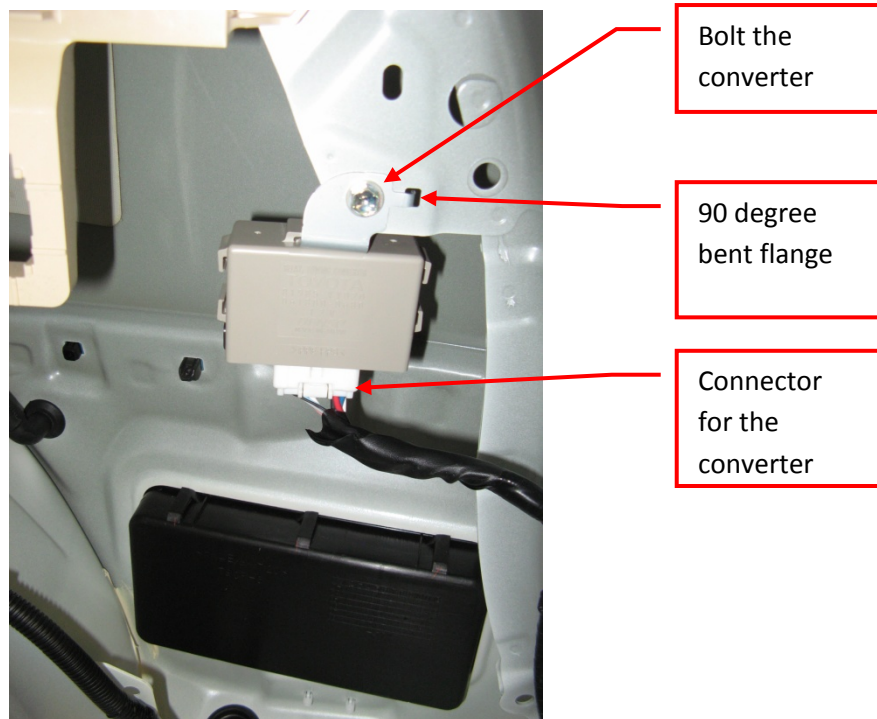

Test the converter at the outlet using a DC voltmeter and when confirmed it is working properly, reinstall everything in the same order removed. Good Luck!