

■ AUDIO SYSTEM

1. General

The following outlines have been added or changed in the Audio system on the '10 SC 430.

Item/System	Added	Changed
Audio Head Unit (Radio Receiver Assembly)	-	○
USB Port (No. 1 Stereo Jack Adapter Assembly)	○	-
Bluetooth Audio System	○	-
XM Satellite Radio*	○	-
MOST Communication	○	-

\*: Optional Equipment

2. System Diagram

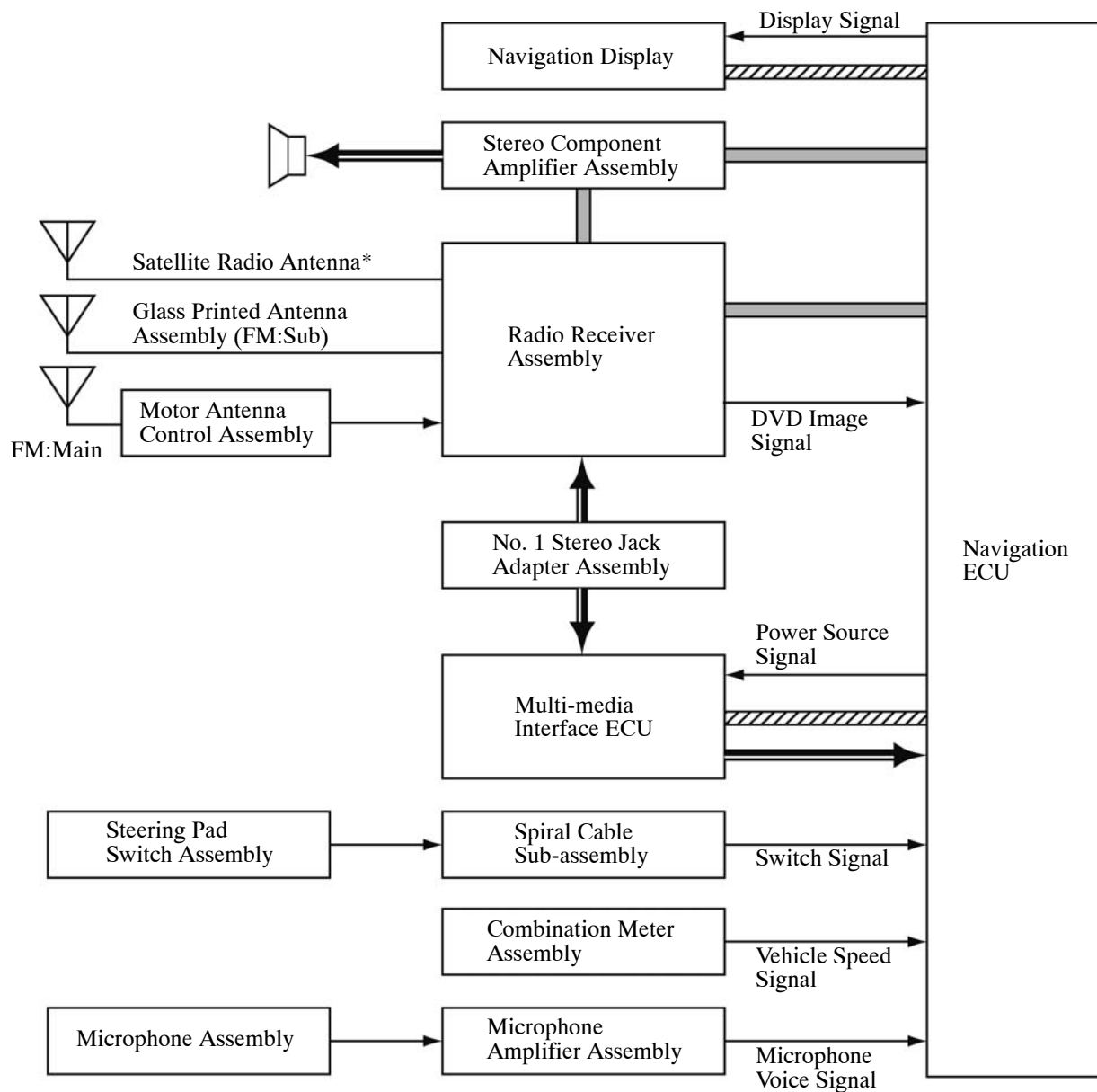

— : MOST

▨ : AVC-LAN

— : Sound Signal

\*: Models with Satellite Radio System

### 3. Layout of Components

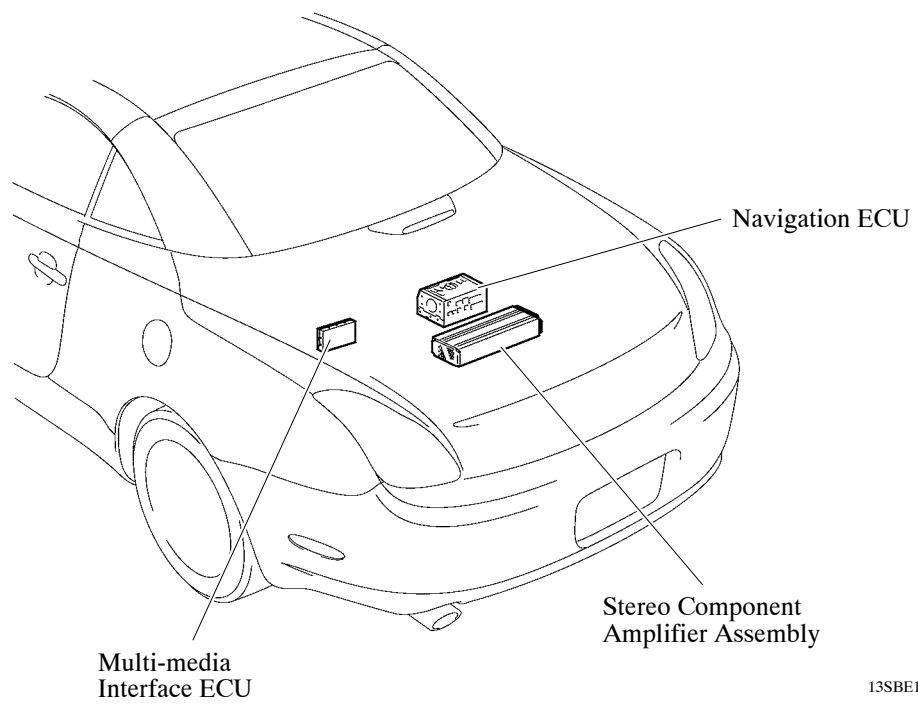
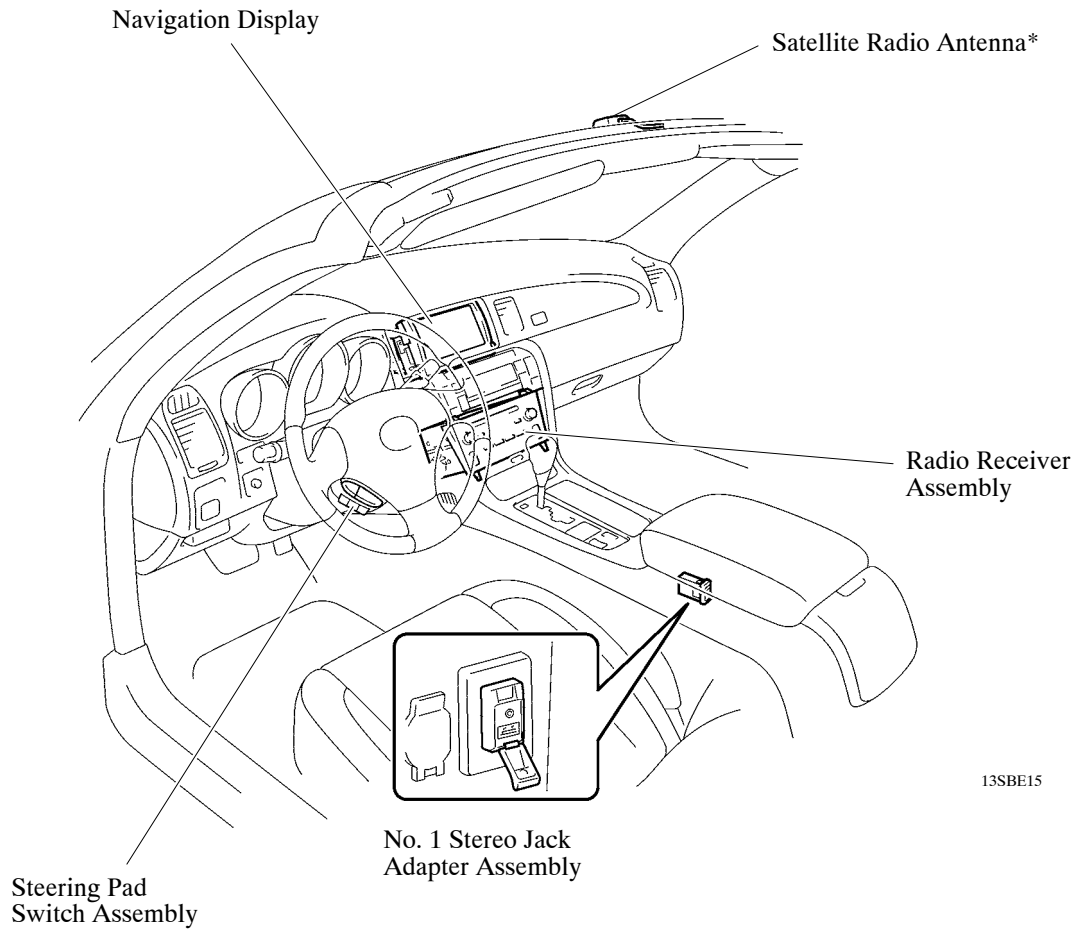

\*: Models with Satellite Radio System

### 4. Audio Head Unit

Audio head unit has been changed.

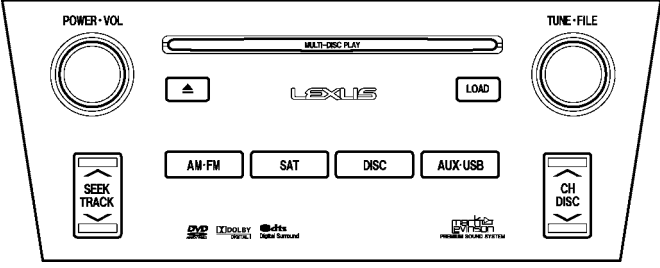
Design	Specifications
 <p>The diagram shows the front panel of the audio head unit. On the left is a circular 'POWER-VOL' knob. In the center is a 'MULTI-DISC PLAY' slider with an upward-pointing arrow button below it. On the right is another circular 'TUNE-FILE' knob. Below the slider are four buttons: 'AM-FM', 'SAT', 'DISC', and 'AUX-USB'. At the bottom left is a 'SEEK TRACK' button with up and down arrows. At the bottom right is a 'CH DISC' button with up and down arrows. The 'LEXUS' logo is in the center. At the bottom, there are logos for DVD VIDEO, DOLBY DIGITAL, and SDDS. The reference number '13SBE12' is at the bottom right of the diagram area.</p>	<ul style="list-style-type: none"> <li>• AM/FM Tuner</li> <li>• XM Satellite Radio Tuner*</li> <li>• Radio Broadcast Data System (RBDS)</li> <li>• 6-DVD Changer: Compatible with MP3 and Windows Media Audio (WMA) files</li> <li>• Bluetooth Audio</li> <li>• Bluetooth Hands-free System</li> <li>• Portable Audio Player Interface (USB type)</li> <li>• iPod Player Interface</li> <li>• Stereo Jack Adapter</li> <li>• Unit: Pioneer</li> <li>• 9-speaker (Mark Levinson)</li> </ul>

\*: Models with Satellite Radio System

## 5. USB Port

A USB port that enables operation of a portable audio player (USB type) or an iPod is provided.

### Reference

- Supported iPod models and firmware versions are listed below:

Supported iPod Model	Supported Firmware Version
iPod 5G	1.2.0 or higher
iPod nano 1G	1.2.0 or higher
iPod nano 2G	1.1.2 or higher
iPod nano 3G	1.0.0 or higher
iPod touch	1.1 or higher
iPod classic	1.0.0 or higher

- Unsupported iPod models are listed in the table below:

Unsupported Models	iPod shuffle
	iPhone
	iPod 1G, 2G, 3G, 4G
	iPod mini

- Mass storage class type portable audio players (USB type) are compatible.
- iPod is a trademark of Apple Inc. that has been registered in the U.S.A. and other countries.

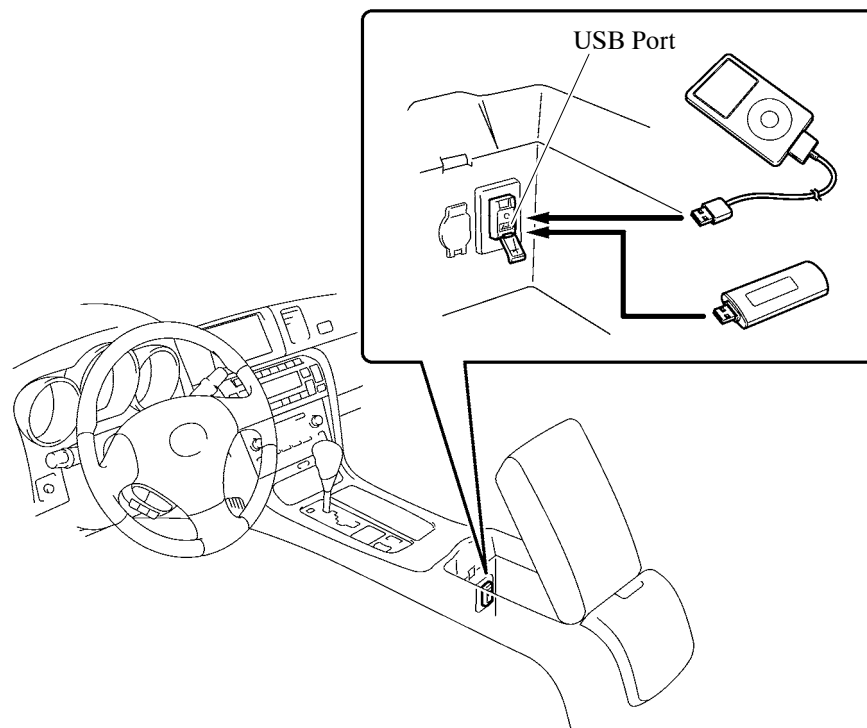

## 6. Bluetooth Audio System

The Bluetooth audio system enables users to enjoy music played on a portable player from the vehicle speakers via wireless communication.

### Reference

*Portable players must correspond to the following specifications in order to be able to be connected to the Bluetooth audio system. However, note that some functions may be limited depending on the type of portable player.*

*The following profiles must be supported:*

- *Advanced Audio Distribution Profile (A2DP) Version 1.0*
- *Audio/Video Remote Control Profile (AVRCP) Version 1.0 or higher (Version 1.3 or higher recommended)*

## 7. XM Satellite Radio

XM satellite radio is a service that uses the signals from 2 satellites in geostationary orbit to make it possible to capture digital radio broadcasts (XM satellite radio) from over 170 channels. XM satellite radio enables users to constantly receive their favorite programs.

- XM satellite radio is a subscription-type digital broadcast service.
- In addition to the 2 satellites, XM satellite radio is supported by 800 satellite earth stations (repeaters). As a result, it can receive broadcasts throughout the U.S.A. (except Hawaii and Alaska) and most parts of Canada.
- If the signals from the satellites are disrupted by a tunnel, gulch, or high-rise buildings, the simultaneous broadcast (called “gap filler”) through ground based signals helps achieve excellent reception that is free of interruptions.
- XM satellite radio produces near CD-quality sound using a digital satellite broadcast. It is particularly convenient for long-distance drivers because it is unnecessary to tune to different stations.

